



Addendum #2

Date: January 24, 2025
To: Prospective Bidders
From: Laura Huggler, Hitchcock Design Group (HDG)

RE: Bock Park Phase One

This addendum forms part of the Contract Documents and modifies the original Bidding Documents as noted below. Acknowledge receipt of this addendum in the space provided on the Bid Form. Failure to do so may subject Bidder to disqualification. This addendum is (7) total pages and includes this (2) page memo, (5) revised drawing sheets which consist of the following changes.

Clarifications:

- Plexipave is an acceptable substitution for the sport court's color coat system.
- **Question:** L5.1 shows the detail for the Sport Court Paving. The detail calls for a "Pavement reinforcement system, see specifications" but there is no spec for this:
 - **Response:** *There will not be a pavement reinforcement system included in the sport court paving for this project. The note in that detail has been removed.*
- **Question:** The elevations in the detail for the BMP do not match the civil plan for elevations. Civil shows bottom of pond at 593.30 but the BMP detail shows finish grade at 596.25 top of mulch. Detail shows bottom of aggregate at 593.30. Please advise:
 - **Response:** *The BMP detail on sheet C4.2 reflects the correct subsurface and finished grade elevations. The proposed contours in sheets C1.1, C2.1, and C3.1 have been revised to only show the finished grade contours, consistent with the BMP detail. The following changes have been made in the plans:*
 - *Sheets C1.1, C2.1, and C3.1: proposed contours in the east BMP cell have been revised to only include the finished grade contours.*
 - *Sheet C1.1 and C2.1: proposed and existing intermediate/index contour lines added to legend.*
 - *Sheet C4.2: arrow added to the detail to clarify the top of filter media elevation.*
- **Question:** The rim elevations of the catch basin and manhole at the south edge of the parking lot (18 & 19) are 599.86, while the southeast and southwest corners have an EP grade of 599.66. Confirm how water will flow from these corners to the south structures. It appears there is a low spot at the corners.
 - **Response:** *On sheet C2.1, the rim elevations of drainage structures 18 and 19 have been lowered such that the south ends of the parking lot can drain to them. A note has also been added to indicate that the south gutters are to be graded towards these drainage structures.*



Drawings:

- Replace Sheet L5.1 Details:
 - “Pavement reinforcement system, see specifications” removed from Detail #1 – Sport Court Paving

- Replace Sheet C1.1 – Erosion/Sediment Control and Restoration Plan:
 - Providing updated contour information on plan and legend

- Replace Sheet C2.1 – Drainage Plan:
 - Providing updated contour information on plan and legend

- Replace Sheet C3.1 – Grading Plan:
 - Providing updated southern gutter drainage information

- Replace Sheet C4.2 – Details:
 - Bioretention detail has been updated

Specifications:

No changes

End of Addendum #2

Cc: Sharon Desjardins, Lan-Oak Park District (LOPD);
Michelle Havran, LOPD;
Tammy McMahon, LOPD;
Doug Fair, HDG;
File – HDG

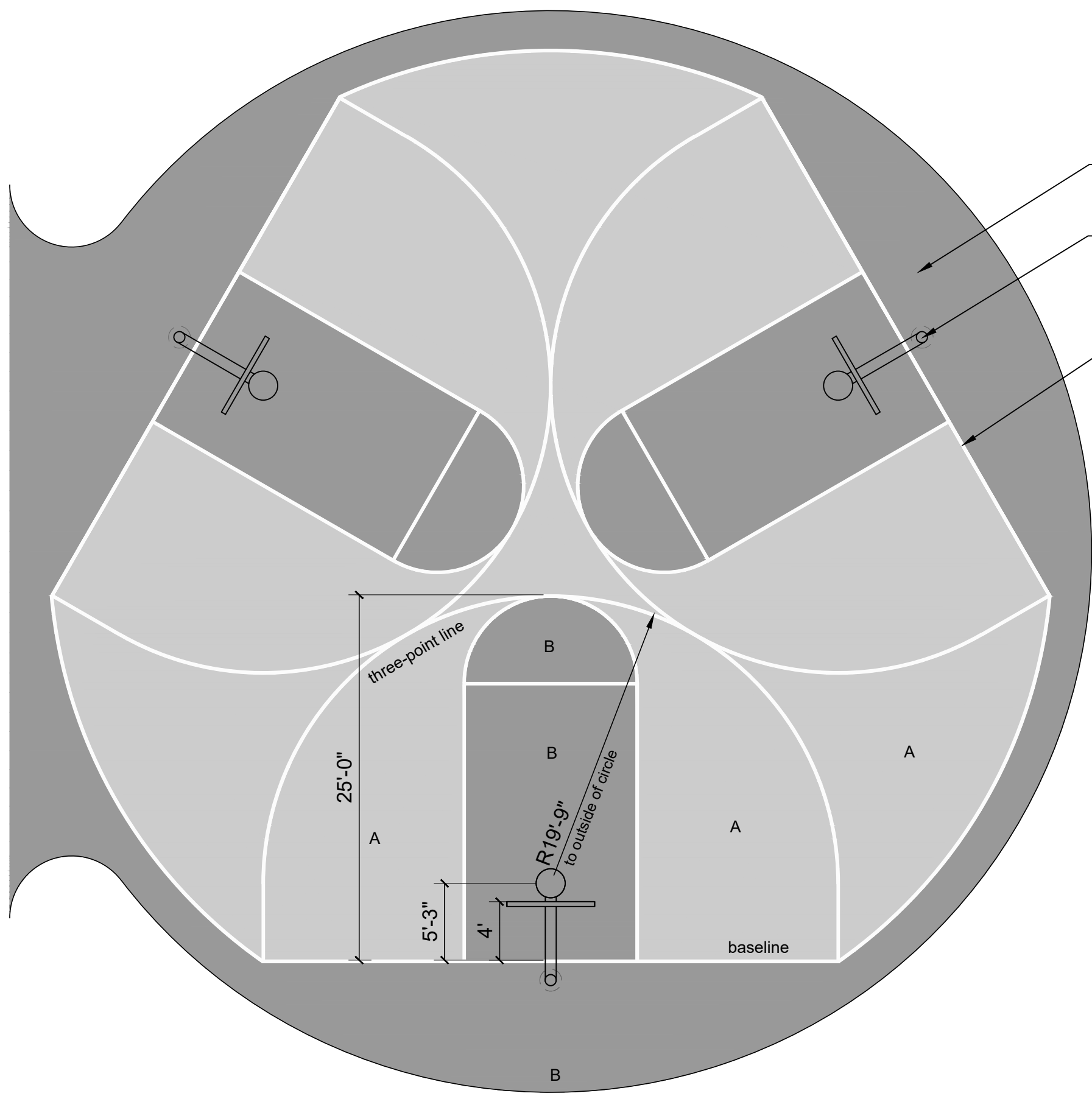

- 1 SPORT COURT PAVING (L5.1)
- 2 BASKETBALL FIXTURE (TYP.) (L5.1)

2" wide lines. Color: White, typical Lines shall meet standards set by the national federation of state high school associations

COLOR COAT KEY
 A: Color to be selected by Owner during construction
 B: Color to be selected by Owner during construction

Notes:
 1. All dimensions are from inside edge of lines unless otherwise noted.
 2. Striping dimensions typical, all courts

4 TRI BASKETBALL LAYOUT
 1/8" = 1'-0"

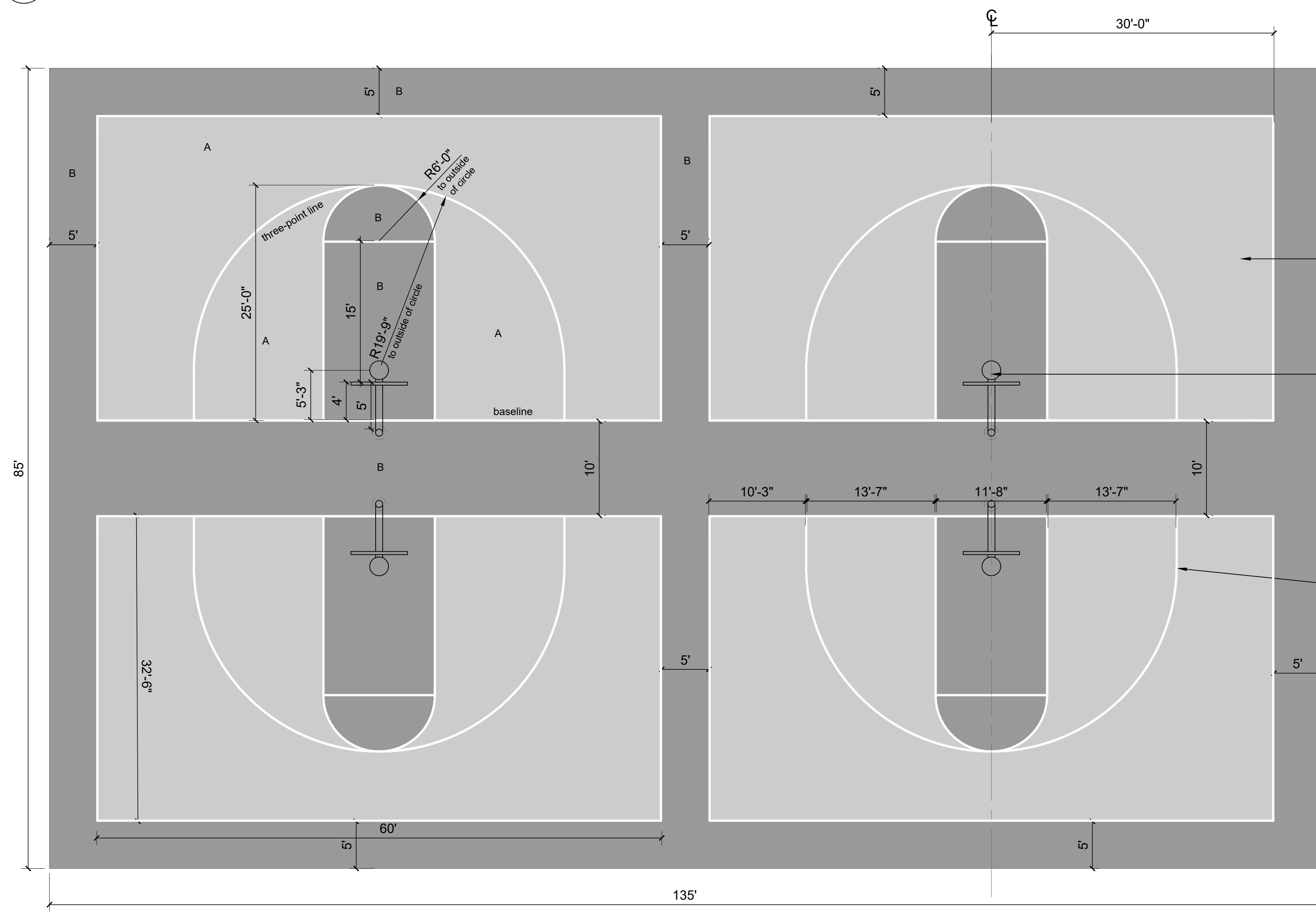

- 1 SPORT COURT PAVING (L5.1)

- 2 BASKETBALL FIXTURE, TYP. (L5.1)

2" wide lines. Color: White, typical Lines shall meet standards set by the national federation of state high school associations

COLOR COAT KEY
 A: Color to be selected by Owner during construction.
 B: Color to be selected by Owner during construction.

Notes:
 1. All dimensions are from inside edge of lines unless otherwise noted.
 2. Striping dimensions typical, all courts

3 QUAD BASKETBALL LAYOUT
 1/8" = 1'-0"

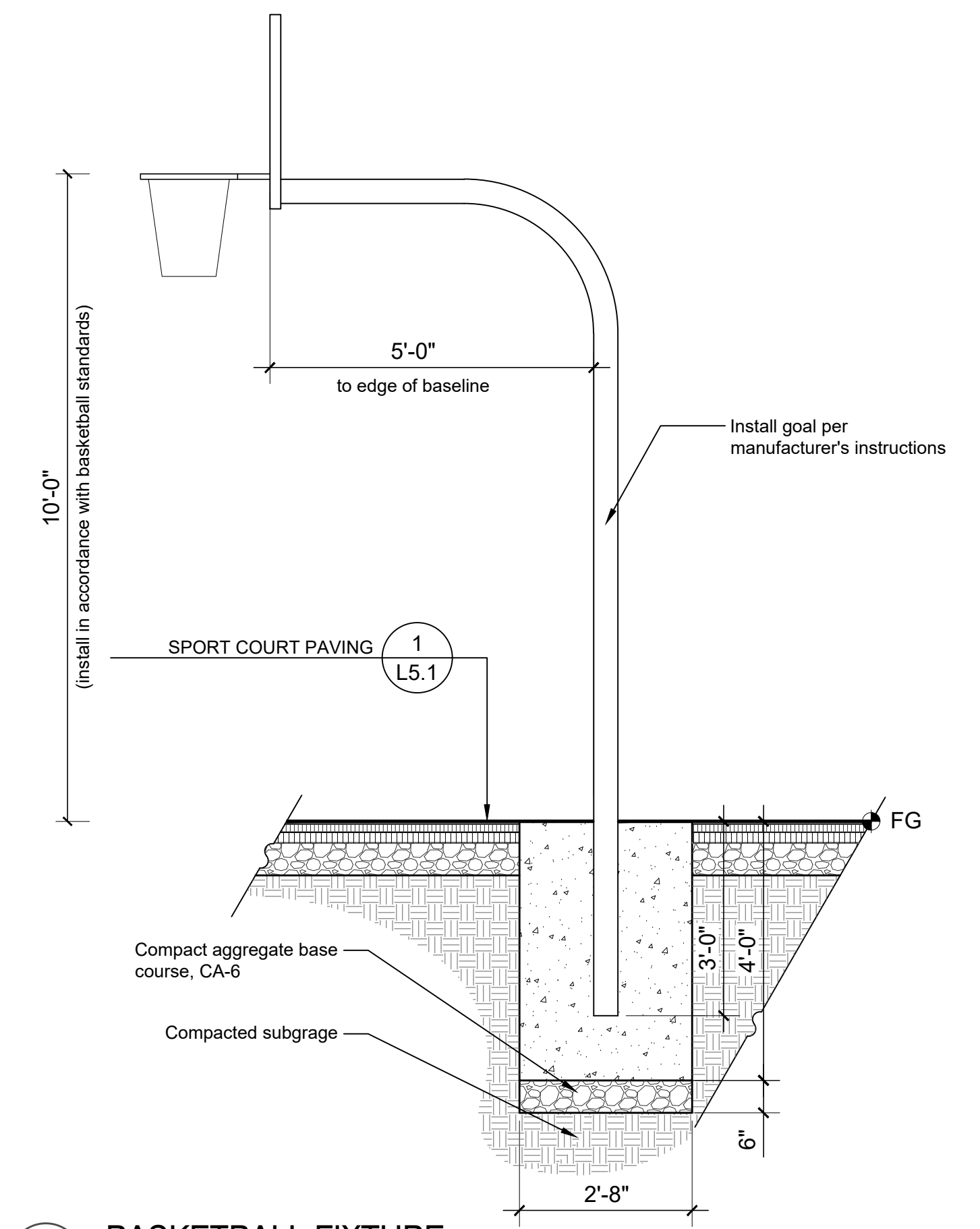

2 BASKETBALL FIXTURE
 1/2" = 1'-0"

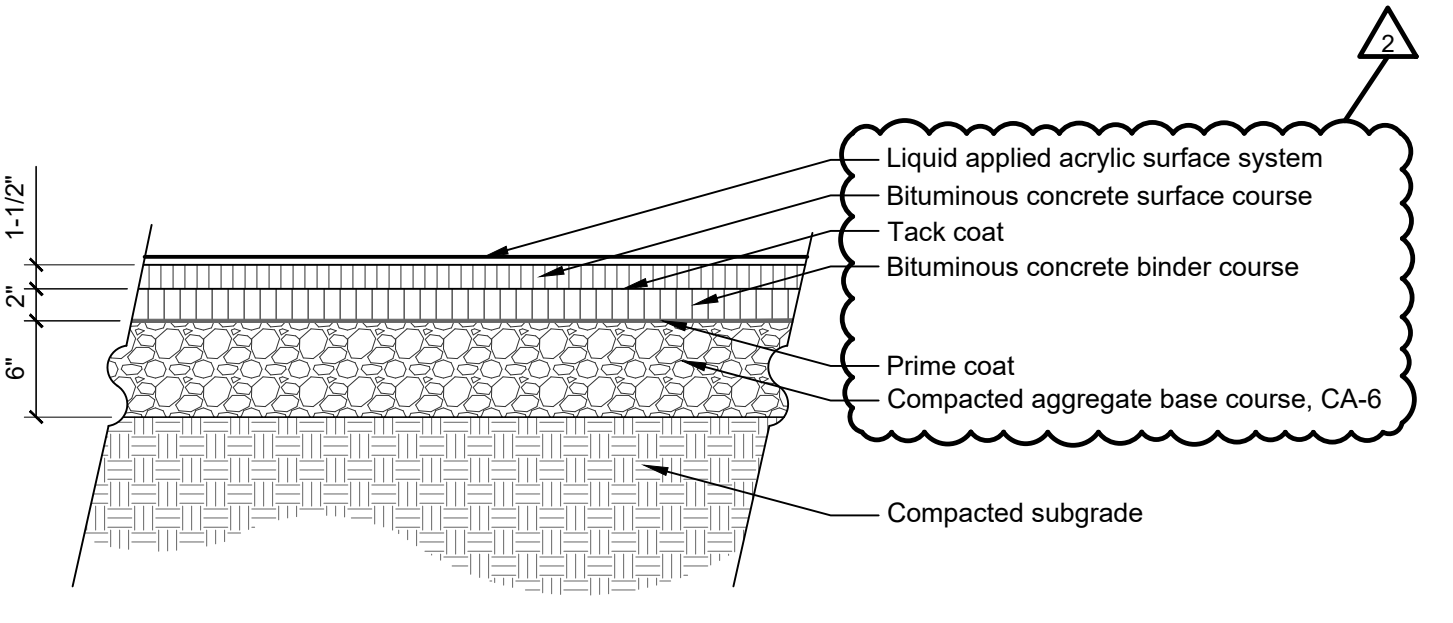

1 SPORT COURT PAVING
 1" = 1'-0"



22 E. Chicago Avenue
 Suite 200A
 Naperville, IL 60540
 T 630.961.1787
 hitchcockdesigngroup.com

PREPARED FOR
Lan-Oak Park District
 2550 178th Street
 Lansing, IL 60438

PROJECT
Bock Park Phase One
 17500 Lorenz Avenue
 Lansing, IL 60438

CONSULTANTS
Civil Engineering
 Civitech Engineering, Inc.
 30 N. LaSalle St. Suite 3220
 Chicago, IL 60602
 T 312.726.5910

ISSUE FOR BID
 JANUARY 8, 2025
 REVISIONS

No	Date	Issue
2	2025.01.24	Addendum #2

CHECKED BY: DNF
 DRAWN BY: LKH

SHEET TITLE
 Details









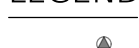

SCALE IN FEET
 as noted

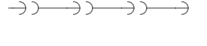
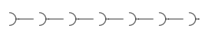



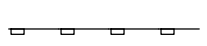
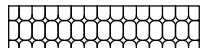

SHEET NUMBER

L5.1
 ©2025 Hitchcock Design Group

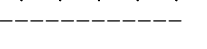
LEGEND

-  EXISTING COMBINATION MANHOLE
-  EXISTING CATCH BASIN
-  EXISTING SANITARY MANHOLE
-  EXISTING COMBINED SEWER
-  EXISTING SANITARY SEWER
-  EXISTING STORM SEWER
-  EXISTING WATER MAIN
-  EXISTING TELEPHONE
-  EXISTING FENCE
-  INLET FILTER
-  DOUBLE ROW PERIMETER EROSION BARRIER
-  CONSTRUCTION ENTRANCE
-  EROSION CONTROL BLANKET
-  CONCRETE TRUCK WASHOUT
-  BASIN OVERFLOW BERM - EL. 599.00

 1.0' EXISTING INTERMEDIATE CONTOUR
 5.0' EXISTING INDEX CONTOUR
 0.5' PROPOSED INTERMEDIATE CONTOUR
 1.0' PROPOSED INDEX CONTOUR
 SEE LANDSCAPE SHEETS FOR MORE INFORMATION

NOTE: ALL EXISTING SEWERS SHOWN ARE OWNED AND MAINTAINED BY THE VILLAGE OF LANSING, UNLESS OTHERWISE NOTED.

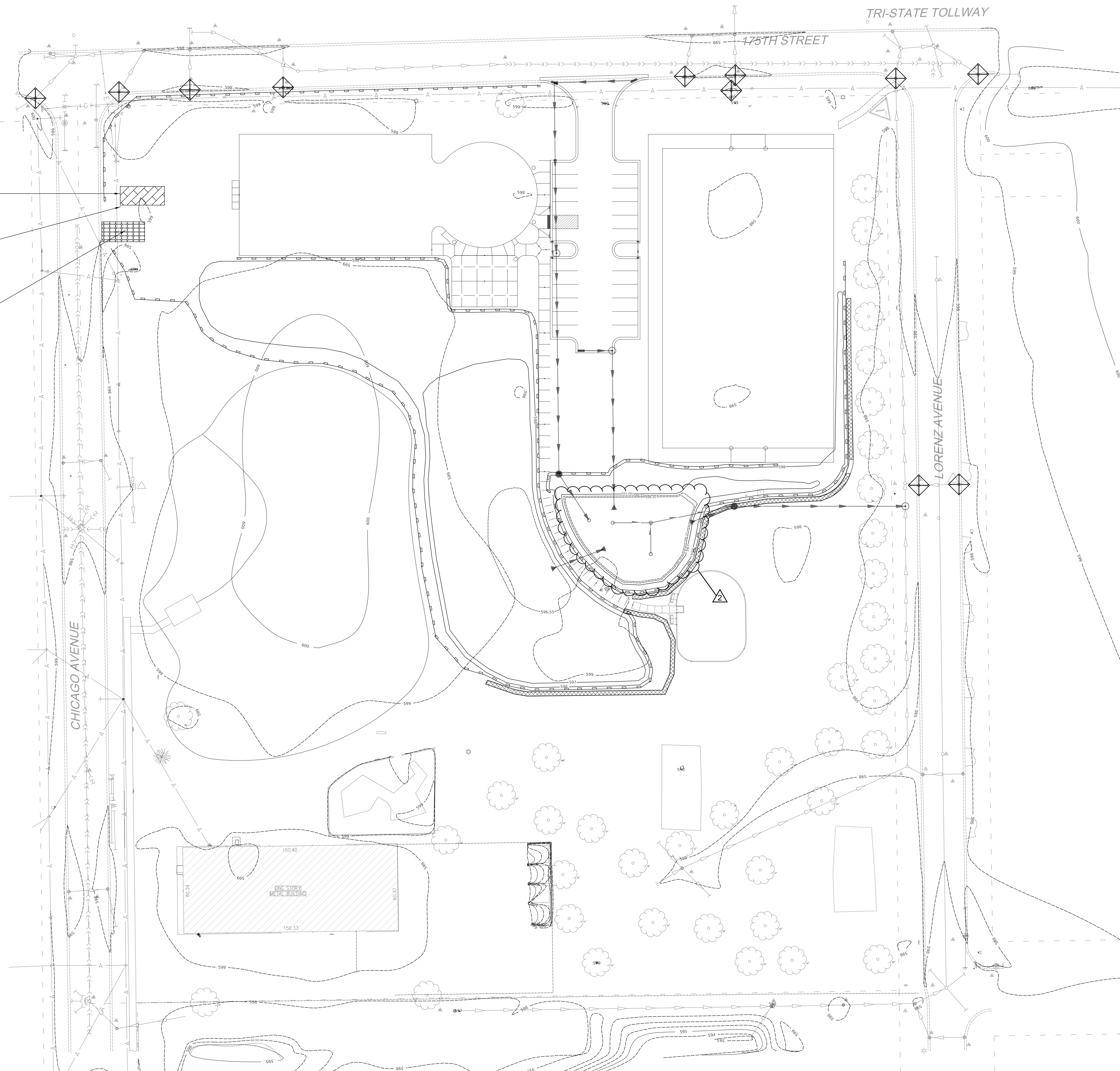

APPROXIMATE LOCATION OF CONCRETE TRUCK WASHOUT

CONTRACTOR MUST ENSURE ROADWAY DRAINAGE IS MAINTAINED DURING CONSTRUCTION

APPROXIMATE LOCATION OF STABILIZED CONSTRUCTION ENTRANCE. SEE DETAIL.

CONTRACTOR IS RESPONSIBLE FOR REPLACEMENT OF ANY CURB, GUTTER, OR ROADWAY DAMAGED BY THE CONSTRUCTION ENTRANCE.

ISSUE FOR BID
JANUARY 8, 2025

REVISIONS

No	Date	Issue
2	2025.01.24	Addendum #2

CHECKED BY: JHA DRAWN BY: JRR/JR

SHEET TITLE
**EROSION/SEDIMENT
CONTROL AND
RESTORATION PLAN**

SCALE IN FEET
1" = 40'



NORTH SHEET NUMBER

 **C1.1**

175th ALIGNMENT TABLE			
DESCRIPTION	STATION	NORTHING	EASTING
BOA	10+00.00	1789604.5987	1200060.3999
EOA	18+00.00	1789604.5987	1200860.3999

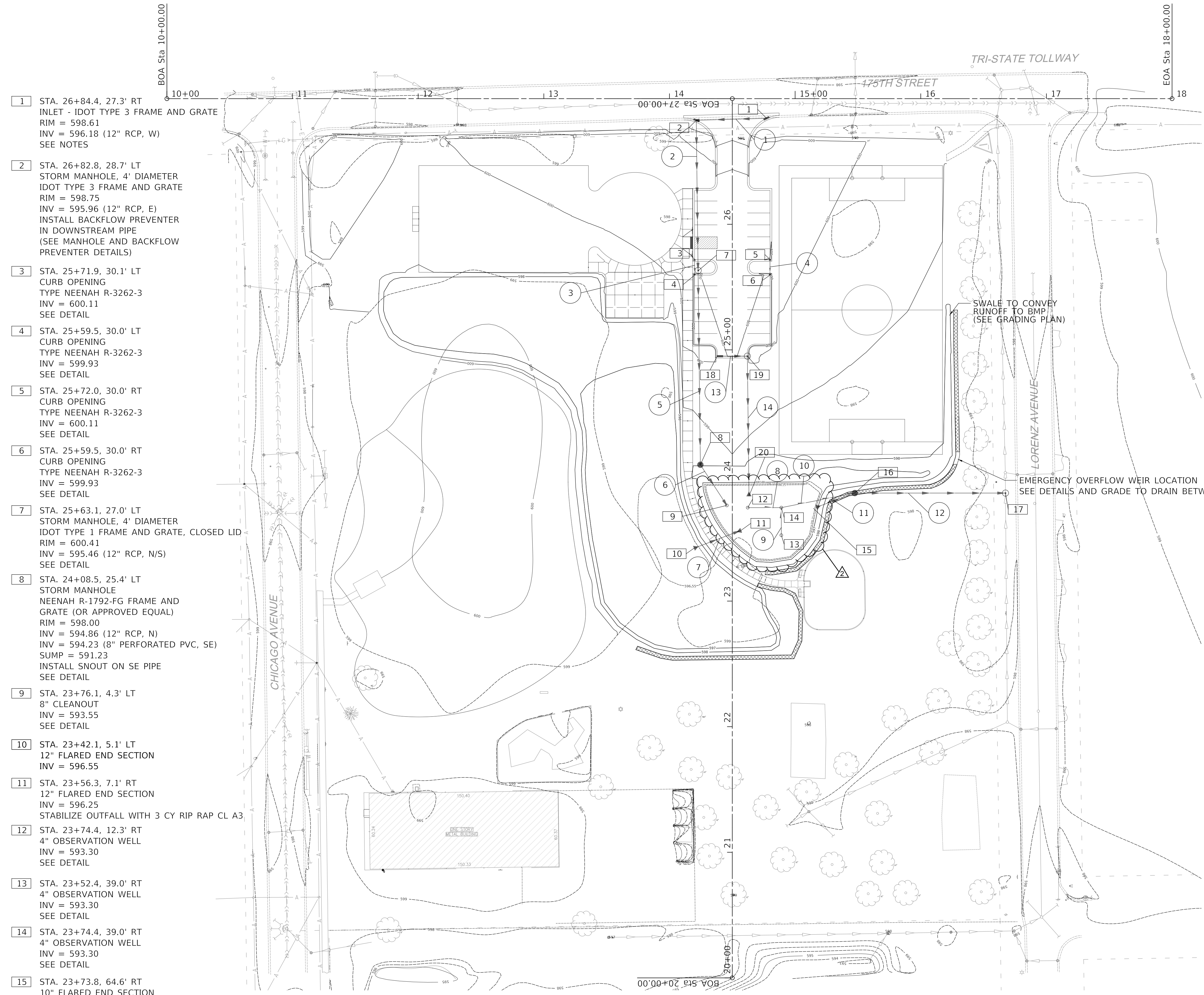

NOTES / LEGEND TITLE

- LEGEND
- ⊛ EXISTING COMBINATION MANHOLE
 - ⊙ EXISTING CATCH BASIN
 - ⊙ EXISTING SANITARY MANHOLE
 - EXISTING COMBINED SEWER
 - EXISTING SANITARY SEWER
 - EXISTING STORM SEWER
 - W— EXISTING WATER MAIN
 - T— EXISTING TELEPHONE
 - - - - EXISTING FENCE
 - PROPOSED CLEANOUT
 - PROPOSED STORM SEWER
 - ▲ PROPOSED CURB OPENING
 - PROPOSED INLET
 - ▲ PROPOSED FLARED END SECTION
 - ▨ BASIN OVERFLOW BERM - EL. 599.00
- NOTES
- 1.0' EXISTING INTERMEDIATE CONTOUR
 - 5.0' EXISTING INDEX CONTOUR
 - 0.5' PROPOSED INTERMEDIATE CONTOUR
 - 1.0' PROPOSED INDEX CONTOUR

- INLET SHALL BE IN ACCORDANCE WITH IDOT STANDARD DRAWING 602301-04 - INLET - TYPE A.
- ALL EXISTING SEWERS SHOWN ARE OWNED AND MAINTAINED BY THE VILLAGE OF LANSING UNLESS OTHERWISE NOTED.

- ① 56 LF 12" RCP @ 0.4%
- ② 124 LF 12" RCP @ 0.4%
- ③ 21 LF 4" PVC SDR-26 @ 0.38 %
- ④ 21 LF 4" PVC SDR-26 @ 0.38%
- ⑤ 150 LF 12" RCP @ 0.4%
- ⑥ 34 LF 8" PVC SDR-26 @ 2.0%
LAST 10 FEET OF PIPE TO BE PERFORATED AND WITHIN THE BIORETENTION AGGREGATE SECTION. PERFORATIONS MUST AMOUNT TO AT LEAST 5 SQUARE INCHES PER LINEAR FOOT OF PIPE. SEE DETAIL
- ⑦ 35 LF 12" PVC SDR-26 @ 0.57%
LENGTH INCLUDES FLARED END SECTIONS
- ⑧ 4" PVC SDR-26, PERFORATED DRAIN TILE @ 0.00%
ALL INVERTS 593.30
- ⑨ 4" PVC SDR-26, PERFORATED DRAIN TILE @ 0.00%
ALL INVERTS 593.30
- ⑩ 4" PVC SDR-26, PERFORATED DRAIN TILE @ 0.00%
ALL INVERTS 593.30
- ⑪ 33 LF 10" PVC SDR-26 @ 1.5%
- ⑫ 116 LF 10" PVC SDR-26 @ 0.30%
- ⑬ 23 LF 12" RCP @ 0.40%
- ⑭ 109 LF 12" PVC SDR-26 @ 0.40%

- ① STA. 26+84.4, 27.3' RT INLET - IDOT TYPE 3 FRAME AND GRATE
RIM = 598.61
INV = 596.18 (12" RCP, W)
SEE NOTES
- ② STA. 26+82.8, 28.7' LT STORM MANHOLE, 4' DIAMETER
IDOT TYPE 3 FRAME AND GRATE
RIM = 598.75
INV = 595.96 (12" RCP, E)
INSTALL BACKFLOW PREVENTER IN DOWNSTREAM PIPE (SEE MANHOLE AND BACKFLOW PREVENTER DETAILS)
- ③ STA. 25+71.9, 30.1' LT CURB OPENING
TYPE NEENAH R-3262-3
INV = 600.11
SEE DETAIL
- ④ STA. 25+59.5, 30.0' LT CURB OPENING
TYPE NEENAH R-3262-3
INV = 599.93
SEE DETAIL
- ⑤ STA. 25+72.0, 30.0' RT CURB OPENING
TYPE NEENAH R-3262-3
INV = 600.11
SEE DETAIL
- ⑥ STA. 25+59.5, 30.0' RT CURB OPENING
TYPE NEENAH R-3262-3
INV = 599.93
SEE DETAIL
- ⑦ STA. 25+63.1, 27.0' LT STORM MANHOLE, 4' DIAMETER
IDOT TYPE 1 FRAME AND GRATE, CLOSED LID
RIM = 600.41
INV = 595.46 (12" RCP, N/S)
SEE DETAIL
- ⑧ STA. 24+08.5, 25.4' LT STORM MANHOLE
NEENAH R-1792-FG FRAME AND GRATE (OR APPROVED EQUAL)
RIM = 598.00
INV = 594.86 (12" RCP, N)
INV = 594.23 (8" PERFORATED PVC, SE)
SUMP = 591.23
INSTALL SNOUT ON SE PIPE
SEE DETAIL
- ⑨ STA. 23+76.1, 4.3' LT 8" CLEANOUT
INV = 593.55
SEE DETAIL
- ⑩ STA. 23+42.1, 5.1' LT 12" FLARED END SECTION
INV = 596.55
- ⑪ STA. 23+56.3, 7.1' RT 12" FLARED END SECTION
STABILIZE OUTFALL WITH 3 CY RIP RAP CL A3
- ⑫ STA. 23+74.4, 12.3' RT 4" OBSERVATION WELL
INV = 593.30
SEE DETAIL
- ⑬ STA. 23+52.4, 39.0' RT 4" OBSERVATION WELL
INV = 593.30
SEE DETAIL
- ⑭ STA. 23+74.4, 39.0' RT 4" OBSERVATION WELL
INV = 593.30
SEE DETAIL
- ⑮ STA. 23+73.8, 64.6' RT 10" FLARED END SECTION
INV = 596.55
- ⑯ STA. 23+86.0, 97.5' RT OUTLET CONTROL STRUCTURE
RIM = 599.00
INV = 596.49 (10" PVC, W)
INV = 593.90 (4" PVC)
INV = 593.90 (10" PVC, E)
SEE DETAIL
- ⑰ STA. 23+86.0, 217.4' RT STORM MANHOLE, 4' DIAMETER
IDOT TYPE 1 FRAME AND GRATE, CLOSED LID
RIM = 597.69
INV = 593.40 (10" PVC, W)
INV = 593.40 (EX 12" RCP, N/S)
INSTALL IN-LINE CHECK VALVE IN 10" INLET PIPE FROM WEST.
SEE DETAIL
- ⑱ STA. 24+95.0, 12.0' RT STORM MANHOLE, 4' DIAMETER
IDOT TYPE 3 FRAME AND GRATE
RIM = 599.53
INV = 596.88 (12" RCP, E)
SEE NOTES
- ⑲ STA. 24+95.0, 12.0' RT STORM MANHOLE, 4' DIAMETER
IDOT TYPE 3 FRAME AND GRATE
RIM = 599.53
INV = 596.79 (12" RCP, W)
INV = 596.69 (12" PVC, S)
- ⑳ STA. 23+84.0, 13.3' LT 12" FLARED END SECTION
INV = 596.25
STABILIZE OUTFALL WITH 3 CY RIP RAP CL A3

PARKING LOT ALIGNMENT TABLE			
DESCRIPTION	STATION	NORTHING	EASTING
BOA	20+00.00	1788904.5987	1200510.3951
EOA	27+00.00	1789604.5987	1200510.3999



22 E. Chicago Avenue
Suite 200A
Naperville, IL 60540
T 630.961.1787
hitchcockdesigngroup.com

PREPARED FOR
Lan-Oak Park District
2550 178th Street
Lansing, IL 60438

PROJECT
Bock Park Phase One
17500 Lorenz Avenue
Lansing, IL 60438

CONSULTANTS
Civil Engineering
Civiltech Engineering, Inc.
30 N LaSalle St, Suite 3220
Chicago, Illinois 60602
T 630.735.7159

ISSUE FOR BID
JANUARY 8, 2025

REVISIONS

No	Date	Issue
2	2025.01.24	Addendum #2

CHECKED BY: JHA DRAWN BY: JRR/JR

SHEET TITLE
DRAINAGE PLAN

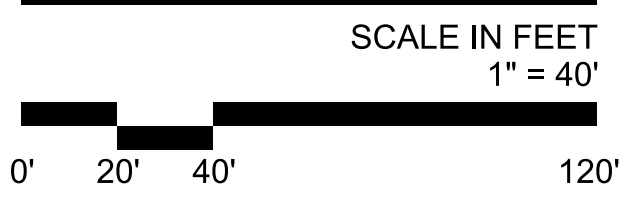

NORTH

SHEET NUMBER
C2.1
©2024 Hitchcock Design Group



PREPARED FOR
Lan-Oak Park District

2550 178th Street
Lansing, IL 60438

PROJECT
Bock Park Phase One

17500 Lorenz Avenue
Lansing, IL 60438

CONSULTANTS
Civil Engineering
Civitech Engineering, Inc.
30 N LaSalle St, Suite 3220
Chicago, Illinois 60602
T 630.735.7159

LEGEND
EP EDGE OF PAVEMENT
BC BACK OF CURB

ISSUE FOR BID
JANUARY 8, 2025

REVISIONS

No	Date	Issue
2	2025.01.24	Addendum #2

CHECKED BY
JHA

DRAWN BY
JRR/JR

SHEET TITLE
GRADING PLAN

SCALE IN FEET
1" = 40'



NORTH

SHEET NUMBER

C3.1

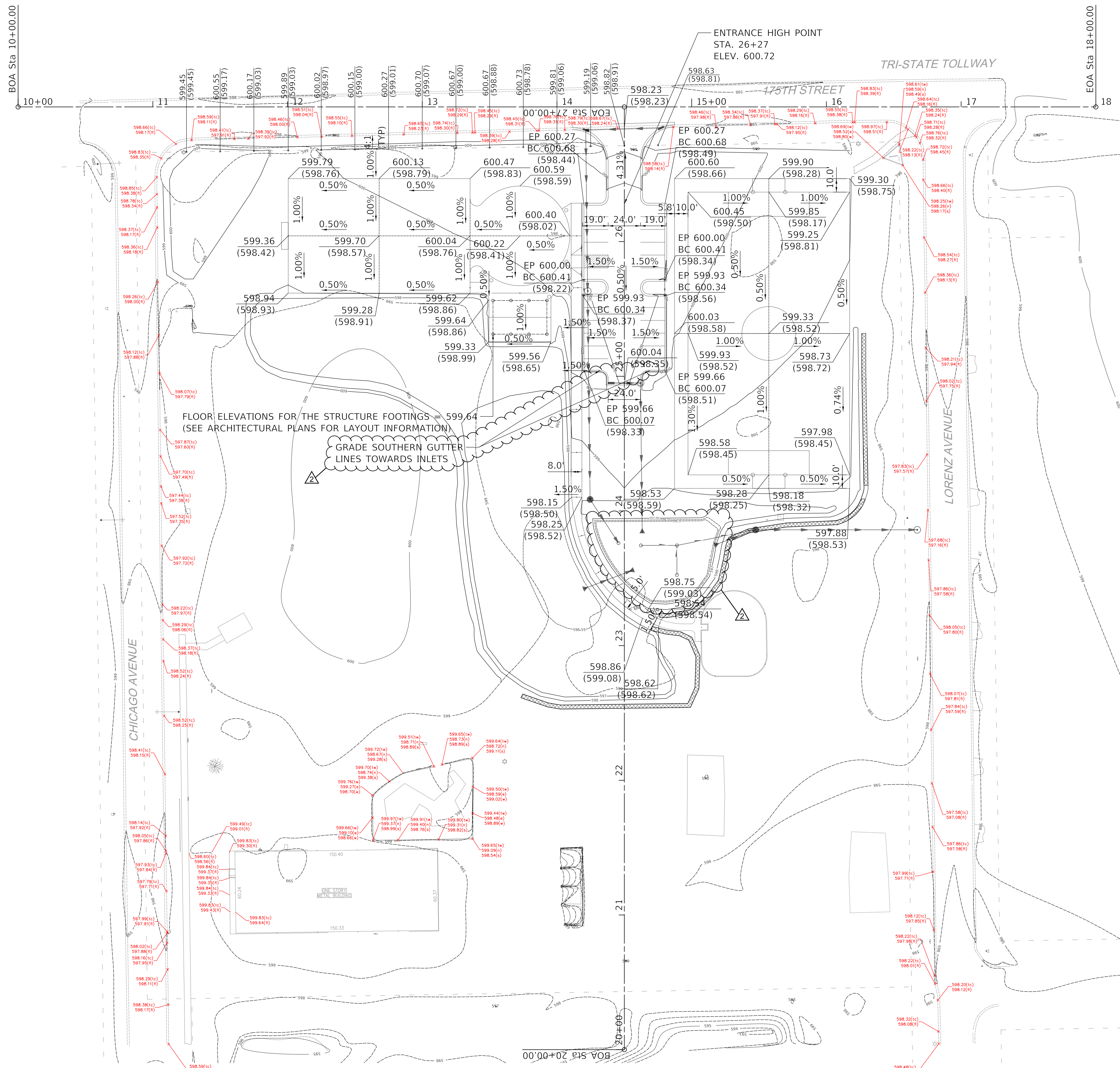

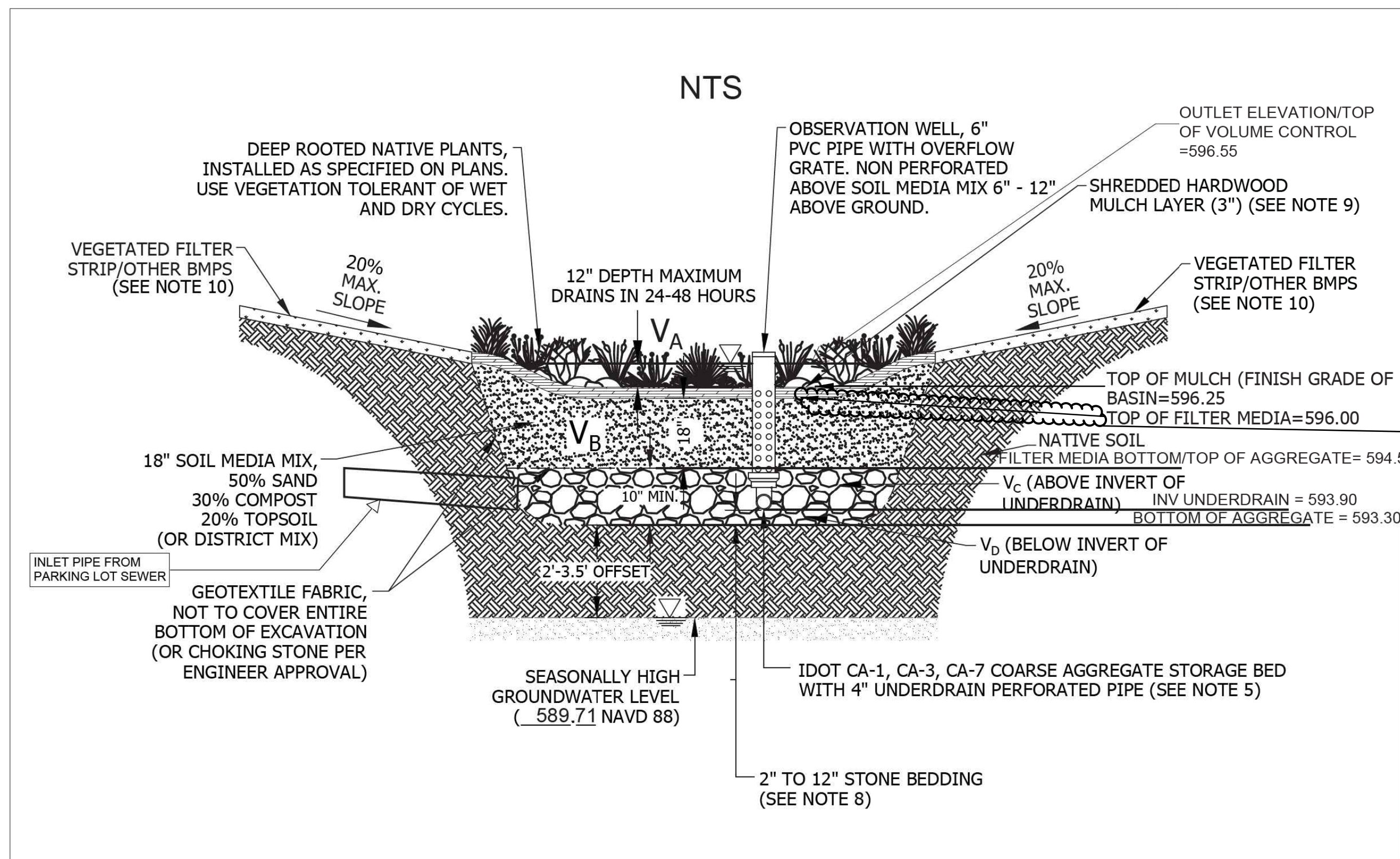
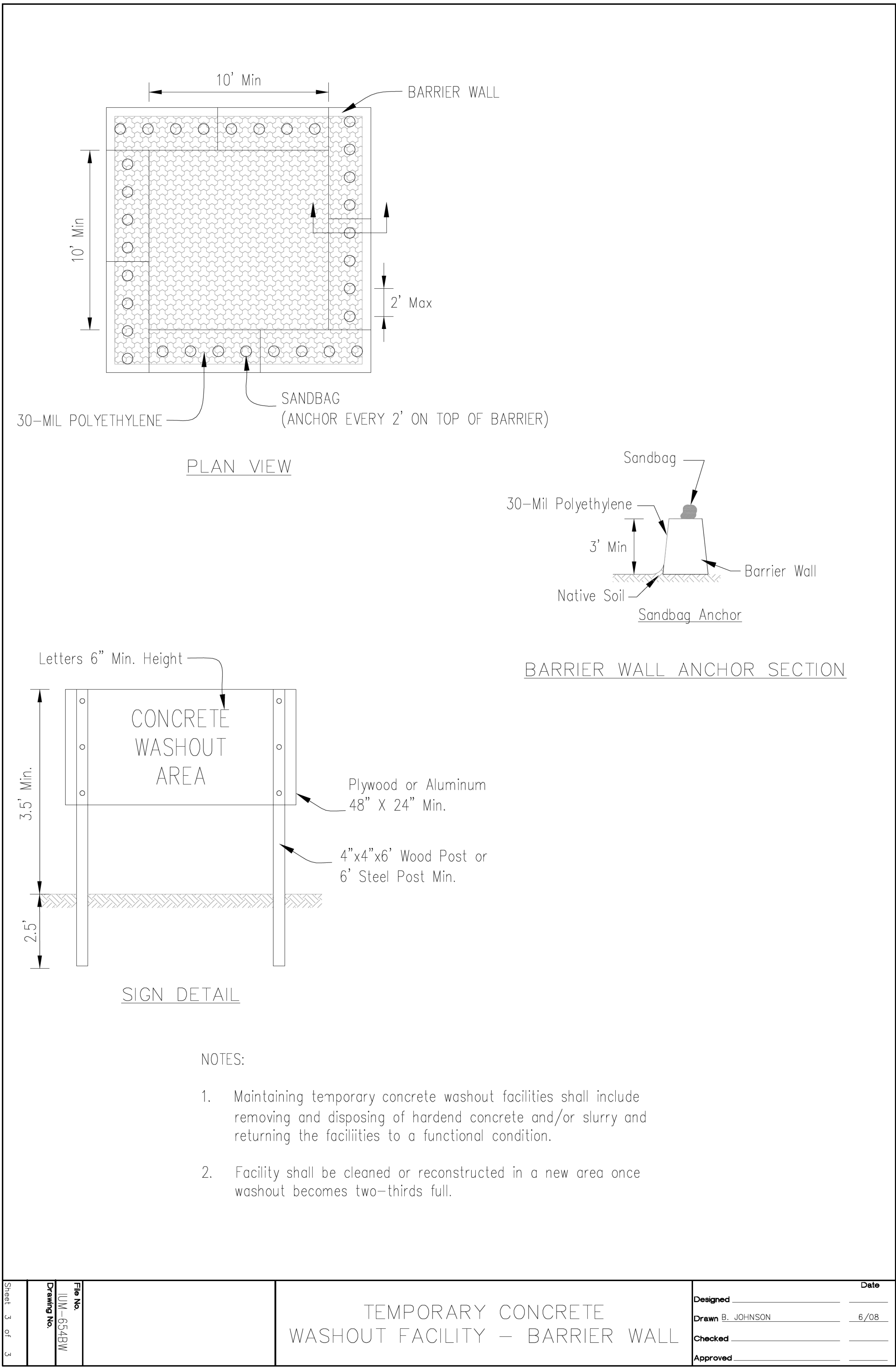

BOTTOM OF THE FACILITY:	ELEV.	593.30
SEASONALLY HIGH GROUNDWATER:	ELEV.	589.71
SEPARATION:	FEET	3.59

VOLUME TYPE	TOP SURFACE AREA [AC]	TOP ELEVATION OF SECTION [FT, ASL]	BOTTOM ELEVATION OF SECTION [FT, ASL]	DEPTH [FT]	POROSITY [-]	STORAGE VOLUME [AC-FT]	VOLUME PROVIDED [AC-FT]
V _A SURFACE STORAGE	0.086	596.55	596.25	0.30	1.00	(1.00)(V _A)	0.026
V _B SOIL MEDIA MIX (INCL. MULCH)	0.066	596.25	594.50	1.75	0.25	(0.5)(0.25)(V _B)	0.014
V _C COARSE AGGREGATE (ABOVE INVERT)	0.061	594.50	593.90	0.60	0.36	(0.5)(0.36)(V _C)	0.007
V _D COARSE AGGREGATE (BELOW INVERT)	0.057	593.90	593.30	0.60	0.36	(0.36)(V _D)	0.012
						TOTAL	0.059

- NOTES:
- THE PERIMETER OF THE VOLUME CONTROL FACILITY SHALL MAINTAIN THE MINIMUM HORIZONTAL SEPARATION DISTANCE OF: 10-FEET FROM FOUNDATIONS, UNLESS WATERPROOFED; 20-FEET FROM ROADWAY GRAVEL SHOULDER; AND 100-FEET FROM POTABLE WATER WELLS, SEPTIC TANKS/FIELDS, OR OTHER UNDERGROUND TANKS.
 - SANITARY OR COMBINED SEWERS SHALL NOT BE LOCATED WITHIN THE VOLUME CONTROL FACILITY. SANITARY OR COMBINED SEWERS SHALL NOT BE LOCATED BELOW THE FOOTPRINT OF THE VOLUME CONTROL FACILITY. WHEN LOCAL CONDITIONS PREVENT THE SEWER FROM BEING LOCATED OUTSIDE THE FOOTPRINT OF THE FACILITY THE SEWER SHALL BE CONSTRUCTED TO WATER MAIN QUALITY STANDARDS, OR IT SHALL BE ENCASED WITH A WATER MAIN QUALITY CARRIER PIPE WITH THE ENDS SEALED.
 - AVOID INSTALLATION ON SLOPES GREATER THAN 3.00%. AVOID COMPACTING NATIVE SOILS. SCARIFY ANY COMPACTED SOIL.
 - GEOTEXTILE FABRIC SHALL MEET REQUIREMENTS OF IUM MATERIAL SPECIFICATION 592. FOR WOVEN: APPARENT OPENING SIZE OF 0.50 MM (TABLE 1, CLASS I). FOR NON WOVEN: APPARENT OPENING SIZE OF 0.30 MM (TABLE 2, CLASS II).
 - STONE STORAGE OPTIONS ARE IDOT CA-1, CA-3, CA-7, DISTRICT VULCAN MIX, OR APPROVED ALTERNATE. NO RECYCLED MATERIALS.
 - MINIMUM DISTANCE OF 2 FEET (3.5 FEET IN COMBINED SEWER AREAS) BETWEEN BOTTOM OF BMP AND SEASONALLY HIGH GROUNDWATER LEVEL.
 - UNDERDRAINS ARE REQUIRED IN TYPICAL CLAYEY SOILS WHERE INFILTRATION RATES ARE LESS THAN 0.5 INCH/HOUR. NO MORE THAN 1 UNDERDRAIN EVERY 30 FEET ON CENTER. PROVIDE A SOIL REPORT DOCUMENTING NATIVE INFILTRATION RATE TO FOREGO UNDERDRAINS. NO FILTER FABRIC COVER/SOCK.
 - MINIMUM UNDERDRAIN BEDDING OF 2 INCHES, MAXIMUM OF 12 INCHES.
 - MULCH LAYER SHALL BE HARDWOOD MULCH OR OTHER NON-FLOATING GROUND COVER.
 - FOLLOW THE REQUIRED PRETREATMENT MEASURES LISTED ON THE VOLUME CONTROL PRETREATMENT MEASURES DETAIL.



TECHNICAL GUIDANCE MANUAL
 BIORETENTION FACILITY DETAIL

NOT TO SCALE
 10/11/18
 STD. DWG. NO.1
 PAGE NO.1

HITCHCOCK DESIGN GROUP
 creating better places

22 E. Chicago Avenue
 Suite 200A
 Naperville, IL 60540
 T 630.961.1787
 hitchcockdesigngroup.com

PREPARED FOR
Lan-Oak Park District
 2550 178th Street
 Lansing, IL 60438

PROJECT
Bock Park Phase One
 17500 Lorenz Avenue
 Lansing, IL 60438

CONSULTANTS
 Civil Engineering
 Civiltech Engineering, Inc.
 30 N LaSalle St, Suite 3220
 Chicago, Illinois 60602
 T 630.735.7159

ISSUE FOR BID
 JANUARY 8, 2025

REVISIONS

No	Date	Issue
2	2025.01.24	Addendum #2

CHECKED BY: JHA
 DRAWN BY: JRR/JR

SHEET TITLE
 DETAILS

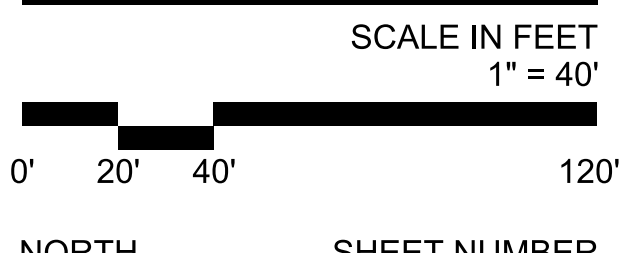

SHEET NUMBER
C4.2
 ©2024 Hitchcock Design Group



Sheet 3 of 3	Designed _____ Date _____ Drawn B. JOHNSON 6/08 Checked _____ Approved _____
File No. UM-6548W Drawing No.	TEMPORARY CONCRETE WASHOUT FACILITY - BARRIER WALL