

DRAWING PATH: T:\Columbus\1170\Projects\2024\24170307\_CDRK\_Gosline Reclamation\_New\_Lex\Ch\Civil\Geo-Env\Project\DocSet\2024-11-22\FIC\TITLE\_SHEET.dwg TAB: 1 TITLE SHEET SAME DATE: 2024-11-22 PAGE SIZE: A3(11x17) inches TAB: 1 TITLE SHEET SAME DATE: 2024-11-22 PAGE SIZE: A3(11x17) inches

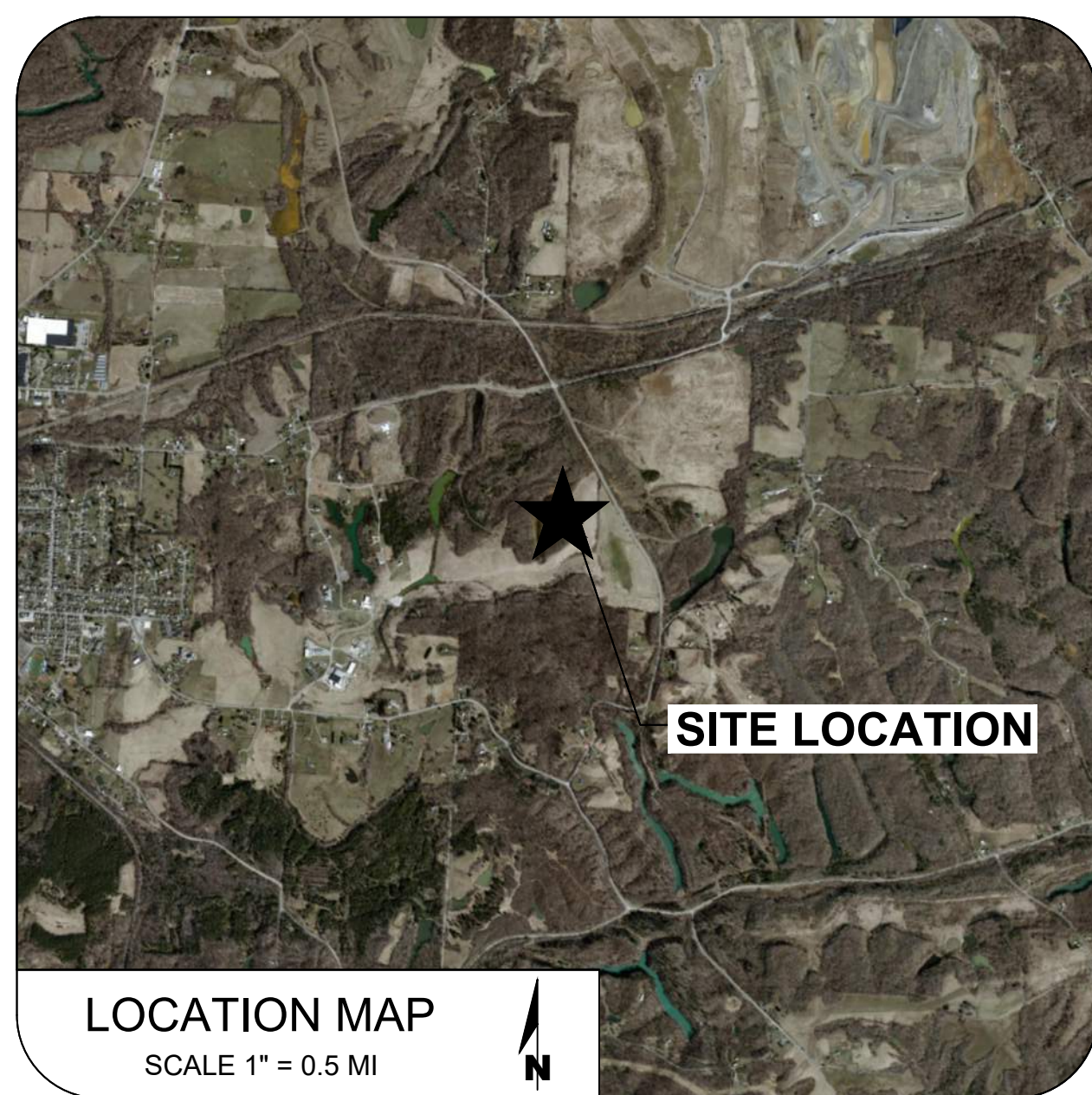
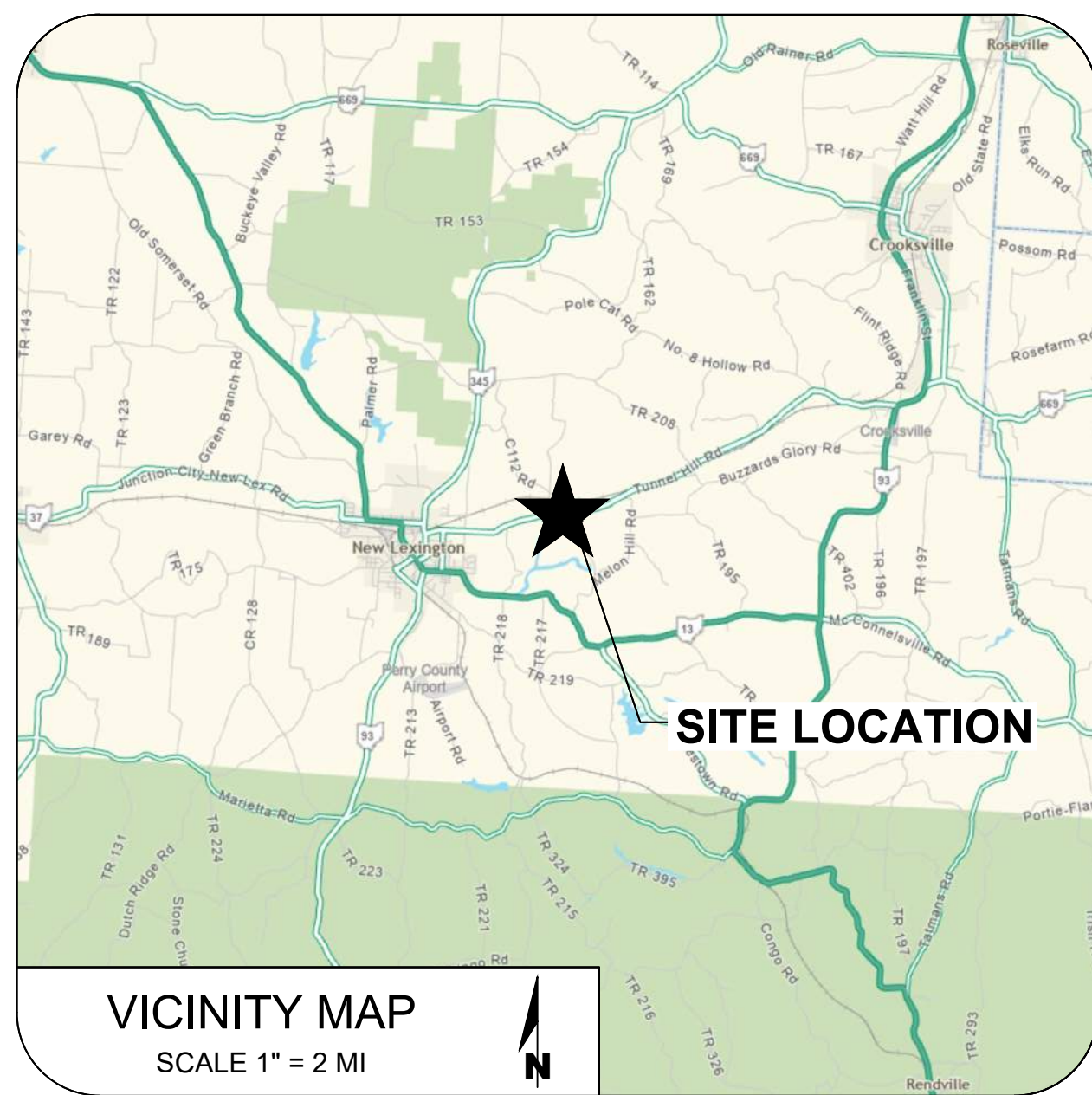
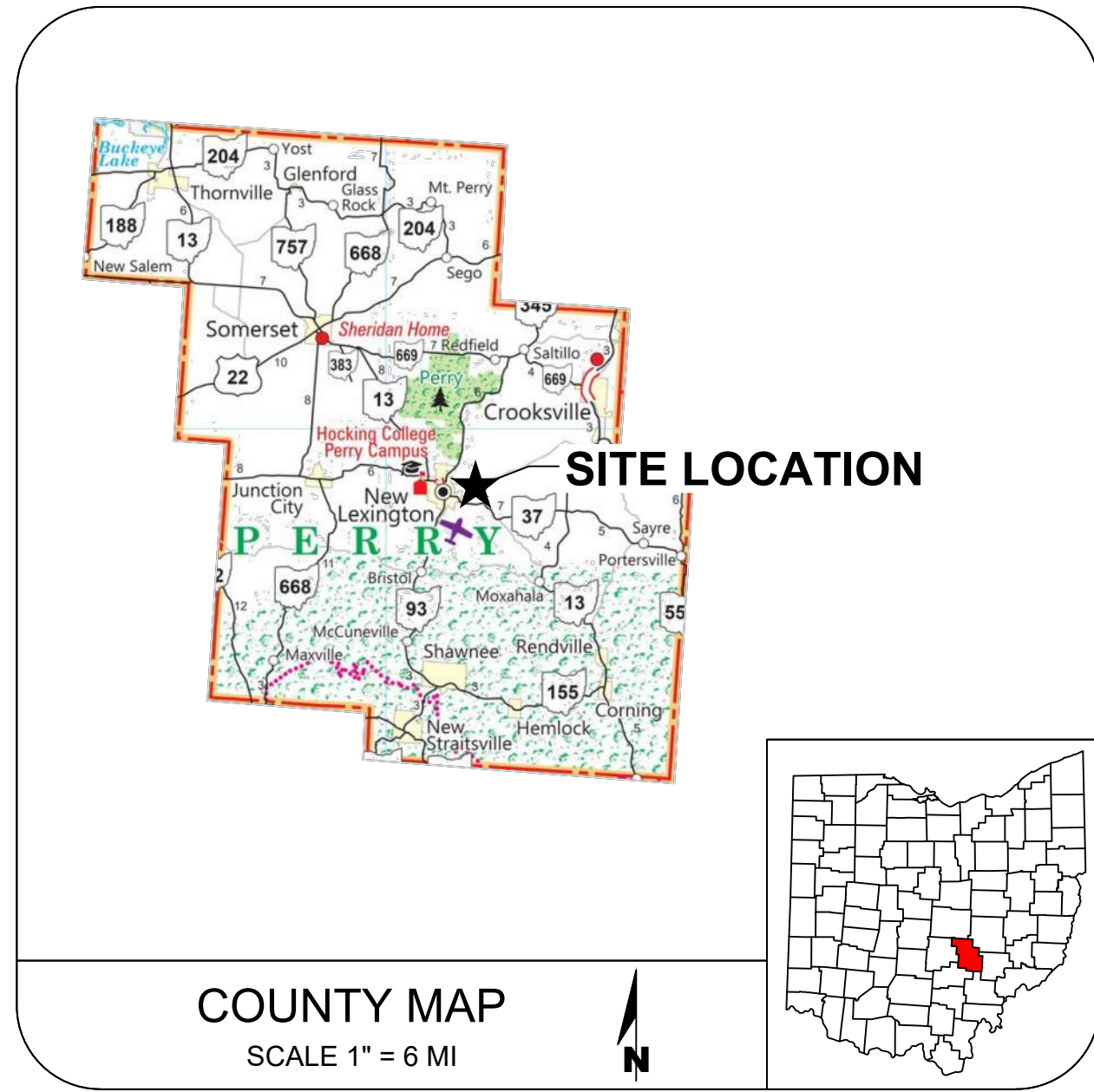

DIVISION OF MINERAL RESOURCES MANAGEMENT

# GOSLINE H2OHIO AMD

PIKE TOWNSHIP, PERRY COUNTY  
RECLAMATION PROJECT No. PR-Pk-50

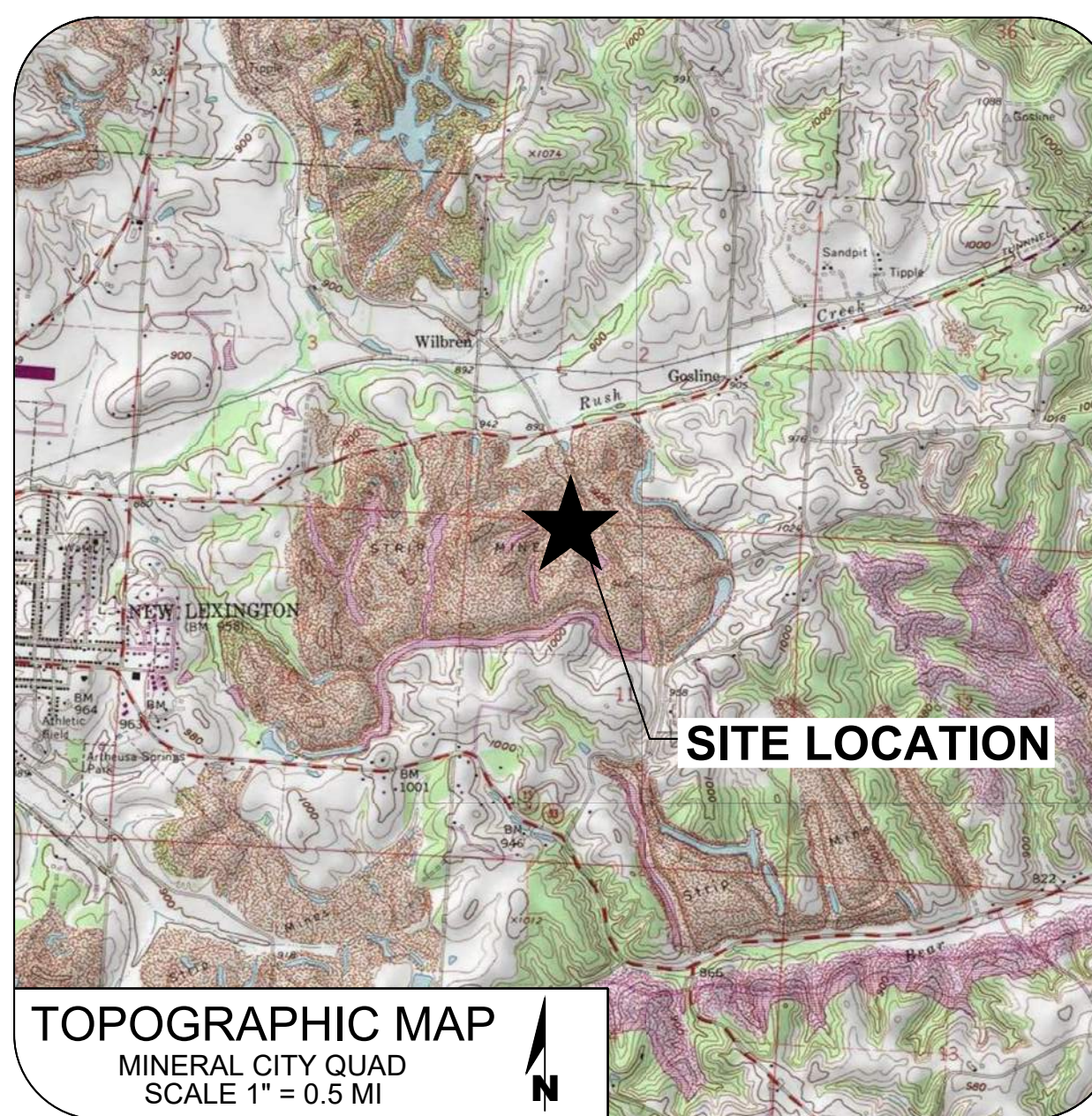

**CONTACT INFORMATION**

DIVISION OF MINERAL RESOURCES MANAGEMENT  
OHIO DEPARTMENT OF NATURAL RESOURCES  
9900 BRICK CHURCH RD. CAMBRIDGE, OHIO 43725  
PH: (740) 303-4209

PROJECT OFFICER:  
JEFF CALHOUN  
PH: (740) 274-4954

PROJECT ENGINEER:  
RONALD A. WARNER P.E.  
PH: (740) 303-4209

**SHEET INDEX**

TITLE	SHEET
TITLE SHEET	1
AERIAL PHOTO	2
EXISTING CONDITIONS	3
PROPOSED CONDITIONS	4
PROPOSED CHANNEL DIVERSION AREA	5
PROPOSED HIGHWALL BACKFILL AREA	6
PROPOSED RESOIL AREA	7
EROSION AND SEDIMENTATION CONTROLS	8
REVEGETATION PLAN	9
SECTIONS, HIGHWALL BACKFILL AREA	10
CONSTRUCTION DETAILS, CHANNEL DIVERSION 1	11
CONSTRUCTION DETAILS, UNDERDRAINS	12
CONSTRUCTION DETAILS, MISC.	13
CONSTRUCTION DETAILS, MISC.	14
CONSTRUCTION DETAILS, E&S CONTROLS	15

**OHIO Utilities Protection SERVICE**  
*Call Before You Dig*  
1-800-362-2764

OIL & GAS PRODUCERS UNDERGROUND PROTECTION SERVICE (www.ogpups.com)  
1-800-925-0988

CALL TWO WORKING DAYS BEFORE YOU DIG (NON MEMBERS MUST BE CALLED DIRECTLY)

THE LOCATIONS OF EXISTING UNDERGROUND UTILITIES ARE SHOWN APPROXIMATELY, BASED EITHER ON REPORTING BY RESPECTIVE OWNERS AND/OR BY FIELD LOCATION. HOWEVER, THE CONTRACTOR SHALL DETERMINE THE EXACT LOCATION OF ALL EXISTING UTILITIES PRIOR TO COMMENCING WORK AND AGREES TO BE FULLY RESPONSIBLE FOR ALL DAMAGES THAT MIGHT OCCUR BY THE CONTRACTOR'S FAILURE TO EXACTLY LOCATE AND PRESERVE ALL UNDERGROUND UTILITIES. THE CONTRACTOR SHALL MAINTAIN A CURRENT 10 DAY OUPS TICKET DURING THE ENTIRE PROJECT BY CONTACTING OUPS EVERY 10 DAYS.

**UTILITY CONTACT INFORMATION**

UTILITY COMPANY	UTILITY	PHONE #	MEMBER	NON-MEMBER
SOUTHERN PERRY COUNTY WATER	WATER	740-469-1268	X	
PIKE TOWNSHIP TRUSTEE'S OFFICE	ROAD	740-605-1605		X



DATE: 11/22/2024  
S. LOSKOTA, P.E.  
S&ME INC.



ACID MINE DRAINAGE  
ABANDONED MINE LAND PROGRAM  
ohiodnr.gov/mineral/



GOSLINE H2OHIO AMD  
PERRY COUNTY RECLAMATION PROJECT No. PR-Pk-50  
TITLE SHEET

DATE: NOVEMBER 22, 2024  
ISSUED FOR BID

REVISIONS  
DESIGN UNIT: CAMBRIDGE AMD  
N.R.E.: R. WARNER  
N.R.E.:  
P.O.: J. CALHOUN

DRAWING PATH: T:\Columbus\1170\Projects\2024\24170307\_CDMR\_Gosline Reclamation\_Nwr\_Loc\_Civil\Civil\_Gen-Env\Project Docs\2024-11-22\FCA\GENERAL PHOTOS.dwg TAB: 2 AERIAL PHOTO SAVE DATE: 2024-11-22 PAGE SIZE: ARCH Full Sheet D (24.00 x 36.00 inches)

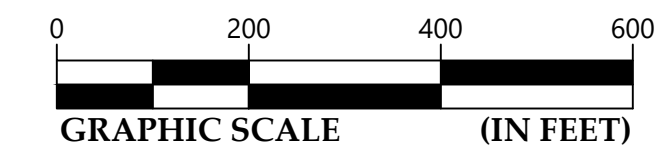

**LEGEND**

- CWL — CWL — CONSTRUCTION WORK LIMITS
- P — P — PROPERTY LINES
- D PERMIT, SURFACE MINE LIMIT
- DW — DW — EXISTING WATER LINE
- — — EXISTING ROADWAY

**NOTES**

1. THIS MAP DOES NOT CONSTITUTE A BOUNDARY SURVEY PER OHIO ADMINISTRATIVE CODE CHAPTER 4733-37. MINIMUM STANDARDS FOR BOUNDARY SURVEYS. ALL PROPERTY LINES SHOWN ARE FROM THE PERRY COUNTY TAX MAPS AND HAVE NOT BEEN VERIFIED IN ANY WAY.
2. PHOTO IMAGE DATA OBTAINED FROM OHIO STATEWIDE IMAGERY PROGRAM (OGRIP) TAKEN IN 2019.



**ACID MINE DRAINAGE  
ABANDONED MINE LAND PROGRAM**



ohio.dnr.gov/mineral/

**GOSLINE H2OHIO AMD  
PERRY COUNTY RECLAMATION PROJECT No. PR-Pk-50  
AERIAL PHOTO**

DATE: NOVEMBER 22, 2024  
ISSUED FOR BID

REVISIONS

DESIGN UNIT  
CAMBRIDGE AMD  
NRE: R. WARNER  
P.D. J. CALHOUN

DRAWING PATH: T:\Columbus\1170\Projects\2024\24170307\_CDRM\_Gosline Reclamation\_Mw\loc\CH\Civil\Gen-Env\Project\Drawings\2024-11-22\FG\EXISTING\_CONDITIONS\_SAVE DATE: 2024-11-22 PAGE SIZE: ARCH full bleed D (24.00 x 36.00 inches)



42-INCH CULVERT - TOP OF PIPE									SITE REFERENCE BENCHMARKS				
	UPSTREAM (WEST END)				DOWNSTREAM (EAST END)				POINT	NORTHING	EASTING	ELEV	DESC
	POINT	NORTHING	EASTING	ELEV	POINT	NORTHING	EASTING	ELEV					
NORTH PIPE	142	626694.3676	2060629.6114	891.0	137	626740.7365	2060674.0005	890.4	BM1	625608.73	20612808.19	913.01	IRON PIN
MIDDLE PIPE	141	626690.0036	2060634.0152	890.9	138	626736.2982	2060678.4013	890.3	BM2	625914.21	2061097.98	906.77	IRON PIN
SOUTH PIPE	144	626685.8181	2060638.6514	890.8	139	626731.7319	2060682.9566	890.3					

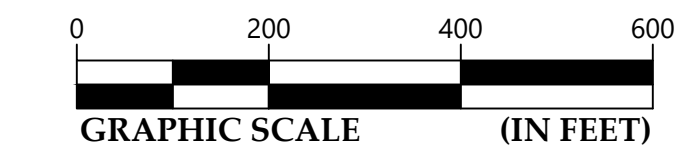

LEGEND	
	EXISTING 10' CONTOUR
	EXISTING 2' CONTOUR
	EXISTING TREELINE
	EXISTING CULVERT
	EXISTING PROPERTY LINES
	CONSTRUCTION WORK LIMITS
	EXISTING WATER LINE
	EXISTING WATERWAY
	EXISTING ROADWAY
	EXISTING SURVEY CONTROL

- NOTES**
- UTILITY LINES AND APPURTENANCES ARE SHOWN AS LOCATED IN THE FIELD AND/OR AS REPORTED BY THE RESPECTIVE OWNERS. NEITHER THE NUMBER, TYPE, SIZE, OR LOCATION CAN BE GUARANTEED, AND IT IS THEREFORE THE RESPONSIBILITY OF THE CONTRACTOR TO VERIFY ALL UTILITY LOCATIONS.
  - COORDINATE SYSTEM: OHIO STATE PLANE SOUTH NAD83 (2011) NAVD88 GEOID 12A CORS DERIVED
  - CONTROL POINTS ARE BASED ON AN ACTUAL FIELD SURVEY BY ROBERT A. LOWE P.S. ON APRIL 5, 2024.
  - TOPOGRAPHY FROM LIGHT DETECTION AND RANGING (LIDAR) MAPPING PREPARED BY OHIO STATEWIDE IMAGERY PROGRAMS (OSIP), FLIGHT DATE 2013.
  - INVERT ELEVATIONS OF PIPES ESTIMATED BASED ON SURVEYED ELEVATION OF TOP OF PIPES



**ACID MINE DRAINAGE  
ABANDONED MINE LAND PROGRAM**  
ohiodnr.gov/mineral/



**GOSLINE H2OHIO AMD**  
PERRY COUNTY RECLAMATION PROJECT No. PR-Pk-50  
**EXISTING CONDITIONS**

DATE: NOVEMBER 22, 2024  
ISSUED FOR BID

REVISIONS

DESIGN UNIT  
CAMBRIDGE AMD  
N.R.E. R. WARNER  
P.O. J. CALHOUN

DRAWING PATH: T:\Columbus\1170\Projects\2024\24170307\_CDRK\_Gosline Reclamation\_New\_Loc\_Civil\Gen-Env\Project\Drawings\2024-11-22-IFC\PROPOSED\_COND\CONDITIONS.dwg; TAB: 4-PROPOSED\_COND\CONDITIONS.dwg; DATE: 2024-11-22; PAGE SIZE: ARCHIT full bleed D (24.00 x 36.00 inches)

Quantities Summary			
Item	Description	Estimated Quantities	Sheet Reference
2100	Mobilization/Access	1 LS	n/a
2112	Maintaining Traffic	1 LS	n/a
2121	Clearing and Grubbing	36 Acre	8
2130	Impoundment Dewatering	1.8 Mgal	8
2200	Earthwork	121,100 CY	5, 6, 7
	- Material Sources		
	Near or Adjacent to Fill Areas	46,300 CY	
	On-Site Borrow	74,800 CY	
2209	Grading	12 Acre	5, 7
2401	Compacted Fill	510 CY	13
2702	Specific Work Allowance	15,000 Each	n/a
3140	Type D Rock Channel Protection	1,540 Tons	5, 6, 7, 13
3217	Geotextile	1,070 SY	12, 13, 15
	Type A	290 SY	
	Type B	780 SY	
3309	Culvert Cleanout	192 LF	4
3341	Concrete Headwall	1 Each	5, 11
3354	Concrete	2 CY	5, 11
3356	15" PE/PVC Culvert	42 LF	5, 11
3410	Silt Fence / Straw Bale Dikes	4,030 LF	8
3450	No.1 & No.2 Stone	95 Tons	11, 15
3451	# 3 and # 4 Stone	940 Tons	13, 14, 15
3454	# 57 Stone	460 Tons	12, 14
3455	Washed River Gravel	80 Tons	12
4100	Underdrains	160 LF	5, 7, 12
4200	Outlet Pipe	280 LF	5, 7, 12
4526	Impervious Liner	1,000 LF	6, 12
5106	Off Site Borrow	27,600 Tons	5, 7, 13
	Resoil	27,570 Tons	
	Compacted Fill	30 Tons	
6100	Standard Revegetation	35 Acre	9
6310	Lime	350 Tons	9
	Pre-Resoil Placement	140 Tons	
	Final Grade Treatment	210 Tons	
8127	Aggregate Drains	1,000 LF	6, 12
9991	Surveying	1 LS	n/a

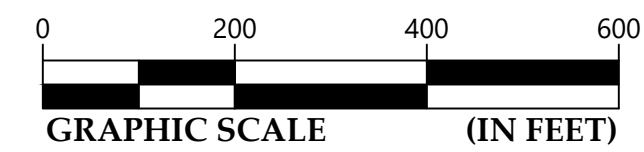

LEGEND	
	EXISTING 10' CONTOUR
	EXISTING 2' CONTOUR
	PROPOSED 10' CONTOUR
	PROPOSED 2' CONTOUR
	CWL
	CWL
	CONSTRUCTION WORK LIMITS
	DW
	EXISTING WATER LINE
	EXISTING ROADWAY
	PROPOSED ACCESS ROAD IMPROVEMENTS, TO REMAIN
	PROPOSED WETLAND ROCK BERM
	PROPOSED RESOIL AREA
	RESTRICTED ACCESS AREA

- NOTES**
- ALL DISTURBED AREAS SHALL BE PROTECTED FROM EROSION AND SHALL BE RECLAIMED IN A CONTEMPORANEOUS FASHION.
  - SUPPLEMENTAL MATERIAL TO BALANCE THE EARTHWORK SHALL BE OBTAINED FROM DESIGNATED ON-SITE BORROW AREA. BORROW AREA SHALL BE MAINTAINED WITH POSITIVE DRAINAGE THROUGHOUT PROJECT WORK. FINAL GRADES OF BORROW AREA SHALL BE NO STEEPER THAN 4H TO 1V AND NO SHALLOWER THAN 50H TO 1V.
  - SEDIMENT AND OTHER DEBRIS SHALL BE REMOVED FROM THE TRIPLE BARREL 42-INCH DIAMETER PIPE CULVERTS.



**ACID MINE DRAINAGE  
ABANDONED MINE LAND PROGRAM**



**GOSLINE H2OHIO AMD  
PERRY COUNTY RECLAMATION PROJECT No. PR-Pk-50  
PROPOSED CONDITIONS**

DATE:  
NOVEMBER 22, 2024  
ISSUED FOR BID

REVISIONS

DESIGN UNIT  
CAMBRIDGE AMD  
N.R.E. R. WARNER  
N.R.E. ---  
P.O. J. CALHOUN

DRAWING PATH: T:\Columbus\1170\Projects\2024\2024-11-22\FC\PROPOSED DIVERSION CHANNEL.dwg TAB: 5 PROPOSED CHANNEL DIVERSION AREA SAVE DATE: 2024-11-21 PAGE SIZE: ARCH D (24.00 x 36.00 inches)

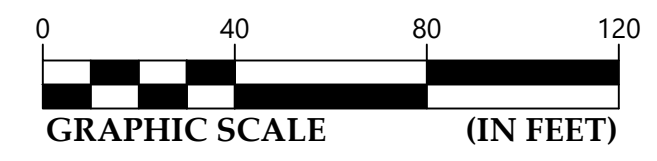
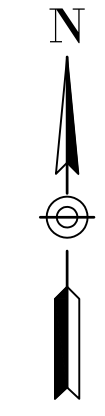

LEGEND	
	EXISTING 10' CONTOUR
	EXISTING 2' CONTOUR
	PROPOSED 10' CONTOUR
	PROPOSED 2' CONTOUR
	CONSTRUCTION LIMITS
	PROPOSED GRAVEL DRIVE
	EXISTING CULVERT
	EXISTING WATERWAYS
	EXISTING WATER LINE
	LIMESTONE CHANNEL
	PROPOSED WETLAND ROCK BERM
	PROPOSED RESOIL AREA
	RESTRICTED ACCESS AREA

- NOTES**
- CONSTRUCTION ACCESS IS RESTRICTED WITHIN THE WETLAND/CATAL AREA. DISTURBANCE IS LIMITED TO ONLY THAT NECESSARY FOR INSTALLATION OF WETLAND ROCK BERMS AND WETLAND CONTAINMENT BERMS.
  - RESOIL MATERIAL SHALL BE OFF-SITE BORROW OBTAINED FROM BUCKEYE LAKE LIEBS ISLAND DREDGE CELL.
  - WITHIN RESOIL LIMITS, GRADE TO ELIMINATE EROSION RILLS PRIOR TO PLACEMENT OF RESOIL MATERIAL. NO PROPOSED GRADES DEPICTED FOR RESOIL. PLACE MATERIAL MINIMUM OF 1.0 FEET THICK ON RE-GRADED SURFACE. TAPER THICKNESS AROUND PERIMETER TO TRANSITION TO EXISTING GRADE IN A MANNER SO AS NOT TO CAUSE PONDING.



**ACID MINE DRAINAGE  
ABANDONED MINE LAND PROGRAM**



**GOSLINE H2OHIO AMD  
PERRY COUNTY RECLAMATION PROJECT No. PR-Pk-50  
PROPOSED CHANNEL DIVERSION AREA**

DATE: NOVEMBER 22, 2024  
ISSUED FOR BID

REVISIONS

DESIGN UNIT  
CAMBRIDGE AMD  
NRE: R. WARNER  
P.O. J. CALHOUN

ohiodnr.gov/mineral/

DRAWING PATH: T:\Columbus\1170\Projects\2024\24170307\_CDMR\_Gosline Reclamation\_New\_Loc\_Civil\Civil\_Geo-Env\Project Docs\2024-11-22\FCD\PROPOSED\_CONDUCTIONS.dwg; TAB: 6 PROPOSED HIGHWALL BACKFILL AREA; SAVE DATE: 2024-11-22; PAGE SIZE: ARCH (Landscape) (24.00 x 36.00) (inches)

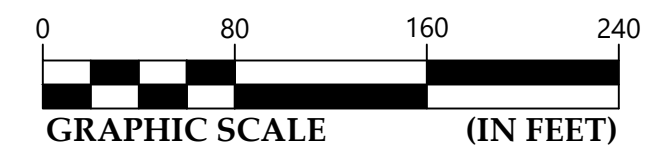
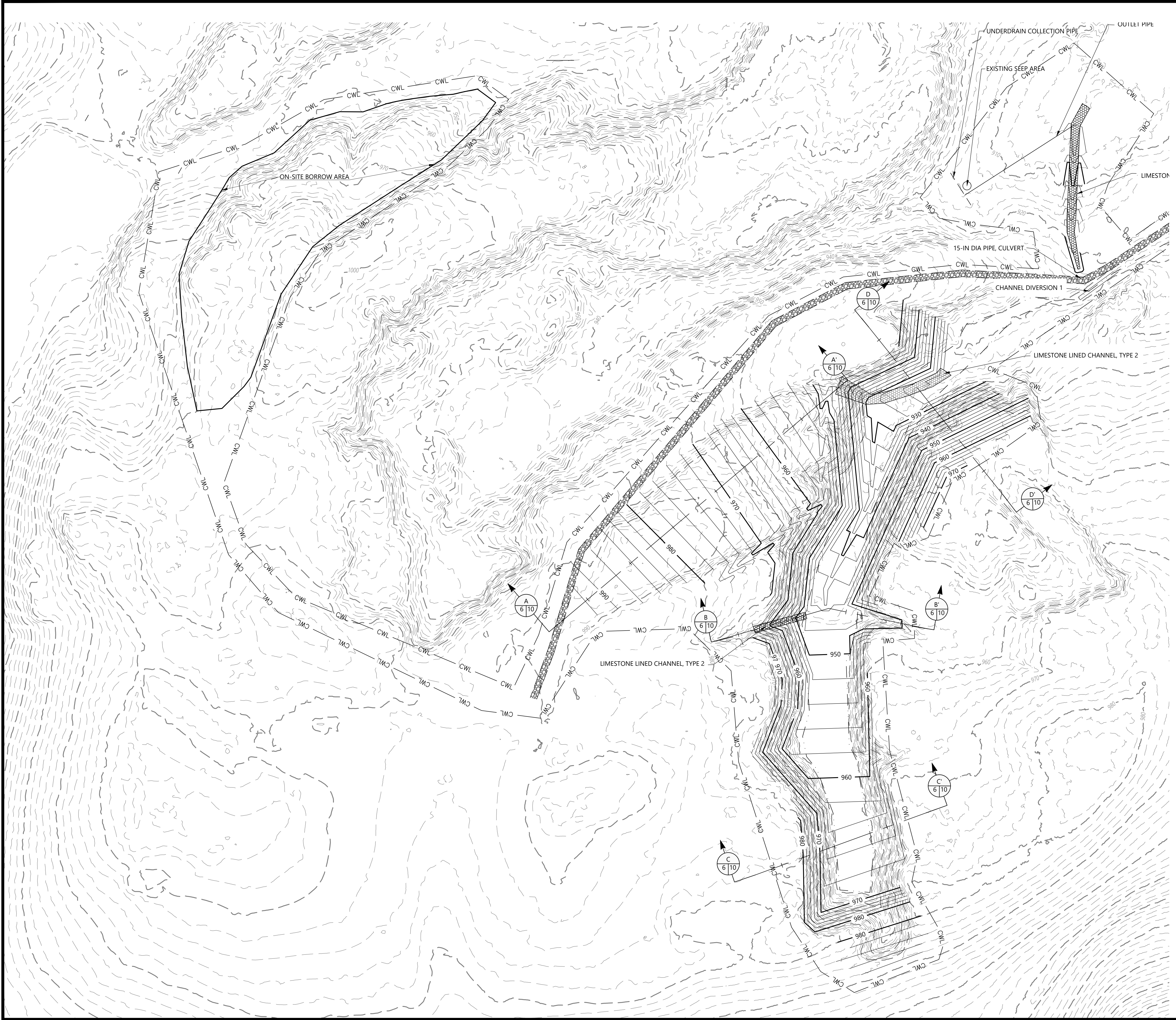

LEGEND	
	EXISTING 10' CONTOUR
	EXISTING 2' CONTOUR
	PROPOSED 10' CONTOUR
	PROPOSED 2' CONTOUR
	CONSTRUCTION WORK LIMITS
	EXISTING WATER LINE
	LIMESTONE CHANNEL
	PROPOSED ACCESS ROAD IMPROVEMENTS, TO REMAIN
	PROPOSED BORROW AREA

- NOTES**
- INSTALL AGGREGATE DRAINS AT LOCATIONS AND ELEVATIONS AS DIRECTED BY THE CHIEF'S REPRESENTATIVE.
  - SUPPLEMENTAL MATERIAL TO BALANCE THE EARTHWORK SHALL BE OBTAINED FROM DESIGNATED ON-SITE BORROW AREA. BORROW AREA SHALL BE MAINTAINED WITH POSITIVE DRAINAGE THROUGHOUT PROJECT WORK. FINAL GRADES OF BORROW AREA SHALL BE NO STEEPER THAN 4H TO 1V AND NO SHALLOWER THAN 50H TO 1V.



**ACID MINE DRAINAGE  
ABANDONED MINE LAND PROGRAM**



**GOSLINE H2OHIO AMD  
PERRY COUNTY RECLAMATION PROJECT No. PR-Pk-50  
PROPOSED HIGHWALL BACKFILL AREA**

DATE: NOVEMBER 22, 2024  
ISSUED FOR BID

REVISIONS

DESIGN UNIT  
CAMBRIDGE AMD  
N.R.E. R. WARNER  
P.O. J. CALHOUN

ohiodnr.gov/mineral/

DRAWING PATH: T:\Columbus\1170\Projects\2024\24170307\_CDRM\_Gosline Reclamation\_New\_Loc\_Civil\Gen-Env\Project\Draw\2024-11-22\PROPOSED\_RESOIL\_AREA\_SAVE DATE: 2024-11-22 PAGE SIZE: ARCH\A based D (64.00 x 36.00 inches)

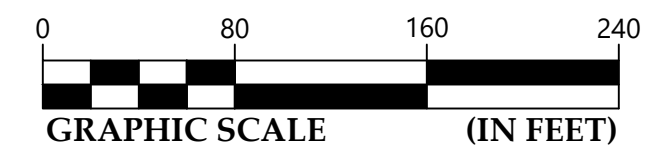
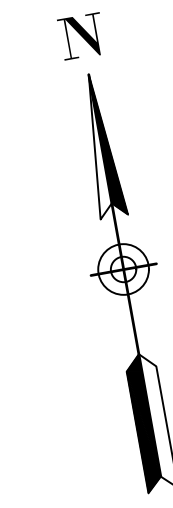
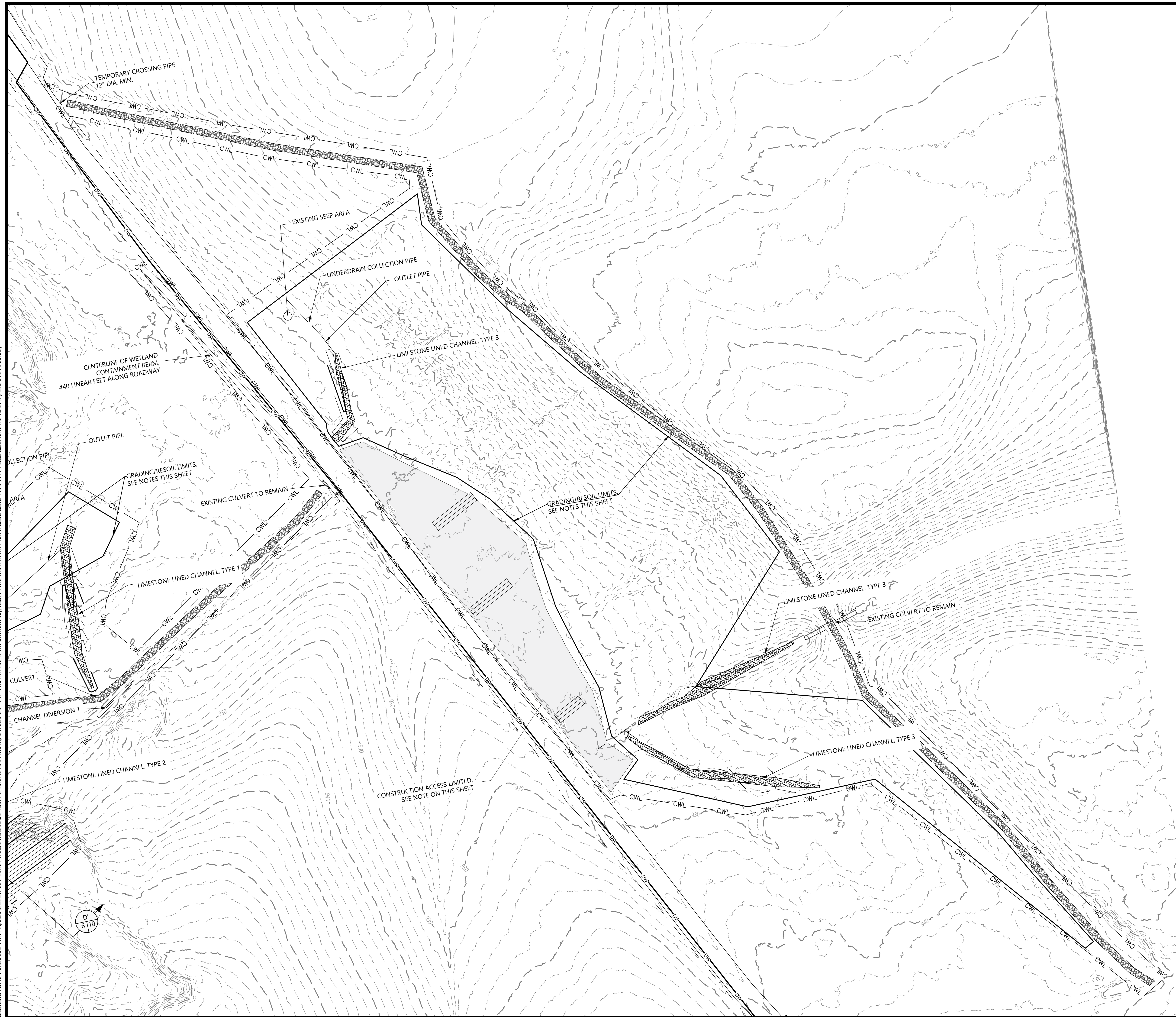

LEGEND	
	EXISTING 10' CONTOUR
	EXISTING 2' CONTOUR
	PROPOSED 10' CONTOUR
	PROPOSED 2' CONTOUR
	CONSTRUCTION LIMITS
	EXISTING WATER LINE
	EXISTING ROADWAY
	PROPOSED ACCESS ROAD IMPROVEMENTS, TO REMAIN
	LIMESTONE CHANNEL
	PROPOSED WETLAND ROCK BERM
	PROPOSED RESOIL AREA
	RESTRICTED ACCESS AREA

- NOTES**
- CONSTRUCTION ACCESS IS RESTRICTED WITHIN THE WETLAND/CATAIL AREA. DISTURBANCE IS LIMITED TO ONLY THAT NECESSARY FOR INSTALLATION OF WETLAND ROCK BERMS.
  - RESOIL MATERIAL SHALL BE OFF-SITE BORROW OBTAINED FROM BUCKEYE LAKE LIEBS ISLAND DREDGE CELL.
  - WITHIN RESOIL LIMITS, GRADE TO ELIMINATE EROSION RILLS PRIOR TO PLACEMENT OF RESOIL MATERIAL. NO PROPOSED GRADES DEPICTED FOR RESOIL. PLACE MATERIAL MINIMUM OF 1.0 FEET THICK ON RE-GRADED SURFACE. TAPER THICKNESS AROUND PERIMETER TO TRANSITION TO EXISTING GRADE IN A MANNER SO AS NOT TO CAUSE PONDING.



**ACID MINE DRAINAGE  
ABANDONED MINE LAND PROGRAM**



**GOSLINE H2OHIO AMD  
PERRY COUNTY RECLAMATION PROJECT No. PR-Pk-50  
PROPOSED RESOIL AREA**

DATE: NOVEMBER 22, 2024  
ISSUED FOR BID

REVISIONS

DESIGN UNIT  
CAMBRIDGE AMD  
N.R.E. R. WARNER  
P.O. J. CALHOUN

DRAWING PATH: T:\Projects\2024\170307\_CDRK\_Gosline Reclamation\_Nwr\_Loc\Civil\Gen-Env\Project\DocSet\2024-11-22\FCS\SWPPP.dwg TAB: 6 EROSION AND SEDIMENTATION CONTROLS SAVE DATE: 2024-11-22 PAGE SIZE: ARCH (11.00 x 16.00 inches)

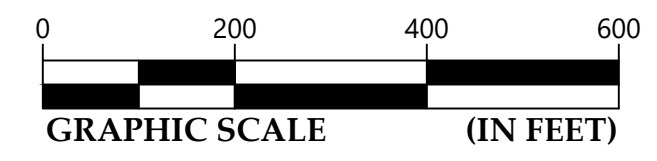
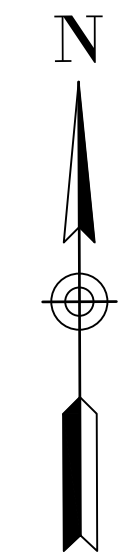

**LEGEND**

- EXISTING 10' CONTOUR
- EXISTING 2' CONTOUR
- PROPOSED 10' CONTOUR
- PROPOSED 2' CONTOUR
- PROPOSED GRAVEL DRIVE
- SILT FENCE
- EXISTING ROADWAY
- PROPOSED RESOIL AREA
- RESTRICTED ACCESS AREA
- ROCK CHECK DAM
- STRAW BALE DIKE
- CONSTRUCTION ENTRANCE

**NOTES**

1. EROSION AND SEDIMENTATION CONTROL SHALL CONFORM TO THE PROJECT STORMWATER POLLUTION PREVENTION PLAN
2. CLEARING AND GRUBBING TO BE COMPLETED WITHIN THE CONSTRUCTION WORK LIMITS, EXCLUDING THE RESTRICTED ACCESS AREAS. NO CLEARING OR GRUBBING IS TO BE COMPLETED WITHIN THE RESTRICTED ACCESS AREAS.



**ACID MINE DRAINAGE  
ABANDONED MINE LAND PROGRAM**  
ohiodnr.gov/mineral/



**GOSLINE H2OHIO AMD**  
PERRY COUNTY RECLAMATION PROJECT No. PR-Pk-50  
**EROSION AND SEDIMENTATION CONTROLS**

DATE: **NOVEMBER 22, 2024**  
ISSUED FOR BID

REVISIONS

DESIGN UNIT  
**CAMBRIDGE AMD**  
N.R.E. **R. WARNER**  
P.O. **J. CALHOUN**



DRAWING PATH: T:\Columbus\1170\Projects\2024\24170307\_CDMR\_Gosline Reclamation\_Nov\_Loc\_Civil\_Geo-Env\Project Docs\2024-11-22\FCS\SWPPP.dwg TAB: 9 REVEGETATION PLAN SAVE DATE: 2024-11-22 PAGE SIZE: ARCH full bleed D (24.00 x 36.00 inches)

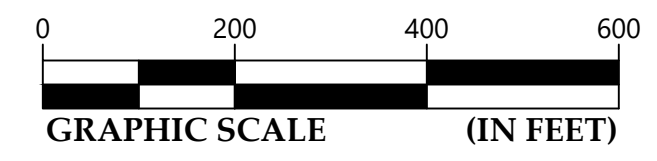

**LEGEND**

- EXISTING 10' CONTOUR
- EXISTING 2' CONTOUR
- PROPOSED 10' CONTOUR
- PROPOSED 2' CONTOUR
- CONSTRUCTION LIMITS
- PROPOSED GRAVEL DRIVE
- EXISTING WATERWAYS
- EXISTING ROADWAY
- PROPOSED RESOIL AREA
- RESTRICTED ACCESS AREA

**NOTES**

1. RESTRICTED ACCESS AREAS - DO NOT RE-VEGETATE.
2. EXPOSED AGGREGATE AT SURFACE AREAS - DO NOT RE-VEGETATE.
3. RESOIL AREAS - PLACE AND DISC LIME INTO THE GRADED SURFACE PRIOR TO PLACEMENT OF RESOIL MATERIAL. NO ADDITIONAL LIME REQUIRED AT FINAL GRADE. FERTILIZE, SEED, AND MULCH RESOIL PER ITEM 6100 STANDARD REVEGETATION REQUIREMENTS.
4. ALL OTHER AREAS WITHIN CONSTRUCTION WORK LIMITS - LIME, FERTILIZE, SEED, AND MULCH PER ITEM 6100 STANDARD REVEGETATION REQUIREMENTS.



**ACID MINE DRAINAGE  
ABANDONED MINE LAND PROGRAM**  
ohiodnr.gov/mineral/



**GOSLINE H2OHIO AMD  
PERRY COUNTY RECLAMATION PROJECT No. PR-Pk-50  
REVEGETATION PLAN**

DATE: NOVEMBER 22, 2024  
ISSUED FOR BID

REVISIONS

DESIGN UNIT  
CAMBRIDGE AMD  
N.R.E. R. WARNER  
P.O. J. CALHOUN

DRAWING PATH: T:\Columbus\1170\Projects\2024\24170307\_CDR\Gosline Reclamation\_Non\_Loc\_Civil\_Gen\_Env\Project\_Doc\2024\_11\_22\_IFC\PROPOSED\_CONDITIONS.dwg TAB: 10 SECTIONS HIGHWALL BACKFILL AREA SAVE DATE: 2024-11-22 PAGE SIZE: ARCH (vertical bleed) D (24.00 x 36.00 inches)

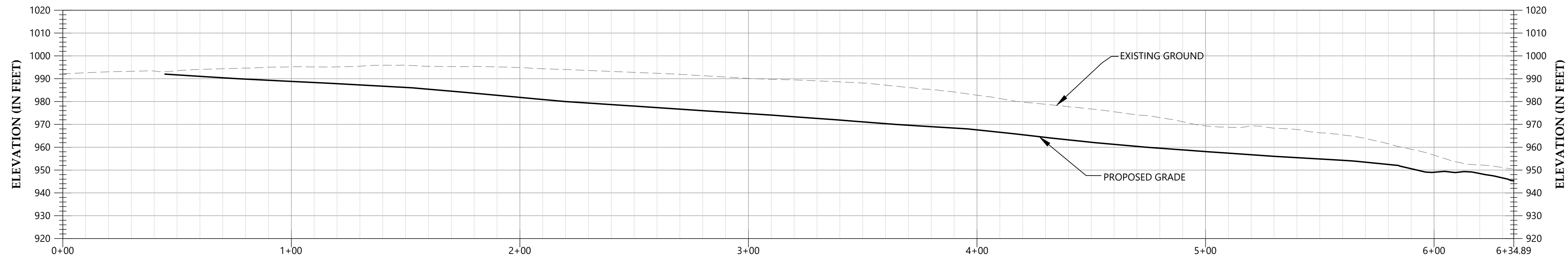

A  
6 | 10 PROFILE A-A'

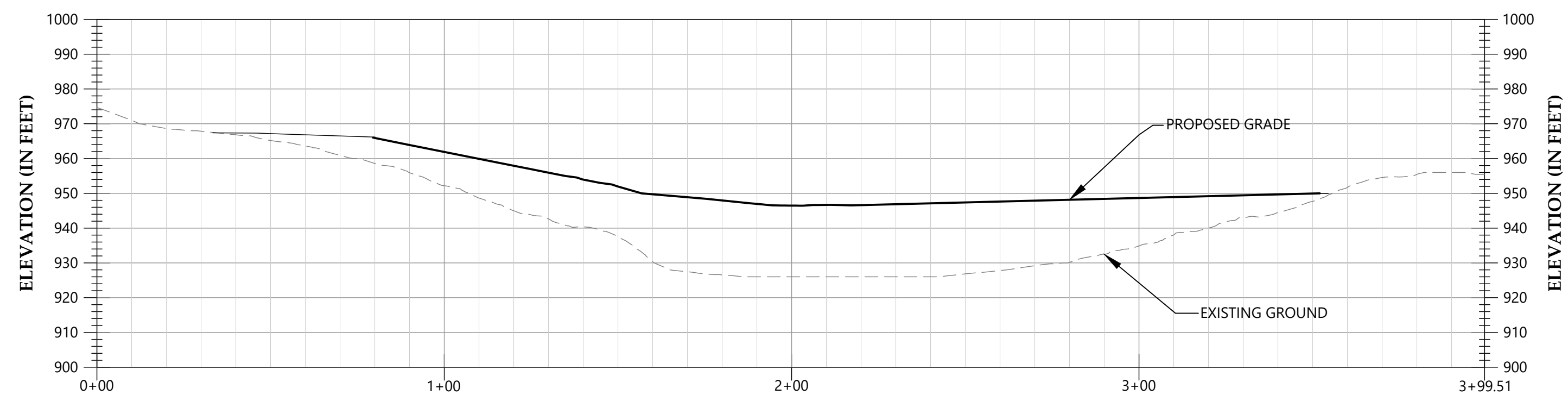

B  
6 | 10 PROFILE B-B'

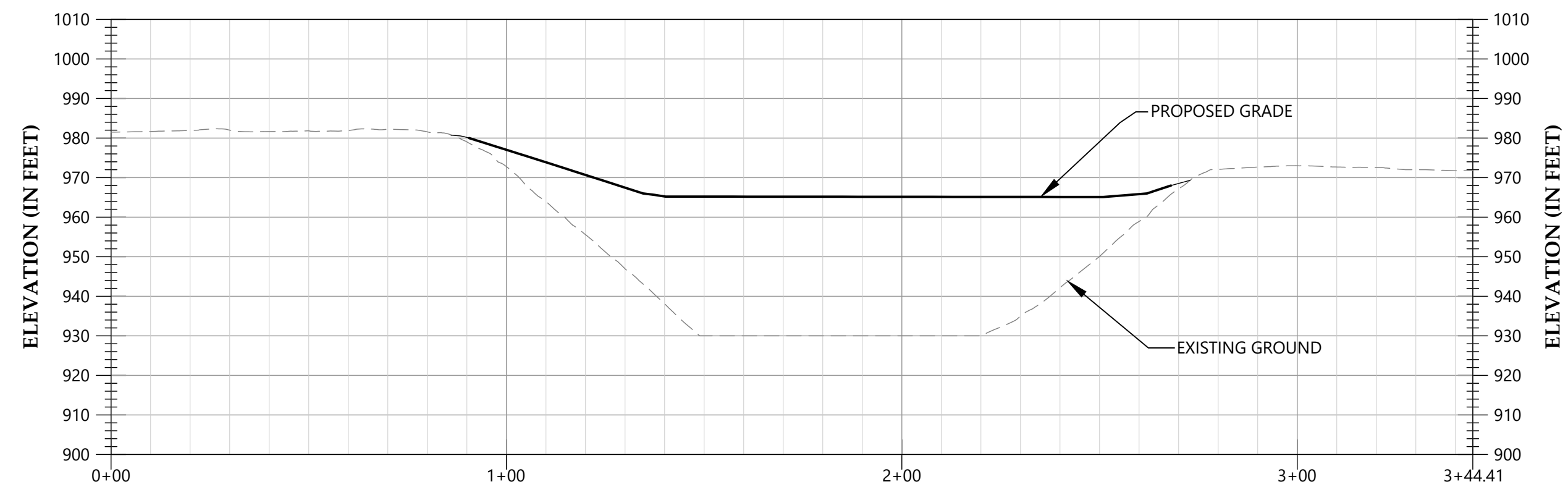

C  
6 | 10 PROFILE C-C'

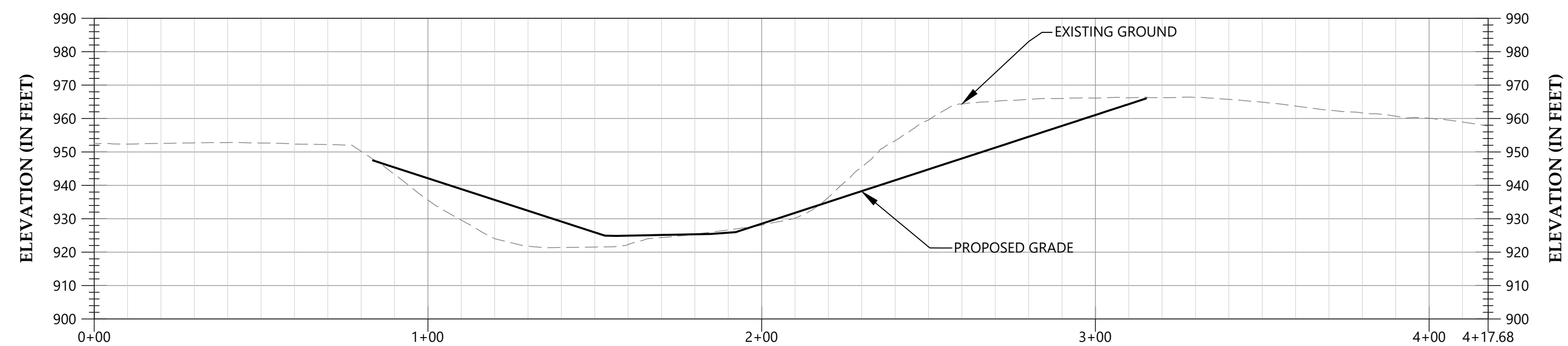

D  
6 | 10 PROFILE D-D'



ACID MINE DRAINAGE  
ABANDONED MINE LAND PROGRAM  
ohiodnr.gov/mineral/



GOSLINE H2OHIO AMD  
PERRY COUNTY RECLAMATION PROJECT No. PR-Pk-50  
SECTIONS HIGHWALL BACKFILL AREA

DATE:  
NOVEMBER 22, 2024  
ISSUED FOR BID

DESIGN UNIT  
CAMBRIDGE AMD  
N.R.E. R. WARNER  
P.O. J. CALHOUN

10  
15

DRAWING PATH: T:\Columbus\1170\Projects\2024\24170307\_CDRM\_Gosline Reclamation\_New\_Loc\_Civil\Gen-Env\Project\Detail\2024-11-22\FCDDETAILS.dwg TAB: 11 CONSTRUCTION DETAILS CHANNEL DIVERSION 1 SAVE DATE: 2024-11-22 PAGE SIZE: ARCH (11x17) SHEET D (24.00 x 36.00 inches)

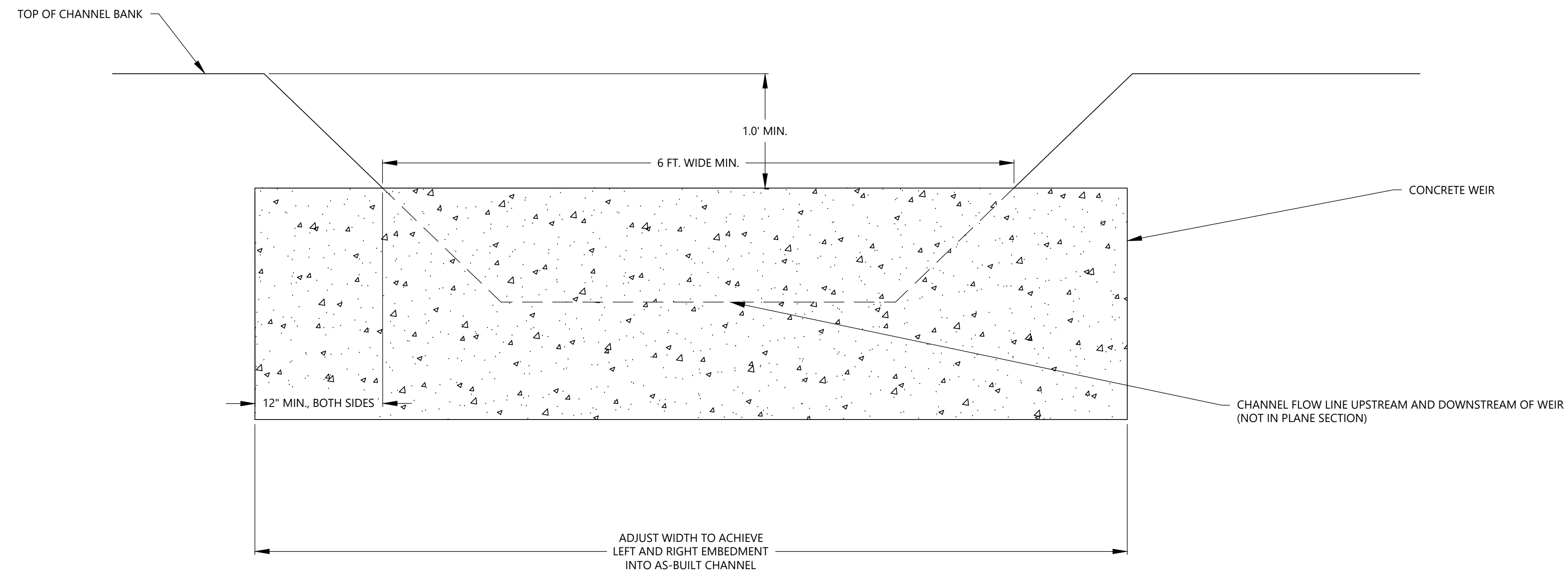

**CONCRETE WEIR - SECTION VIEW**  
NOT TO SCALE

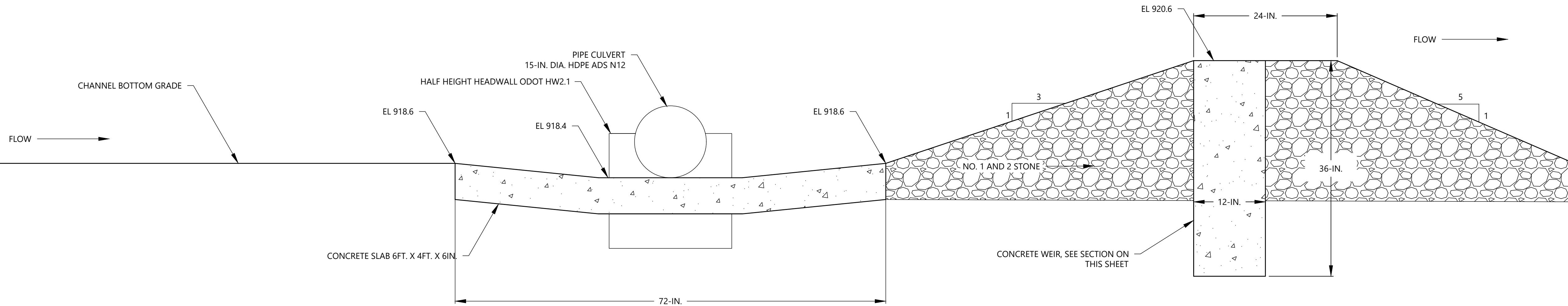

**DIVERSION 1 PROFILE**  
NOT TO SCALE

**HEADWALL NOTES:**

- HEADWALL TO BE IN GENERAL ACCORDANCE WITH ODOT HW-2.1
- PRECAST CONSTRUCTION IS REQUIRED, UNLESS OTHERWISE APPROVED, AND CONCRETE SHALL MEET THE REQUIREMENTS OF ODOT ITEM 706.13 AND ODOT CMS SUPPLEMENT 1073. HARDENED CONCRETE SHALL HAVE MINIMUM OF 4% AIR VOID CONTENT. PRECAST WALLS SHALL HAVE A SUFFICIENT AMOUNT OF REINFORCEMENT TO PERMIT SHIPPING AND PLACEMENT WITHOUT DAMAGE
- USE NONSHRINK GROUT AROUND PIPE TO SEAL BETWEEN PIPE AND HEADWALL.

**WEIR AND SLAB NOTES:**

- CONCRETE CAN BE PRE-CAST OR CAST IN-PLACE.
- PRE-CAST CONCRETE SHALL MEET THE REQUIREMENTS OF ODOT ITEM 706.13 AND ODOT CMS SUPPLEMENT 1073.
- CAST IN-PLACE CONCRETE SHALL MEET THE REQUIREMENTS OF ODOT ITEMS 451 AND 499 FOR NON-REINFORCED CONCRETE CLASS QC 1 WITH AN ENTRAINED AIR-CONTENT OF 7% +/- 2%.



**ACID MINE DRAINAGE  
ABANDONED MINE LAND PROGRAM**  
ohiodnr.gov/mineral/

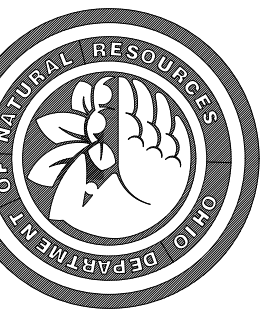

**GOSLINE H2OHIO AMD**  
PERRY COUNTY RECLAMATION PROJECT No. PR-Pk-50  
**CONSTRUCTION DETAILS CHANNEL DIVERSION 1**

DATE: **NOVEMBER 22, 2024**  
ISSUED FOR BID

REVISIONS

DESIGN UNIT  
**CAMBRIDGE AMD**  
N.R.# **R. WARNER**  
N.R.E. ---  
P.O. **J. CALHOUN**

- TRENCH UNDERDRAIN NOTES:**
1. IDENTIFY PROBLEM SEEPAGE AREAS WITH DIVISION APPROVAL.
  2. EXCAVATE TRENCH TO DEPTH AS DIRECTED BY DIVISION.
  3. LINE EXCAVATION WITH FILTER FABRIC.
  4. INSTALL PIPE TO DRAIN TOWARD OUTLET.

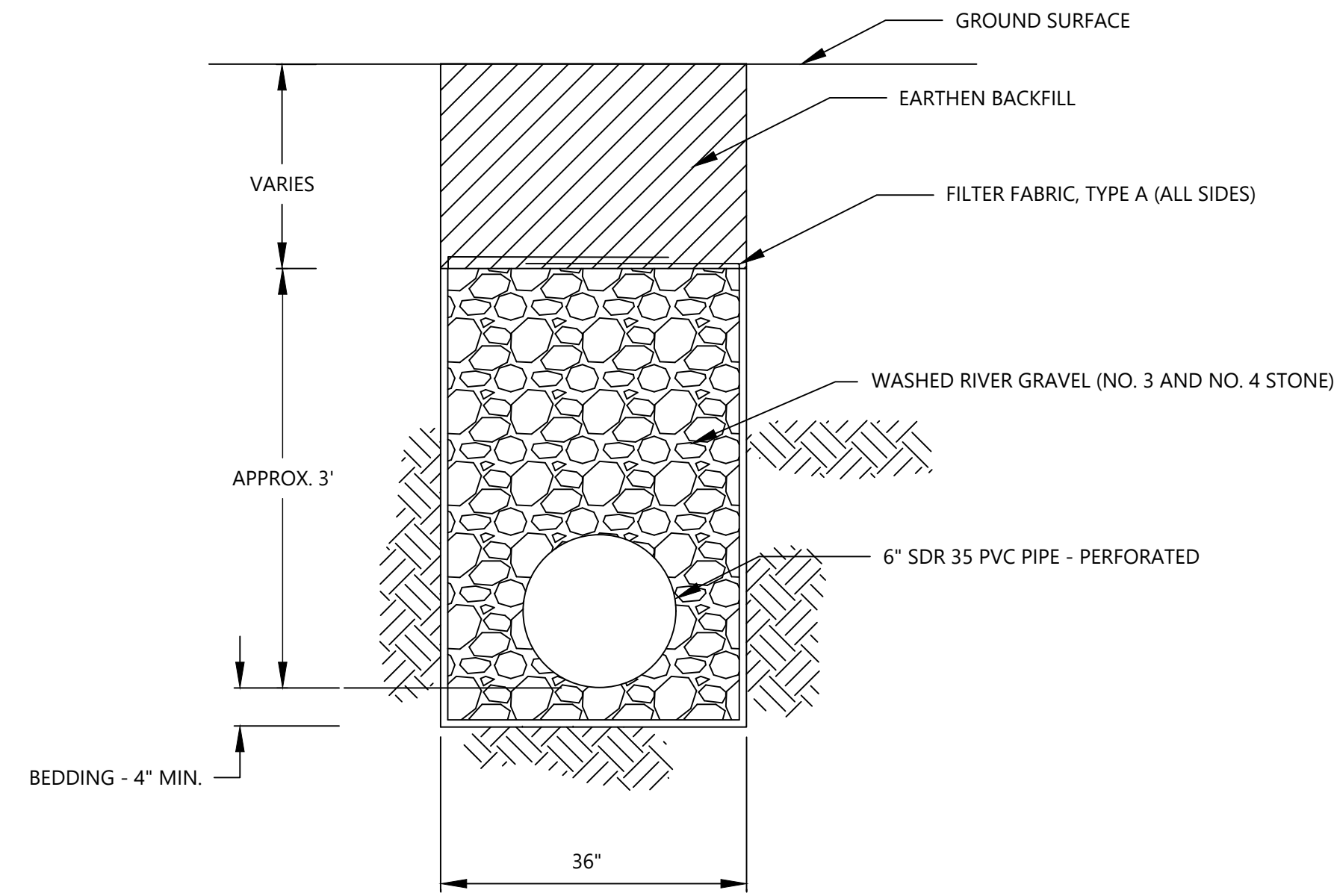

**TRENCH UNDERDRAIN, TYPICAL SECTION**  
NOT TO SCALE

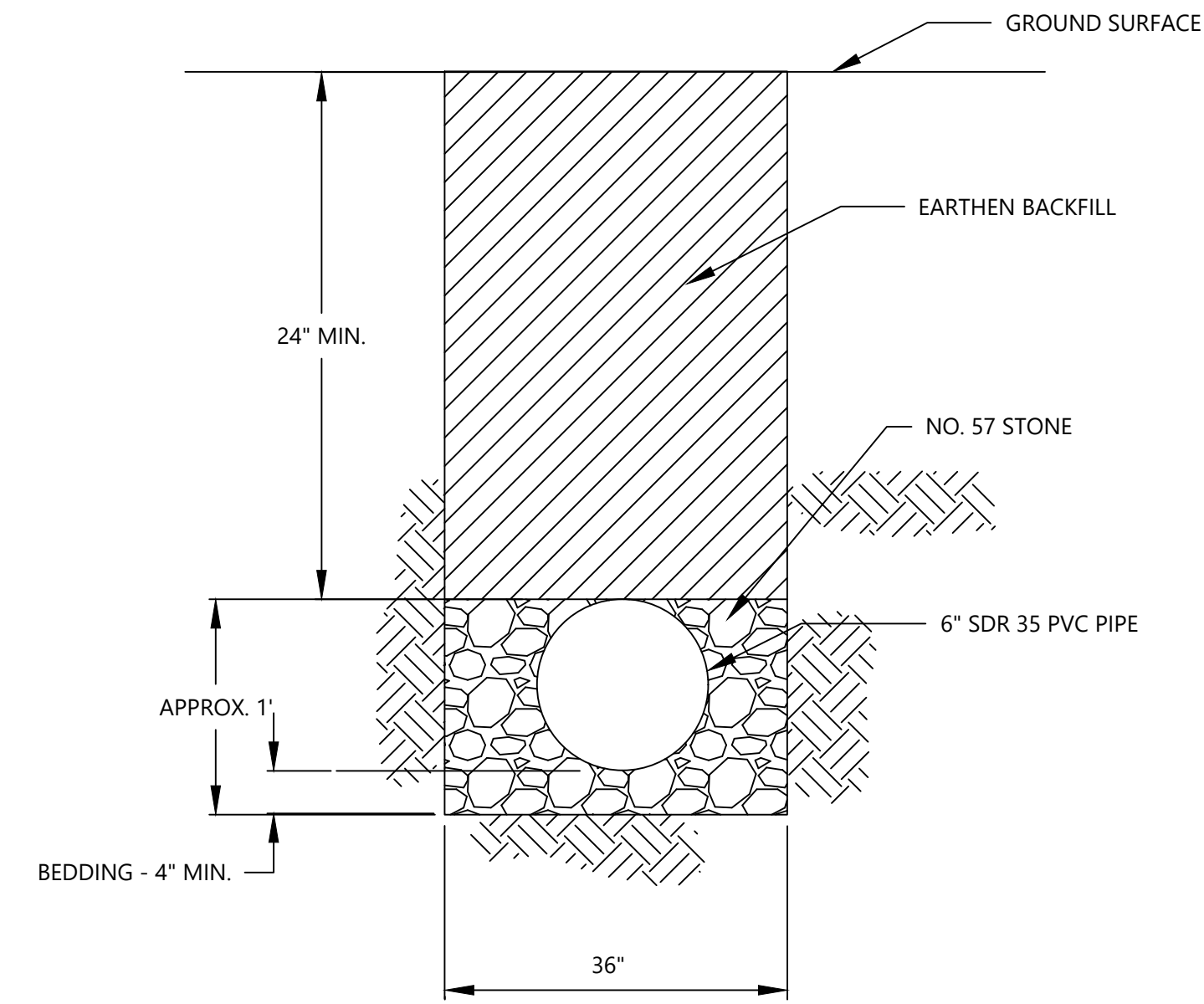

**OUTLET PIPE BURIAL, TYPICAL SECTION**  
NOT TO SCALE

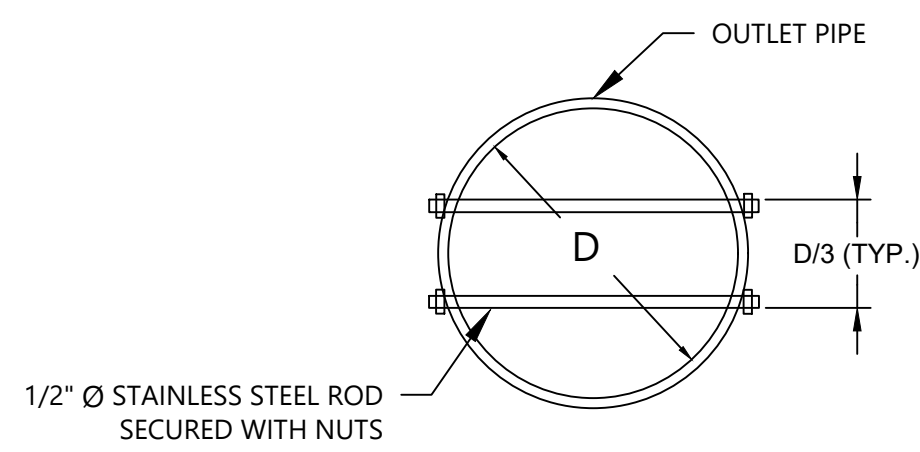

**ANIMAL GUARD**  
NOT TO SCALE

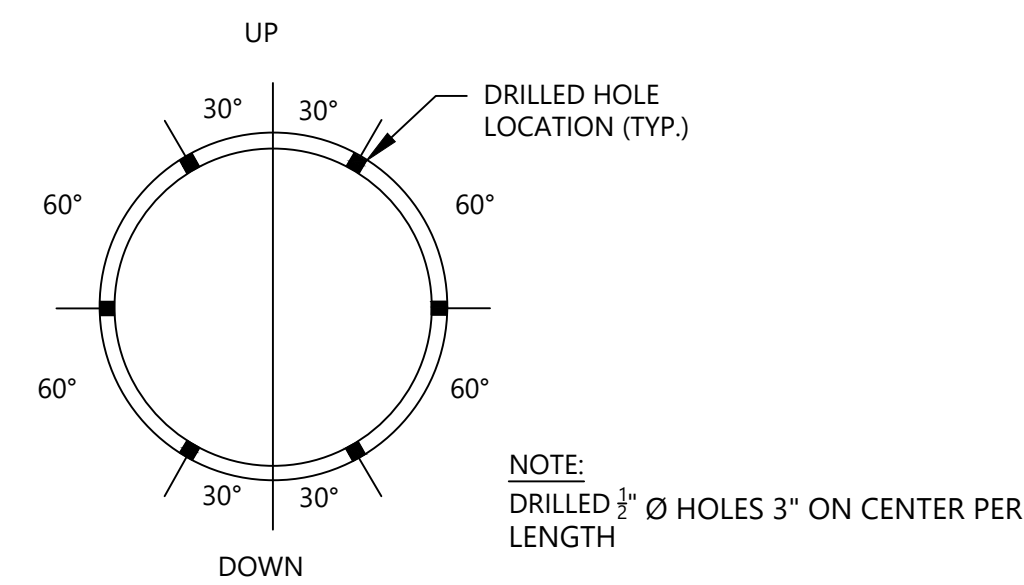

**GASKETED SDR 35 UNDERDRAIN PIPE PERFORATION**  
NOT TO SCALE

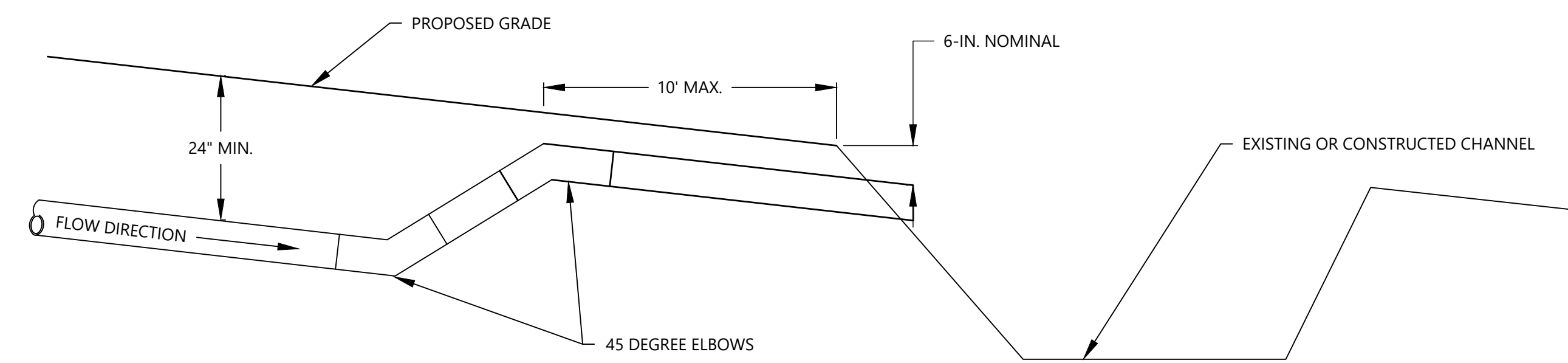

**OUTLET PIPE, PROFILE AT DISCHARGE**  
NOT TO SCALE

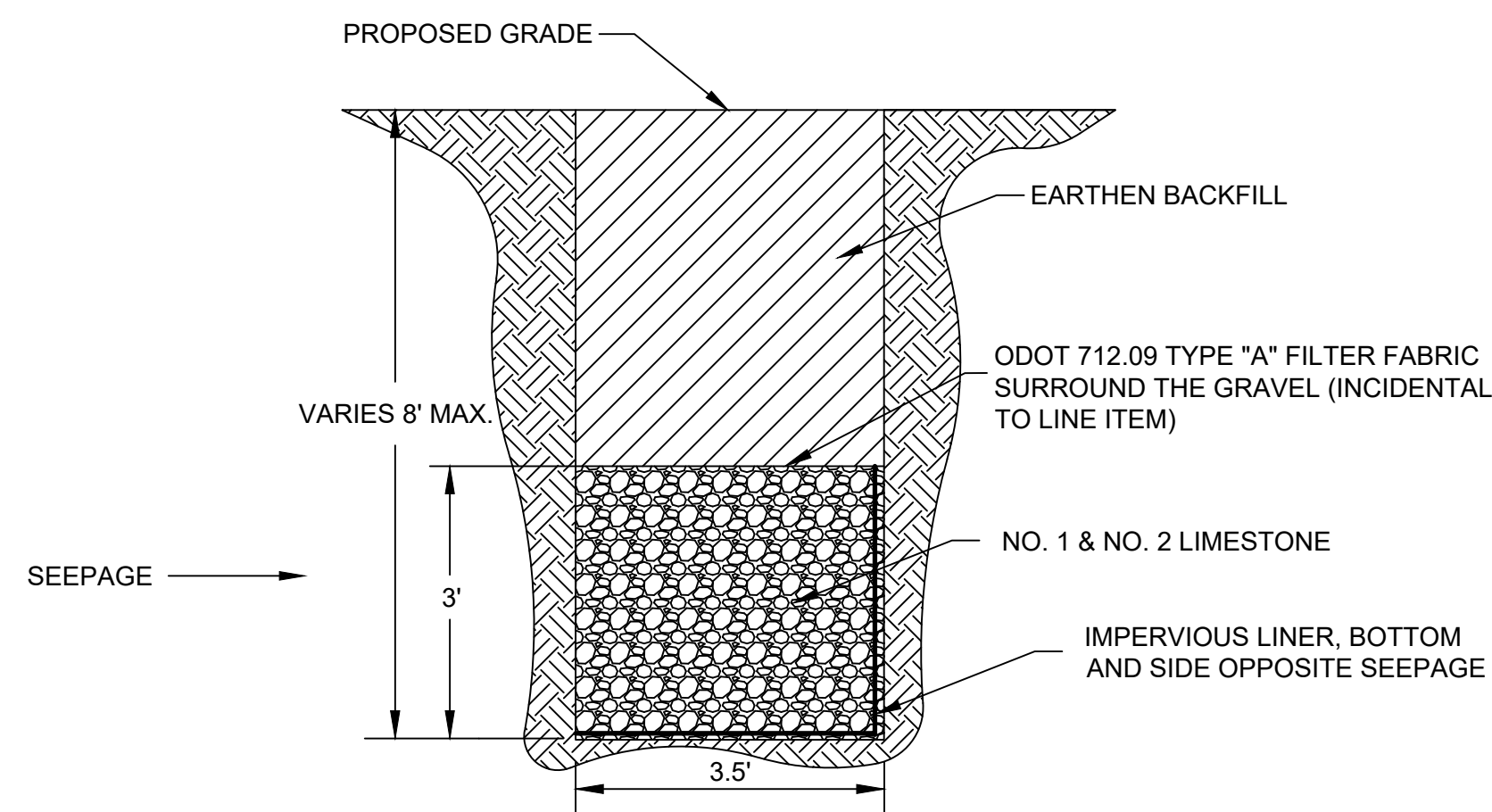

**AGGREGATE DRAIN TYPICAL SECTION**  
NOT TO SCALE

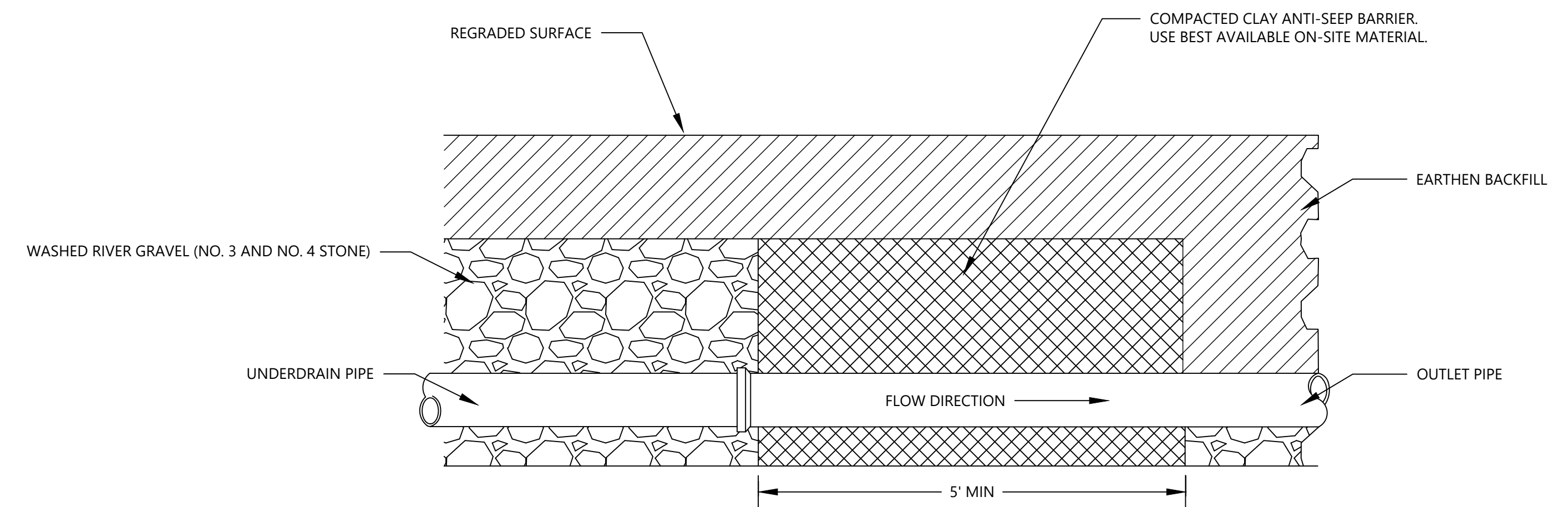

**COMPACTED CLAY ANTI-SEEP BARRIER**  
NOT TO SCALE

DRAWING PATH: T:\Columbus\1170\Projects\52024\1170307\_CDRM\_Gosline Reclamation\_New\_Loc\_Civil\Civil\_Gen-Env\Project\Detail\52024-11-22\_IFCDDETAILS.dwg TAB: 12 CONSTRUCTION DETAILS UNDERDRAINS SAVE DATE: 2024-11-22 PAGE SIZE: ARCH Full bleed D (24.00 x 36.00 inches)



**ACID MINE DRAINAGE  
ABANDONED MINE LAND PROGRAM**  
ohio.dnr.gov/mineral/

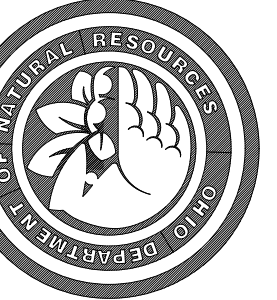

**GOSLINE H2OHIO AMD**  
PERRY COUNTY RECLAMATION PROJECT No. PR-Pk-50  
**CONSTRUCTION DETAILS UNDERDRAINS**

DATE: NOVEMBER 22, 2024  
ISSUED FOR BID  
REVISIONS  
DESIGN UNIT: CAMBRIDGE AMD  
N.R.E.: R. WARNER  
P.O.: J. CALHOUN

DRAWING PATH: T:\Columbus\11700\Projects\2024\24170007\_CDRM\_Gosline Reclamation\_New\_Loc\_Civil\Civil\_Geo-Env\Project\Detail\2024-11-22\FCDDETAILS.dwg TAB: 13 CONSTRUCTION DETAILS.MISC SAVE DATE: 2024-11-22 PAGE SIZE: ARCH (11 bleed D (64.00 x 36.00 inches))

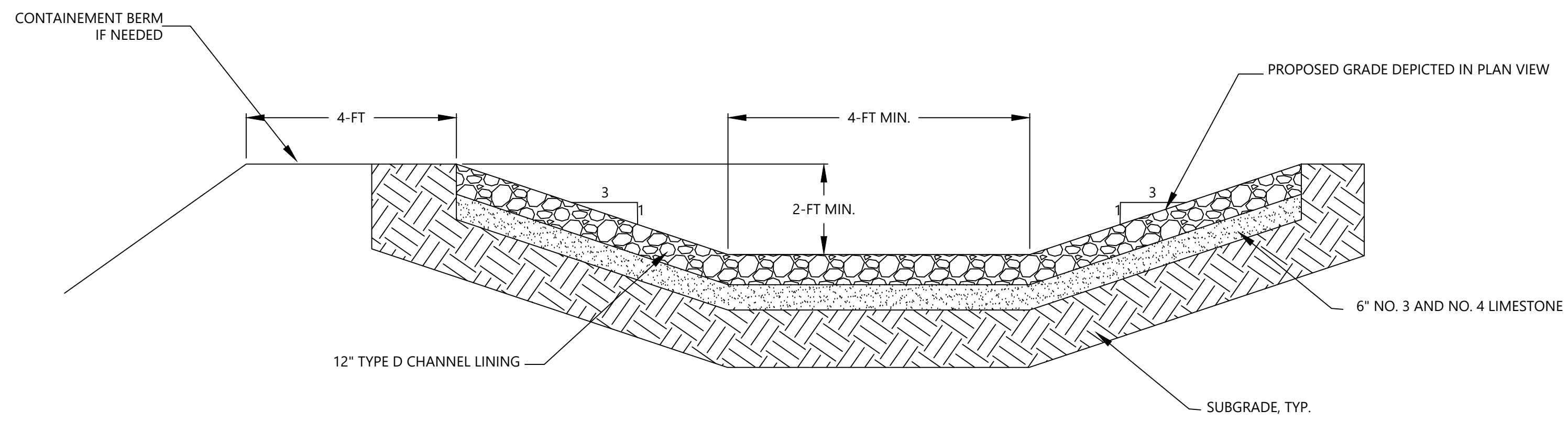

LIMESTONE LINED CHANNEL TYPE 1  
NOT TO SCALE

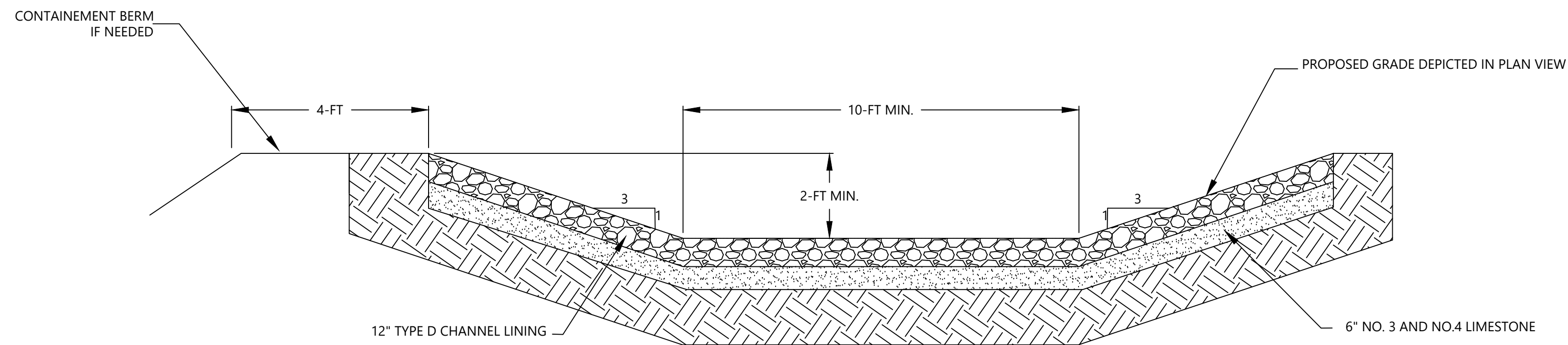

LIMESTONE LINED CHANNEL TYPE 2  
NOT TO SCALE

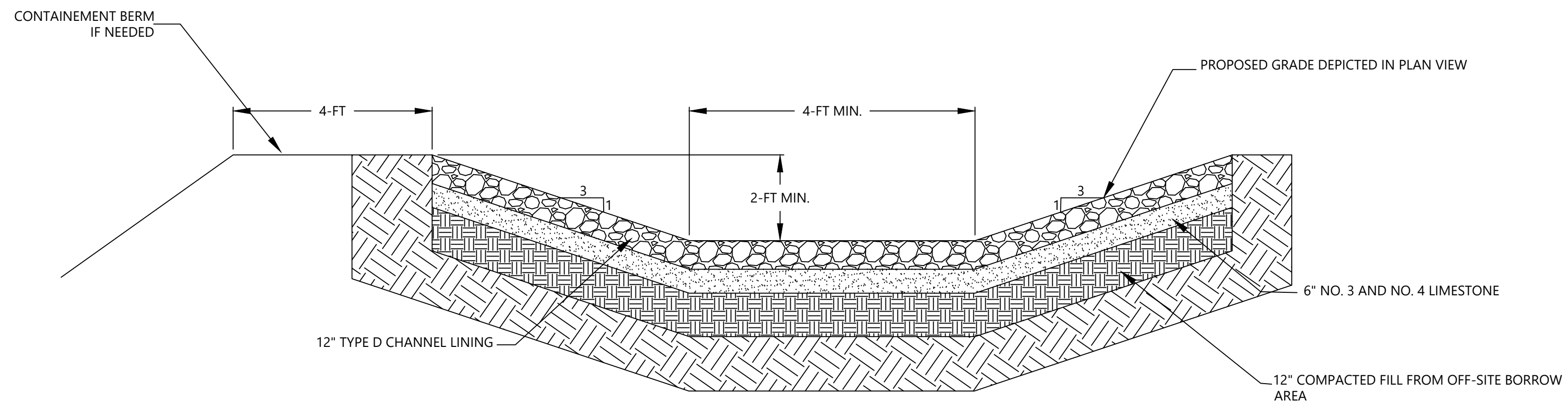

LIMESTONE LINED CHANNEL TYPE 3  
NOT TO SCALE

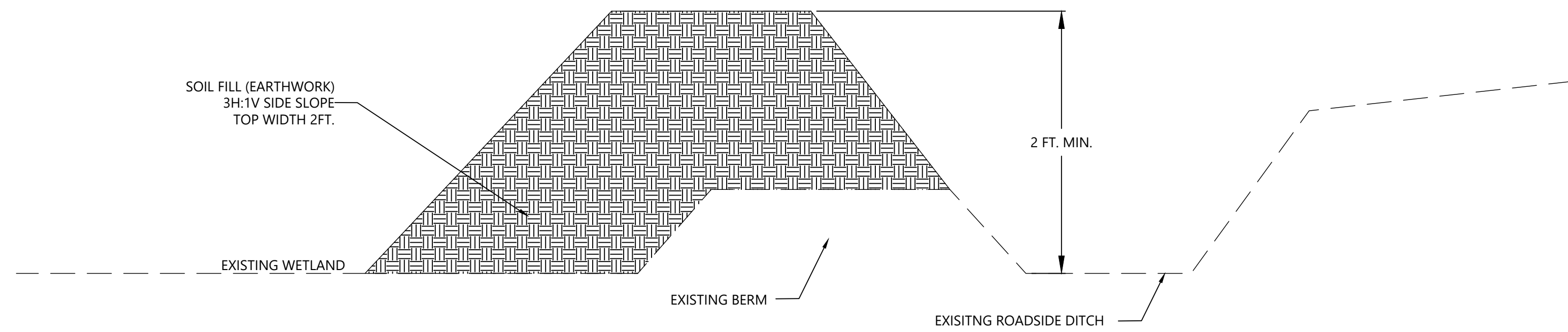

WETLAND CONTAINMENT BERM, TYPICAL SECTION  
NOT TO SCALE

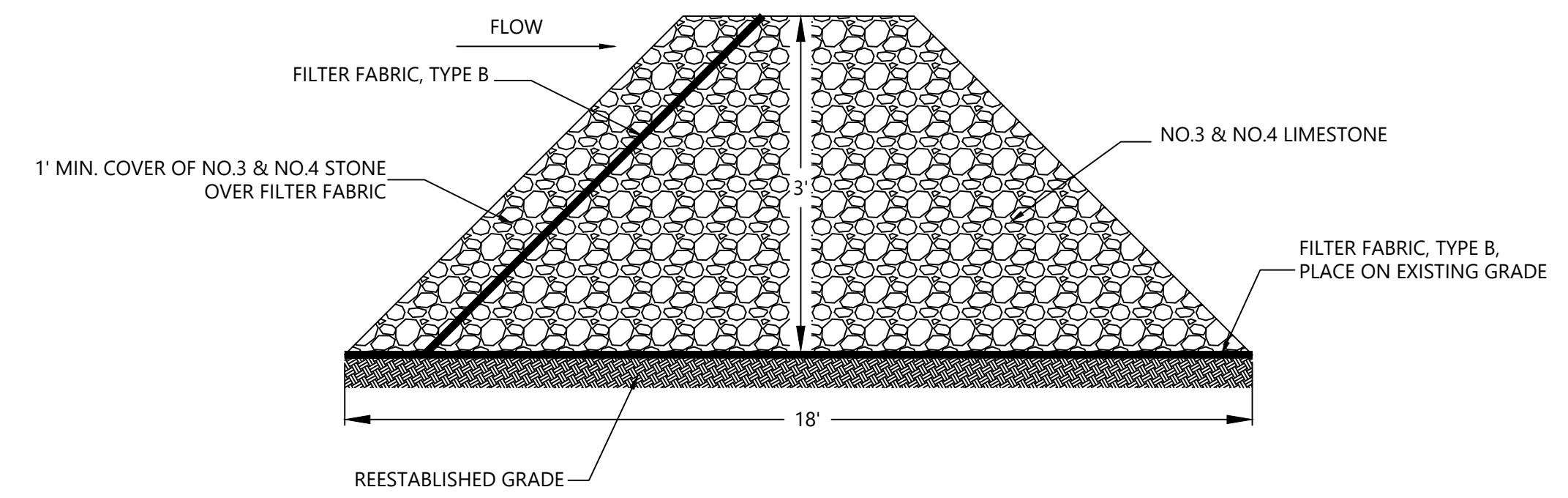

WETLAND ROCK BERMS  
TYPICAL SECTION  
NOT TO SCALE



ACID MINE DRAINAGE  
ABANDONED MINE LAND PROGRAM  
ohiodnr.gov/mineral/



GOSLINE H2OHIO AMD  
PERRY COUNTY RECLAMATION PROJECT No. PR-Pk-50  
CONSTRUCTION DETAILS MISC

DATE: NOVEMBER 22, 2024  
ISSUED FOR BID  
REVISIONS  
DESIGN UNIT: CAMBRIDGE AMD  
N.R.E.: R. WARNER  
P.O.: J. CALHOUN

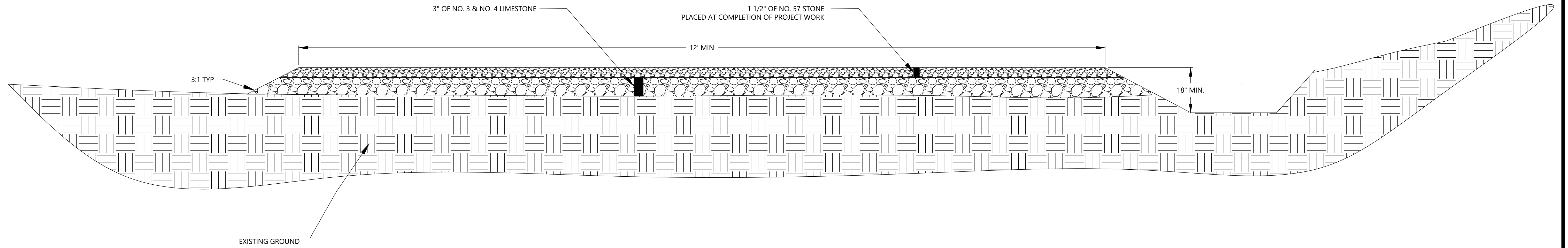

ACCESS ROAD TO REMAIN  
 TYPICAL SECTION  
 NOT TO SCALE



ACID MINE DRAINAGE  
 ABANDONED MINE LAND PROGRAM  
 ohio.dnr.gov/mineral/



GOSLINE H2OHIO AMD  
 PERRY COUNTY RECLAMATION PROJECT No. PR-Pk-50  
 CONSTRUCTION DETAILS MISC

DATE: NOVEMBER 22, 2024  
 ISSUED FOR BID

REVISIONS

DESIGN UNIT  
 CAMBRIDGE AMD  
 N.R.E. R. WARNER  
 N.R.E. ---  
 P.O. J. CALHOUN

DRAWING PATH: T:\Columbus\1170\Projects\2024\24170307\_CDRM\_Cosaline Reclamation, New, Inc\Civil\Gen-Env\Project\Detail\2024-11-22\FCDDETAILS.dwg TAB: 15 CONSTRUCTION DETAILS E&S CONTROLS SAVE DATE: 2024-11-22 PAGE SIZE: ARCH (full bleed) D (24.00 x 36.00 inches)

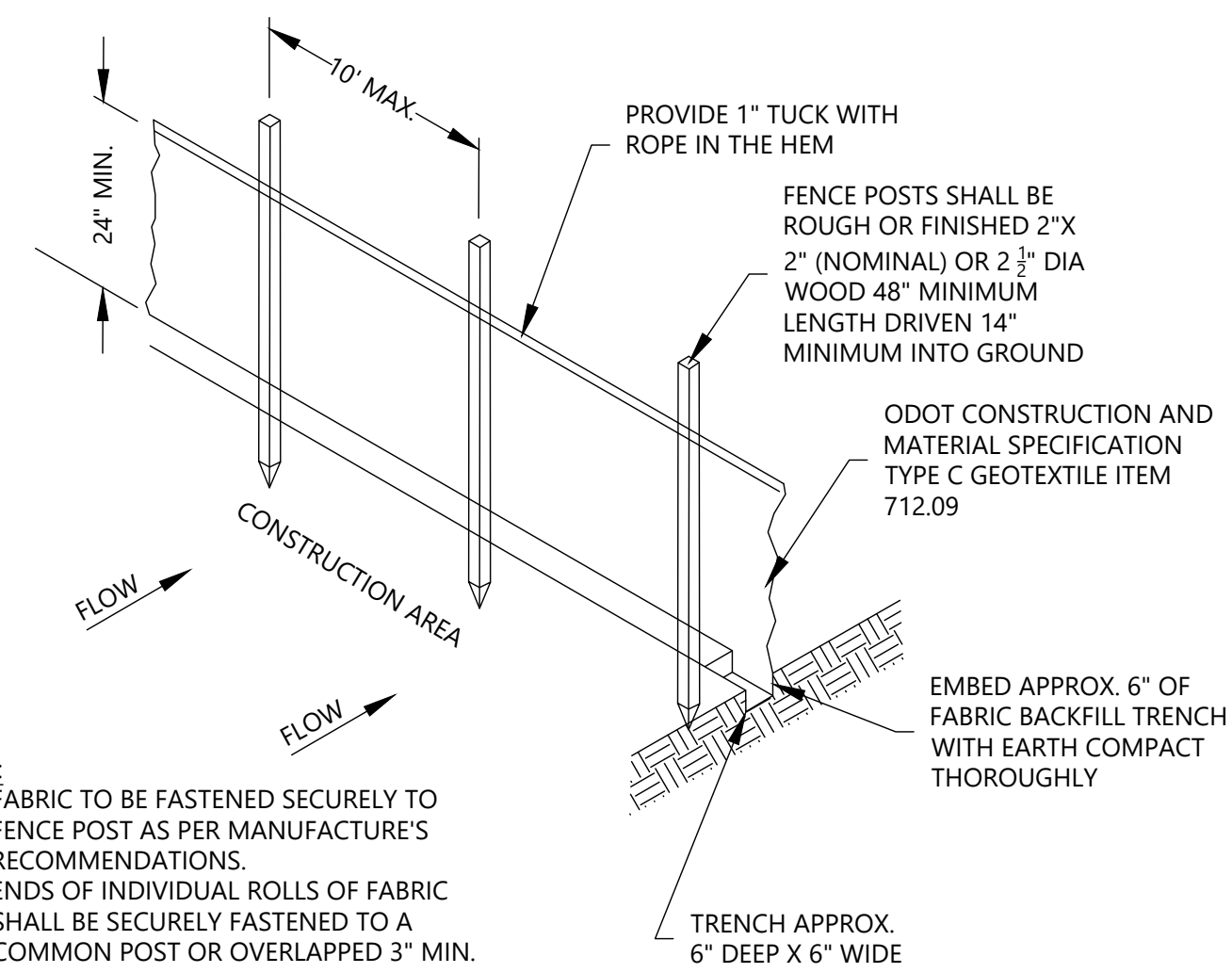

- NOTES:**
- FABRIC TO BE FASTENED SECURELY TO FENCE POST AS PER MANUFACTURER'S RECOMMENDATIONS.
  - ENDS OF INDIVIDUAL ROLLS OF FABRIC SHALL BE SECURELY FASTENED TO A COMMON POST OR OVERLAPPED 3" MIN.

**SILT FENCE DETAIL**  
NOT TO SCALE

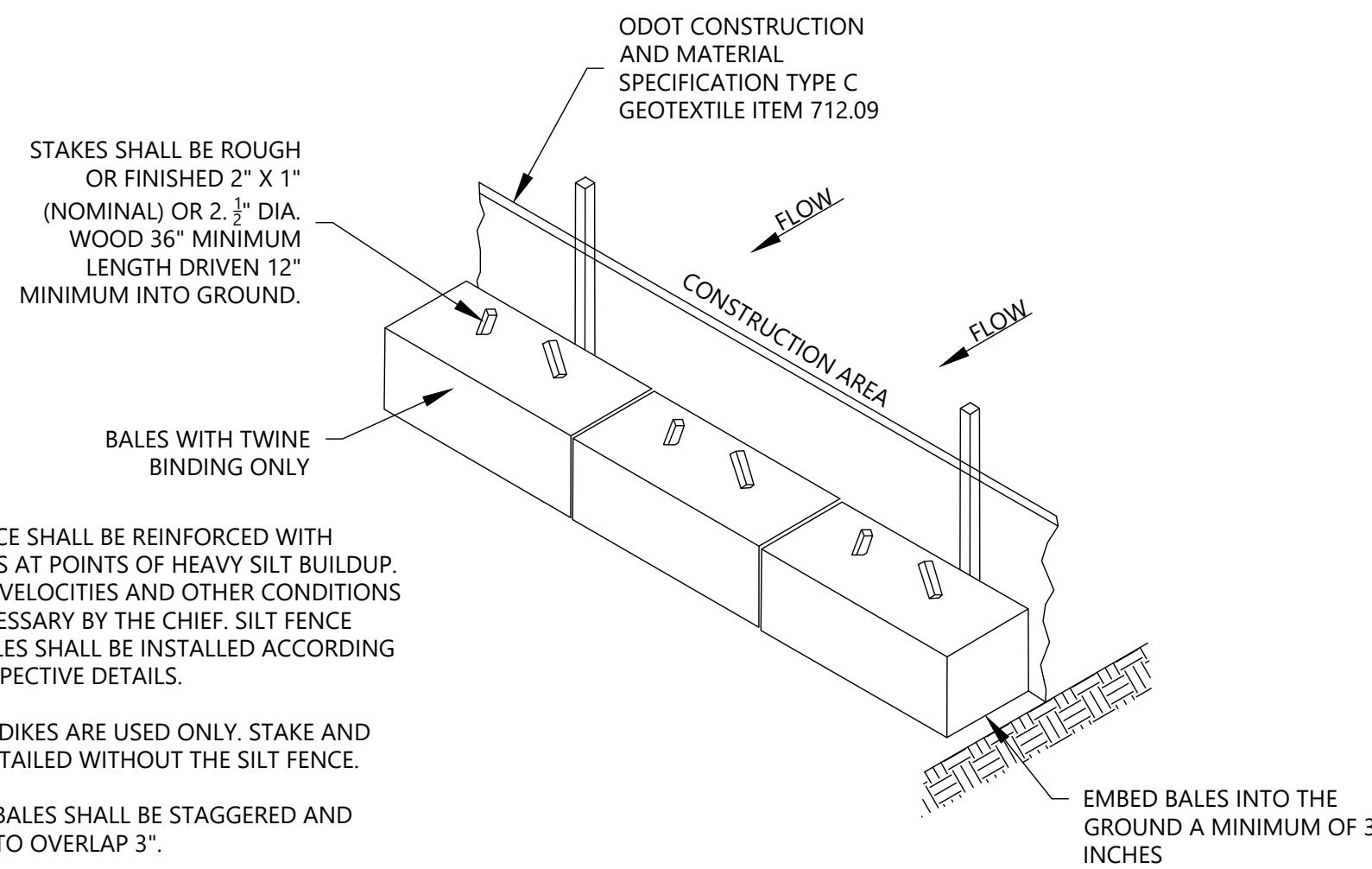

- NOTES:**
- THE SILT FENCE SHALL BE REINFORCED WITH STAKED BALES AT POINTS OF HEAVY SILT BUILDUP, HIGH WATER VELOCITIES AND OTHER CONDITIONS DEEMED NECESSARY BY THE CHIEF. SILT FENCE AND HAY BALES SHALL BE INSTALLED ACCORDING TO THEIR RESPECTIVE DETAILS.
- WHERE BALE DIKES ARE USED ONLY, STAKE AND EMBED AS DETAILED WITHOUT THE SILT FENCE.
- THE CENTER BALES SHALL BE STAGGERED AND POSITIONED TO OVERLAP 3".

**SILT FENCE WITH BALE BACKUP DETAIL**  
NOT TO SCALE

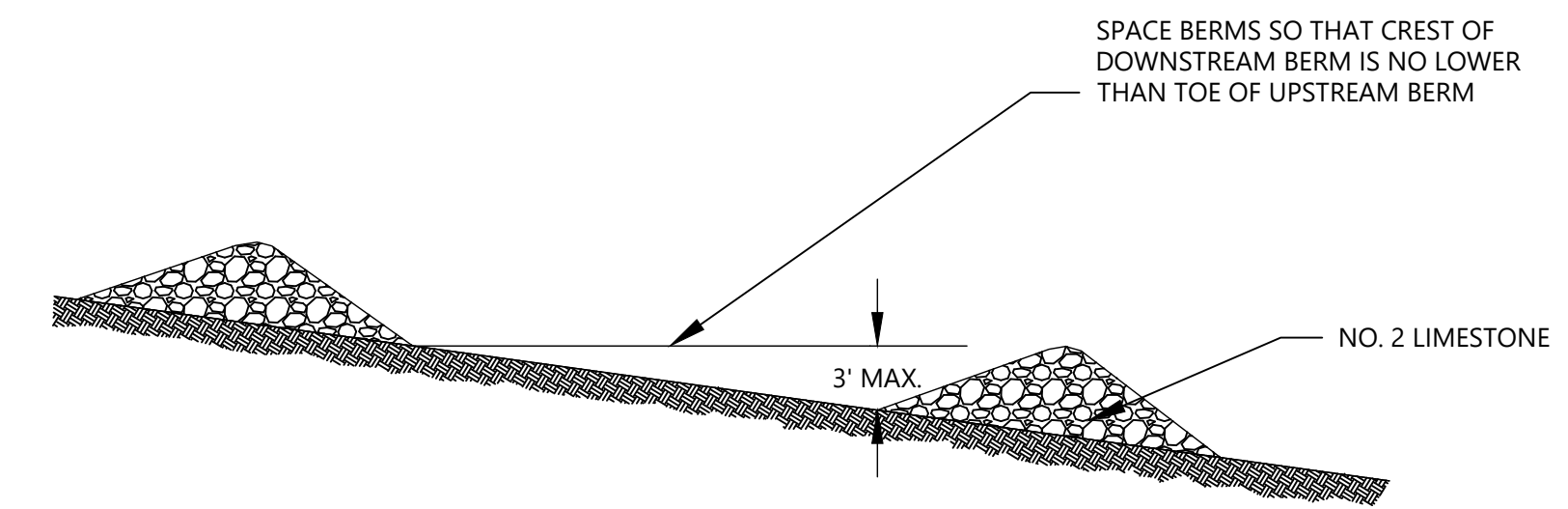

**PROFILE, TYP.**

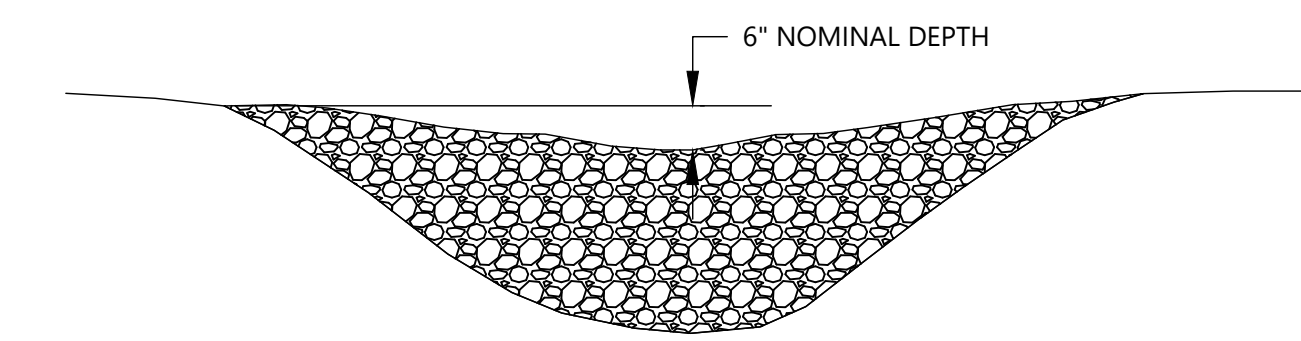

**SECTION, TYP.**

**ROCK CHECK DAM**  
NOT TO SCALE

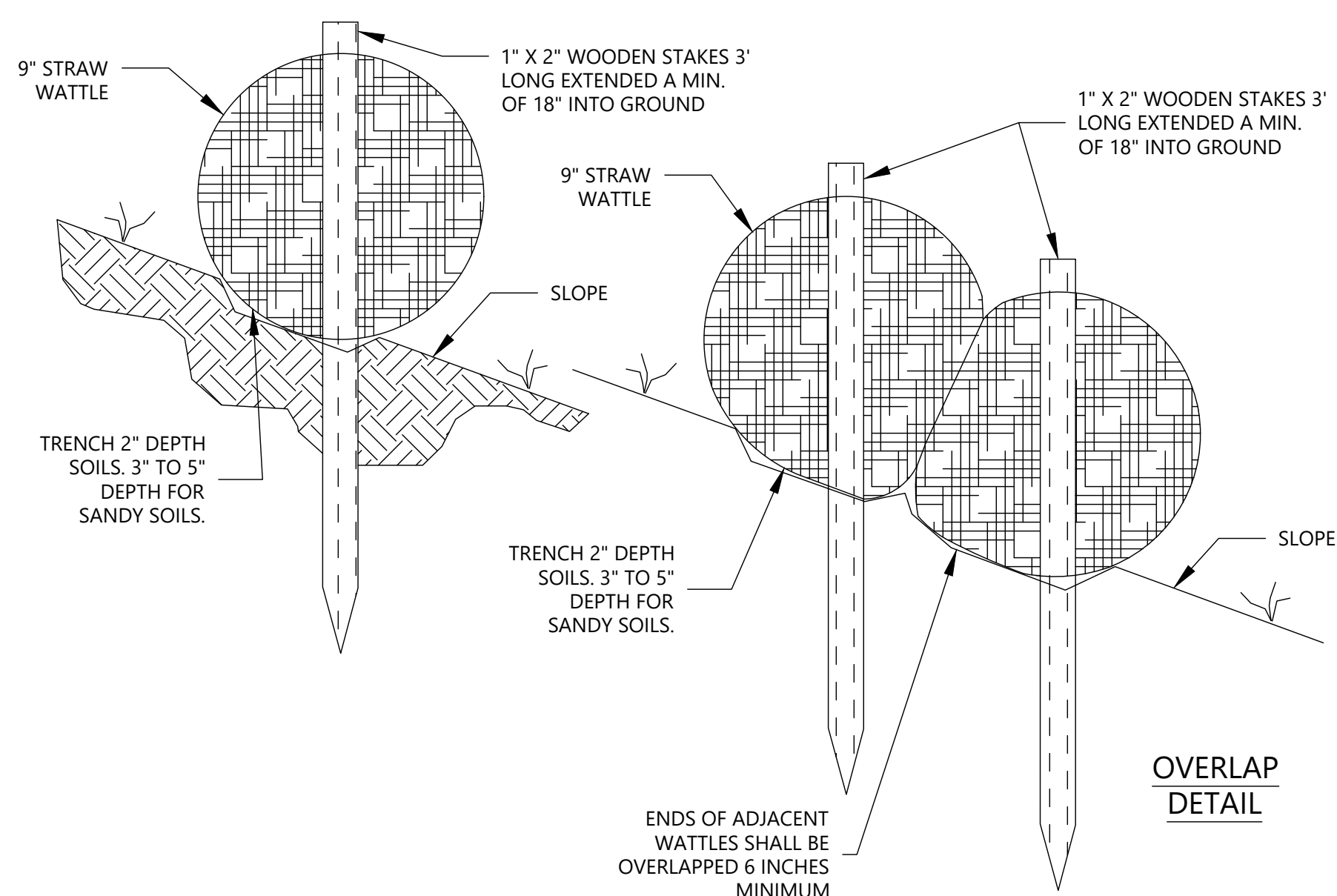

**STRAW WATTLE DETAIL**  
NOT TO SCALE

**STRAW WATTLE NOTES:**  
DURING STORAGE, WATTLES SHALL BE ELEVATED OFF OF GROUND AND ADEQUATELY COVERED TO PROTECT THEM FROM FOLLOWING: SITE CONSTRUCTION DAMAGE, PRECIPITATION, EXTENDED ULTRAVIOLET RADIATION INCLUDING SUNLIGHT, CHEMICALS THAT ARE STRONG ACIDS OR STRONG BASES, FLAMES INCLUDING WELDING SPARKS, EXCESS TEMPERATURES, AND ANY OTHER ENVIRONMENTAL CONDITIONS THAT MAY DAMAGE PHYSICAL PROPERTY VALUES OF ROLLS.

PROPER SITE PREPARATION IS ESSENTIAL TO ENSURE COMPLETE CONTACT OF STRAW WATTLE WITH SOIL. ALL TRENCH WORK AND CLEARING OF OBSTRUCTIONS SHALL BE COMPLETED PRIOR TO INSTALLATION OF STRAW WATTLES.

STRAW WATTLE ROWS SHALL BE PLACED HORIZONTALLY, AT LOCATIONS INDICATED AND IN WARRANTED LOCATIONS AS DETERMINED BY THE DIVISION DURING CONSTRUCTION TO CONTROL SEDIMENT AND EROSION.

A SMALL TRENCH SHALL BE EXCAVATED ALONG SLOPE CONTOUR AND PERPENDICULAR TO WATER FLOW. DURING THIS EXCAVATION, REMOVE ALL ROCKS, CLODS, VEGETATION OR OTHER OBSTRUCTIONS SO THAT INSTALLED WATTLES WILL HAVE DIRECT CONTACT WITH SOIL. SOIL FROM EXCAVATION SHALL BE PLACED AND COMPACTED UPSLOPE NEXT TO TRENCH. FOR SANDY SOILS DIG A 3 INCH TO 5 INCH DEEP TRENCH. FOR DENSE SOILS, DIG A 2 INCH DEEP TRENCH.

PLACE WATTLES IN TRENCH, ENSURING THAT NO GAPS EXIST BETWEEN SOIL AND BOTTOM OF WATTLE FOR CONTINUOUS ROWS. STRAW WATTLES SHALL BE OVERLAPPED ENDS OF ADJACENT WATTLES SHALL BE OVERLAPPED 6-INCH MINIMUM TO PREVENT SEDIMENT PASSING THROUGH FIELD JOINT.

WOODEN STAKES SHALL BE USED TO HOLD WATTLES IN PLACE. WHEN CONDITIONS WARRANT A STRAIGHT METAL BAR CAN BE USED TO DRIVE A PILOT HOLE THROUGH WATTLE AND INTO SOIL. WHEN STRAW WATTLES ARE USED ON FLAT GROUND, DRIVE STAKES IN VERTICALLY; WHEN USED ON SLOPES, DRIVE STAKES AT AN ANGLE TOWARDS UPHILL SIDE OF SLOPE.

WOODEN STAKES BE PLACED WITHIN 1-FOOT FROM WATTLE END ANGLED TOWARDS ADJACENT WATTLE AND SUBSEQUENT STAKES SHALL BE SPACED AT AN INTERVAL OF 4-FEET LEAVING STAKE EXPOSED ABOVE WATTLE. ALTERNATIVELY, STAKES MAY BE PLACED ON EACH SIDE OF WATTLE TYING ACROSS WITH A NATURAL FIBER TWINE OR STAKING IN A CROSSING MANNER ENSURING DIRECT SOIL CONTACT AT ALL TIMES.

TERMINAL ENDS OF WATTLES MAY BE TURNED UP TO SLOPE TO ENSURE CONTAINMENT AND PREVENT CHANNELING OD SEDIMENTATION.

CARE SHALL BE TAKEN DURING INSTALLATION TO AVOID DAMAGE OCCURRING TO WATTLE AS A RESULT OF INSTALLATION PROCESS. SHOULD WATTLE BE DAMAGED DURING INSTALLATION, A WOODEN STAKE SHALL BE PLACED ON EACH SIDE OF DAMAGED AREA OF LOG SEGMENT.

INSPECTIONS OF WATTLE SHALL BE CONDUCTED BY CONTRACTOR PERIODICALLY AND AFTER SIGNIFICANT RAINFALL EVENTS. INSPECTIONS OF WATTLES SHALL BE CONDUCTED BY CONTRACTOR PERIODICALLY AND AFTER SIGNIFICANT RAINFALL EVENTS. DAMAGED STRUCTURES MUST BE REPAIRED IMMEDIATELY. RILLS OR GULLIES UPSLOPE OF WATTLE AND ANY UNDERCUTTING SHALL BE REPAIRED ACCUMULATED SILT SHALL BE REMOVED WHEN IT, IN THE DIVISION'S OPINION, MAY DAMAGE OR REDUCE WATTLE'S EFFECTIVENESS.

SEDIMENT DEPOSITS THAT IMPAIR FILTRATION CAPABILITY OF WATTLE SHALL BE REMOVED WHEN SEDIMENT REACHES 40% OF WATTLE'S FUNCTIONAL HEIGHT. REMOVED SEDIMENT SHALL BE DEPOSITED WITHIN PROJECT IN SUCH A WAY THAT SEDIMENT IS NOT SUBJECT TO EROSION BY WIND OR WATER, OR AS DIRECTED BY THE DIVISION'S PROJECT REPRESENTATIVE.

WHEN NO LONGER REQUIRED FOR INTENDED PURPOSE, AS DETERMINED BY THE DIVISION, STRAW WATTLES SHALL BE REMOVED FROM SITE OR WOODEN STAKES SHALL BE REMOVED AND A SLIT MADE LENGTHWISE IN STRAW WATTLE ALLOWING STRAW ON INSIDE TO SPILL OUT TRENCHES DEPRESSIONS OR ANY OTHER GROUND DISTURBANCES CAUSED BY REMOVAL OF STRAW WATTLES SHALL BE BACKFILLED AND REPAIRED, SEEDED AND MULCHED.

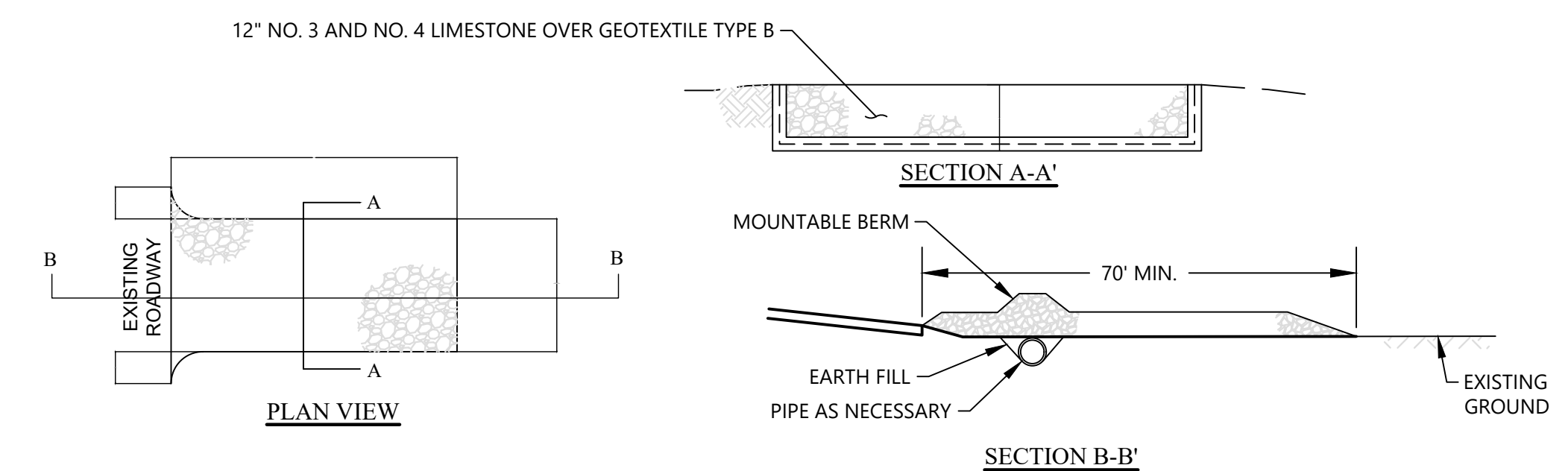

REMOVE TOPSOIL PRIOR TO INSTALLATION OF ROCK CONSTRUCTION ENTRANCE. EXTEND ROCK OVER FULL WIDTH OF ENTRANCE.

RUNOFF SHALL BE DIVERTED FROM ROADWAY TO A SUITABLE REMOVAL BMP PRIOR TO ENTERING ROCK CONSTRUCTION ENTRANCE.

MOUNTABLE BERM SHALL BE INSTALLED WHEREVER OPTIONAL CULVERT PIPE IS USED AND PROPER PIPE COVER AS SPECIFIED BY MANUFACTURER IS NOT OTHERWISE PROVIDED. PIPE SHALL BE SIZED APPROPRIATELY FOR SIZE OF DITCH BEING CROSSED.

MAINTENANCE: ROCK CONSTRUCTION ENTRANCE THICKNESS SHALL BE CONSTANTLY MAINTAINED TO THE SPECIFIED DIMENSIONS BY ADDING ROCK. A STOCKPILE SHALL BE MAINTAINED ON SITE FOR THIS PURPOSE. ALL SEDIMENT DEPOSITS ON PAVED ROADWAYS SHALL BE REMOVED AND RETURNED TO THE CONSTRUCTION SITE IMMEDIATELY. IF EXCESSIVE AMOUNTS OF SEDIMENT ARE BEING DEPOSITED ON ROADWAY, EXTEND LENGTH OF ROCK CONSTRUCTION ENTRANCE BY 50 FOOT INCREMENTS UNTIL CONDITION IS ALLEVIATED OR INSTALL WASH RACK. WASHING THE ROADWAY OR SWEEPING THE DEPOSITS INTO ROADWAY DITCHES, SEWERS, CULVERTS, OR OTHER COURSES IS NOT ACCEPTABLE.

WASHING - WHEELS SHALL BE CLEANED TO REMOVE SEDIMENT PRIOR TO ENTRANCE ONTO PUBLIC RIGHTS-OF-WAY. WHEN WASHING IS REQUIRED, IT SHALL BE DONE ON AN AREA STABILIZED WITH STONE AND WHICH DRAINS INTO AN APPROVED SEDIMENT TRAPPING DEVICE.

**TEMPORARY CONSTRUCTION ENTRANCE**  
NOT TO SCALE

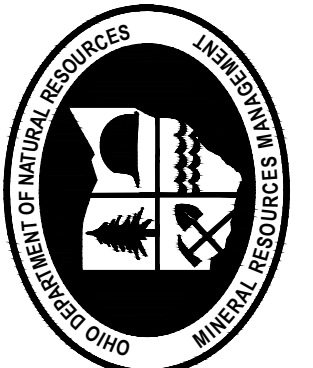

**ACID MINE DRAINAGE  
ABANDONED MINE LAND PROGRAM**



ohiodnr.gov/mineral/

**GOSLINE H2OHIO AMD**  
PERRY COUNTY RECLAMATION PROJECT No. PR-Pk-50  
**CONSTRUCTION DETAILS E&S CONTROLS**

DATE: NOVEMBER 22, 2024  
ISSUED FOR BID

REVISIONS

DESIGN UNIT  
CAMBRIDGE AMD  
N.R.# R. WARNER  
N.R. ---  
P.O. J. CALHOUN

15  
15