

ASBESTOS CONTAINING MATERIALS INSPECTION REPORT

***8895 Gaysport Hill Road Property Demolition
Blue Rock, Ohio 43720***

(L&A Project #: 24-0310)



Prepared for:

***Mr. Greg Vriezelaar
West Erie Realty Solutions
323 Lafayette Street
Toledo, Ohio 43604
(614) 214-3743***

Prepared by:

***Lawhon & Associates, Inc.
1441 King Avenue
Columbus, Ohio 43212
(614) 481-8600***

August 29, 2024



Table of Contents

Section 1.0	Introduction	Page 2
Section 2.0	Asbestos Containing Materials	Pages 2 - 3
	Section 2.1 Methodology	
Section 3.0	Asbestos Containing Materials Results	Pages 3 - 6
	Section 3.1 Confirmed Asbestos Containing Materials	
	Section 3.2 Assumed Asbestos Containing Materials	
	Section 3.3 Materials Containing 1% or Less Asbestos	
	Section 3.4 Non-Asbestos Containing Materials	
Section 4.0	Conclusions	Pages 6 - 7
	Section 4.1 Asbestos Containing Materials	
	Section 4.2 Materials Containing 1% or Less Asbestos	

Schedule of Appendices

- A. Inspector's Certifications
- B. Asbestos Bulk Sample Location Diagram
- C. Inventory of Asbestos Containing Materials
- D. Asbestos Bulk Sample Summary
- E. Asbestos Laboratory Analysis Certificates and Chain of Custody

Asbestos Containing Materials Inspection Report
8895 Gaysport Hill Road,
Blue Rock, Ohio 43720

1.0 Introduction

On August 15, 2024, Lawhon & Associates, Inc. (L&A) conducted an asbestos-containing materials (ACMs) inspection of the structures at 8895 Gaysport Hill Road, Blue Rock, Ohio 43720. The assessment was conducted by Mr. Matt Geiger (Ohio Environmental Protection Agency Certified Asbestos Hazard Evaluation Specialist (AHES) #35832) and Mr. Austin Coldren OEPA (AHES #548697) of L&A. The consultant's certifications are attached in **Appendix A**.

The purpose of the assessment was to determine the presence of asbestos containing materials prior to the proposed demolition of the structures on the property. L&A conducted a full building survey of all accessible areas. L&A distinguished two (2) separate structures on the property: a residential dwelling and an outbuilding. For reporting purposes, L&A assigned room name/number designations in the field; these designations can be visually referenced in the Bulk Sample Diagram attached in **Appendix B**. This report conforms to the requirements of the EPA NESHAPs prior to demolition for this project. This report should not be construed as a remediation design or used for bidding purposes.

2.0 Asbestos Containing Materials

Asbestos containing materials are governed the Environmental Protection Agency's (EPA) National Emission Standards of Hazardous Air Pollutants (NESHAP) during a renovation and/or demolition. These materials are defined as containing greater than one percent asbestos. The Occupational Safety and Health Administration (OSHA) govern building materials containing any amount of asbestos.

The Clean Air Act (CAA) of 1970 required the EPA to develop and enforce regulations to protect the general public from exposure to airborne contaminants that are known to be hazardous to human health; therefore, EPA promulgated the National Emission Standards for Hazardous Air Pollutants (NESHAP) (Title 40, CFR Part 61) on April 6, 1973. NESHAP is intended to minimize the release of asbestos fibers during certain activities (i.e., renovations, demolition, and installations). It specifies work practices to be followed during renovations of buildings (except apartment buildings that have no more than four dwelling units), which contain a specific amount of friable asbestos. NESHAP requires that buildings be inspected for asbestos containing building materials (ACBM) prior to renovation/demolition projects.

NESHAP also requires owners and operators subject to the asbestos rules to notify delegated state and local agencies and/or the regional EPA offices before demolition or renovation activities begin. In addition, NESHAP requires the removal of all regulated asbestos containing materials (RACM) prior to demolition. Regulated Asbestos-Containing Materials (RACM) are (a) friable asbestos material, which are materials easily reduced to powder with hand pressure (b) Category I non-friable ACM that has become friable, (c) Category I non-friable ACM that will be or has been subjected to sanding, grinding, cutting, abrading, or broken into pieces smaller than four square inches or (d) Category II non friable ACM that has a high probability of becoming or has become crumbled, pulverized, or reduced to powder by the forces expected to act on the material in the course of demolition or renovation operations. Category I non-friable materials consist of materials such as resilient floor covering products, roofing products, gaskets, and packing. Category II non-friable materials consist of all other non-friable materials such as transite and drywall. NESHAP also requires all ACM (including Category I and II) be removed prior to intentional burning, such as for a fire department training exercise.

The Ohio Environmental Protection Agency (OEPA) regulates asbestos activities within the state. Professionals performing asbestos related activities must be certified/licensed by OEPA.

2.1 Methodology

A list of suspect ACMs was compiled from the investigation of the structures. Materials were categorized into RACM, Category I, and Category II materials. L&A inventoried and procured confirmatory samples of materials that must be removed prior to renovation activities.

Materials suspected of containing asbestos were grouped into homogeneous areas for bulk sampling purposes. A homogeneous area is composed of specific material that appears to be the same in color, texture, date of installation or location (e.g., grey spray-applied fireproofing in a specific construction unit).

The number of bulk samples to be procured for each identified homogeneous area of suspected Surfacing Materials, Thermal System Insulations, and Miscellaneous Materials were determined in accordance with 40 CFR 763.

Specifically, Friable and Nonfriable Surfacing Materials (i.e., fireproofing, acoustical plaster, decorative plaster, hard plaster, and textured coatings) were sampled following the guidelines set forth by the USEPA in the document "Asbestos in Buildings - Simplified Sampling Scheme Friable Surfacing Materials." Based upon the square footage of the homogenous surfacing materials, either a minimum of 3, 5, or 7 bulk samples were randomly procured and analyzed. For Thermal System Insulation (TSI), at least 3 random samples of each homogeneous area of TSI were procured and analyzed and 1 sample of patched TSI if it was <6 linear or square feet. For Miscellaneous Materials (MM), at least 2 random samples of each homogeneous area of MM were procured and analyzed.

Bulk sample locations for suspect materials sampled by L&A, and the name and signature and asbestos hazard evaluation specialist number of each person who collected samples are shown on the Asbestos Bulk Sample Diagram found in **Appendix B**.

Samples were placed into clean sealed containers and identified with a unique sample number. Sampling tools were decontaminated between each sampling episode.

All samples were sent to certified National Voluntary Lab Accredited Program laboratories. The lab utilized for bulk sample Polarized Light Microscopy (PLM) analysis for this assessment was SanAir Technologies Laboratory, SATL (NVLAP #200870-0) located at 11709 Chesterdale Road, Cincinnati, Ohio 45246. Samples were analyzed by the EPA Polarized Light Microscopy (PLM) 600 Method. Samples reported with low concentrations of asbestos, <3% asbestos content, were reanalyzed using the EPA Point Count Method to determine a more accurate content.

3.0 Asbestos Containing Materials Results

The following tables present asbestos containing materials summaries and information. Detailed summaries, including locations and quantities of all asbestos containing materials project to be impacted may be found in **Appendix C**, Inventory of Asbestos Containing Materials. A bulk sample summary of suspect asbestos containing materials may be found in **Appendix D**. Asbestos laboratory analysis certificates and chain of custody information may be found in **Appendix E**.

3.1 Confirmed Asbestos Containing Materials

The following are lists of asbestos containing materials sampled and confirmed to contain asbestos in concentrations greater than 1%, the EPA definition of an asbestos containing material. **Appendix C** provides an inventory of material locations and quantities.

Confirmed Asbestos Containing Materials	
Residential Structure	
Black Sink Undercoating (1)	
Outbuilding	
Stored Cement Board (1)	

Notes: (1) Category II Non-Friable Asbestos Containing Material.

(2) See below Section 3.3 Materials Containing 1% or Less Asbestos.

3.2 Assumed Asbestos Containing Materials

As a result of the inspection, all suspect materials identified in each structure at each location were bulk sampled for asbestos content analysis; therefore, no materials are assumed to contain asbestos. Any encountered materials not listed in the tables below or above should be assumed to contain asbestos and remain undisturbed until further sampling determines otherwise.

3.3 Materials Containing 1% or Less Asbestos

On the following page is a list of materials sampled and confirmed to contain 1% or less asbestos by PLM Point Count analysis. These materials are not regulated by EPA; however, will still need properly removed in accordance with OSHA asbestos standards. EPA notification is not required for abatement of these materials.

Materials Containing 1% or Less Asbestos	
Residential Structure	
Drywall Joint Compound (addition)	Interior Window Glazing Compound

EPA regulations do not apply to these materials, however OSHA does regulate <1% asbestos materials. The following are the implications for the contractor:

1. Work practice requirements and prohibitions that must be observed REGARDLESS of the exposure levels and of the percentage of asbestos in the installed construction materials are:

- 29 CFR 1926.1101(g)(1)(ii), which requires: **wet methods, or wetting agents, to control employee exposures during asbestos handling, mixing, removal, cutting, application, and cleanup.**

The material should be thoroughly wet at all times during handling, mixing, removal, cutting, application, cleanup and up until it is containerized. This will minimize the potential for exposure through dry dust and fiber release.

- 29 CFR 1926.1101(g)(1)(iii), which requires: **prompt clean-up and disposal of wastes and debris contaminated with asbestos into leak-tight containers.**

The Contractor should provide a “leak-tight container.” The trailer is required to be equipped with a bladder bag or lined with polyethylene sheeting which should be taped to seal shut. “Prompt clean-up and disposal” means that asbestos material is to be cleaned up as it is removed and before it dries.

- 29 CFR 1926.1101(g)(3)(i), which prohibits: **high-speed abrasive disc saws that are not equipped with point-of-cut ventilator or enclosures with HEPA filtered exhaust air;** to reduce dry dust and fiber release exposure.
- 29 CFR 1926.1101(g)(3)(ii), which prohibits: **compressed air used to remove asbestos, or materials containing asbestos, unless the compressed air is used in conjunction with an enclosed ventilation system designed to capture the dust cloud created by the compressed air;** to reduce dry dust and fiber release exposure.
- 29 CFR 1926.1101(g)(3)(iv), which prohibits: **employee rotation as a means of reducing employee exposure to asbestos.**
- Contractor cannot manipulate work shifts as a means of artificially reducing the Permissible Exposure Limit (PEL).

At the start of demolition operations involving materials containing <1% asbestos, a contractor must produce an “Initial Negative Exposure Assessment” in accordance with 29 CFR 1926.1101 (f)(2)(iii)(A-C) to demonstrate that the airborne concentrations of asbestos will not exceed the (PELs).

In order to avoid the need to comply with the elements of the standard that are applicable when either asbestos PEL is exceeded, the contractor conducting the demolition project must produce an initial negative exposure assessment for his/her employees.

There are three potential approaches provided under 29 CFR 1926.1101(f)(2) for producing a negative exposure assessment. These are the use of **objective data, previous air monitoring results, or current air monitoring results.** If the contractor cannot produce a negative exposure assessment with objective data or previous air monitoring results, then the contractor must conduct asbestos exposure monitoring. Until the contractor is able to produce a negative exposure assessment for his/her employees, the contractor must comply with the elements of the standard that are applicable when either asbestos PEL is exceeded.

2. Disposal: The demolition waste, debris contaminated with less than 1 percent asbestos, in accordance with EPA regulations may go to a C&DD landfill. Each landfill has an internal policy on accepting this waste stream. The Demolition Contractor is responsible for confirming acceptance of this material by their chosen landfill and incorporating associated fees in their bid.

3.4 Non-Asbestos Containing Materials

The following are lists of materials sampled with laboratory analysis revealing No Asbestos Detected (NAD). Reference **Appendices D and E** for sample information and laboratory data. Any encountered materials not listed below or listed in the tables above should be assumed to contain asbestos until further sampling determines otherwise.

Non-Asbestos Containing Materials	
Residential Structure	
Ceiling Texture (1,000-5,000 square feet)	Joint Compound (original)

Non-Asbestos Containing Materials	
Drywall (original)	Stored Roll of White Linoleum
Floral Pattern Linoleum	Tan Tile Pattern Linoleum
Beige Linoleum	Stone Pattern Linoleum
Pink Linoleum	Sink Linoleum
Firebrick	Flue Pipe
Flue Packing	Fire Brick Backing Paper
Wall Adhesive	Door Frame Caulk
Interior Window Caulk	Exterior Deck Caulk
Exterior Window Caulk	Stored "Wonderboard"
Electrical Wiring Insulation	Electrical Backing Plate
Slate Shingles	Flashing Patching
Awning Shingle/Felt	Addition Shingle/Felt
Outbuilding	
Slate Shingles	

4.0 Conclusions

On August 15, 2024, L&A conducted an asbestos containing materials inspection of the structures located at 8895 Gaysport Hill Road, Blue Rock, Ohio 43720. The assessment was conducted by Mr. Matt Geiger (AHES #35832) and Mr. Austin Coldren (AHES #548697) of L&A.

The purpose of the inspection was to determine the presence of ACMs located at the structures prior to their proposed demolition. All structures located on the aforementioned parcel were included in this effort.

4.1 Asbestos Containing Materials

The following confirmed Asbestos Containing Materials are present at their respective addresses. These materials must be removed by a State of Ohio Licensed Asbestos Abatement Contractor prior to demolition work which will impact the material.

- Black Sink Undercoating (Category II Non-Friable) - Residential Dwelling
- Stored Transite Cement Board (Category II Non-Friable) – Outbuilding

4.2 Materials Containing 1% or Less Asbestos

EPA regulations do not apply to these materials; however, OSHA regulations still apply. These materials may remain in place during routine demolition practices. Refer to **Section 3.3 Materials Containing 1% or Less Asbestos** and the **Inventory of Asbestos Containing Materials** attached in **Appendix C** of this report for more specific requirements regarding impact to these materials:

- Addition Drywall Joint Compound – Residential Dwelling
- Interior Window Glazing Compound – Residential Dwelling

This report conforms to the requirements of the EPA NESHAPs prior to demolition for this project. This report should not be construed as a remediation design or used for bidding purposes. If you have any further questions, please contact Mr. Matt Geiger or Mr. Jordan Mederer at (614) 481-8600.

Sincerely,



Matt Geiger, AHES 35832
Project Manager



Jordan Mederer, AHES 35005
Practice Leader, HBM

APPENDIX A

Inspector's Certifications

The InService Training Network

Asbestos Building Inspector and Management Planner Refresher Courses



Matthew Geiger

has successfully completed the Asbestos Building Inspector and Management Planner Refresher Courses and passed by at least 70% the course examinations for accreditation under Section 206 of the Toxic Substance Control Act, Title II, and Indiana 326 IAC 18-2

Provided by: The InService Training Network, Inc., 705D Lakeview Plaza Blvd, Worthington, OH 43085 (614) 436-0980

Course Dates: February 21, 2024

Examination Date: February 21, 2024

Course Instructor:

Frank Rowe

Course Location: Worthington, Ohio

Expiration Date: February 21, 2025

Certificate Numbers: ITNIR7560 & ITNMPR7560



State of Ohio
Environmental Protection Agency
Asbestos Program

Asbestos Hazard Evaluation Specialist

**Matthew A
Geiger**



Lawhon & Associates, Inc.
1441 King Avenue
Columbus OH 43212



Certification Number Expiration Date

ES35832

10/14/24

DOB: 10/1/93

Card not Valid
if Altered

The InService Training Network

Asbestos Building Inspector and Management Planner Refresher Courses



Austin Coldren

has successfully completed the Asbestos Building Inspector and Management Planner Refresher Courses and passed by at least 70% the course examinations for accreditation under Section 206 of the Toxic Substance Control Act, Title II, and Indiana 326 IAC 18-2

Provided by: The InService Training Network, Inc., 705D Lakeview Plaza Blvd, Worthington, OH 43085 (614) 436-0980

Course Dates: April 17, 2024

Examination Date: April 17, 2024

Course Director: _____

Kurt Varga

Course Location: Worthington, Ohio

Expiration Date: April 17, 2025

Certificate Numbers: ITNIR7598 & ITNMPR7598

ITN

ITN



Mike DeWine, Governor
Jon Husted, Lt. Governor
Anne M. Vogel, Director

4/30/2024

Austin Coldren
Lawhon & Associates, Inc.
1441 King Avenue
Columbus, OH 43212

RE: Evaluation Specialist
Certification Number: ES548697
Expiration Date: 5/30/2025

Dear Austin Coldren:

This letter and enclosed certification card approves your request to be certified as an asbestos Evaluation Specialist. You must present your card upon request at any project site while performing duties. Copies of cards are not acceptable as proof of certification.

This certification may be revoked by the Director of the Ohio Environmental Protection Agency (EPA) for violation of any of the requirements of 3745-22 or 3745-20 of the Ohio Administrative Code.

If you have any questions, please contact the Asbestos Program at 614-644-0226 or by email at asbestoslicensing@epa.ohio.gov.

Sincerely,

Brandon M. Schwendeman

Brandon Schwendeman
Manager, Business Operations Support Section
Ohio EPA - Division of Air Pollution Control

State of Ohio
Environmental Protection Agency
Asbestos Program

Asbestos Hazard Evaluation Specialist

Austin Coldren

Lawhon & Associates, Inc.
1441 King Avenue
Columbus OH 43212



hio
Ohio Environmental Protection Agency

Certification Number **Expiration Date** **DOB: 2/21/98**

ES548697 **5/30/25** **Card not Valid if Altered**

P.O. Box 1049 • Columbus, OH 43216-1049
614-3020 • (614) 644-3184 (fax)

APPENDIX B

Asbestos Bulk Sample Location Diagram

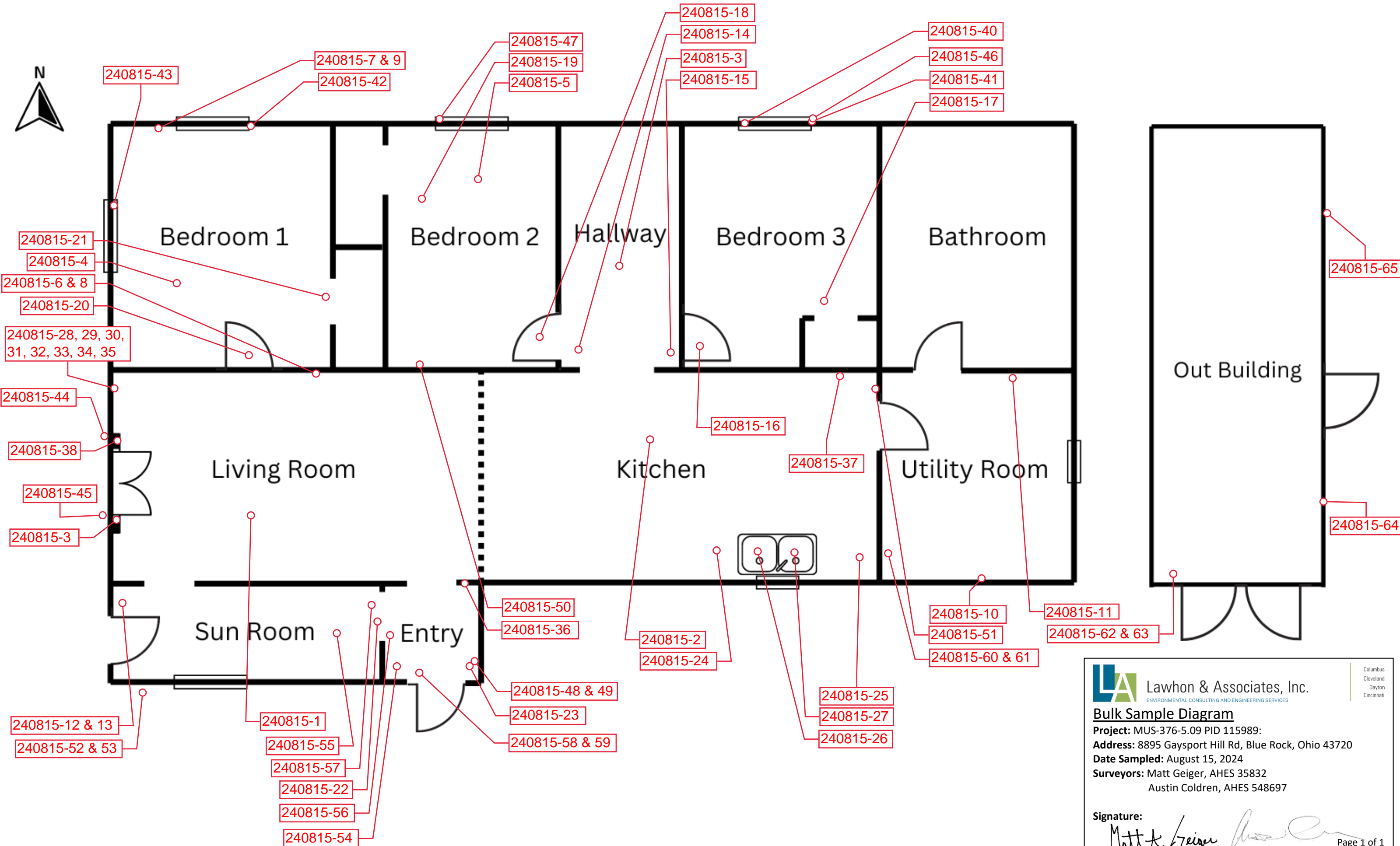

 **Lawhon & Associates, Inc.**
ENVIRONMENTAL CONSULTING AND ENGINEERING SERVICES
Columbus
Cleveland
Dayton
Cincinnati

Bulk Sample Diagram
Project: MUS-376-5.09 PID 115989:
Address: 8895 Gaysport Hill Rd, Blue Rock, Ohio 43720
Date Sampled: August 15, 2024
Surveyors: Matt Geiger, AHES 35832
Austin Coldren, AHES 548697

Signature: 
Page 1 of 1

1441 King Avenue | Columbus, Ohio 43212 | P: 614.481.8600 | F: 614.481.8610 | www.lawhon-assoc.com

APPENDIX C

Inventory of Asbestos Containing Materials

INVENTORY OF ASBESTOS CONTAINING MATERIALS
8895 Gaysport Hill Road – Structure Demolitions
Blue Rock, Ohio 43720

ACM	Locations	Approximate Quantity	Condition	EPA NESHAP Classification & Comments
Residential Structure				
Drywall/Joint Compound II	Utility Room and Bathroom	820 square feet	Intact	<1% Asbestos (1)
Black sink Undercoating	Kitchen	5 square feet (1 Double Sink)	Intact	Category II Non-Friable
Interior Window Glazing Compound	Throughout	20 square feet	Intact	<1% Asbestos (1)
Outbuilding				
Stored Transite Board	Outbuilding Southwest Corner	6 square feet	Intact	Category II Non-Friable

(1) Materials containing 1% or less asbestos are not regulated by EPA standards, however, OSHA standards still apply to these materials during removal activities; see report narrative **Section 3.3 Materials Containing 1% or Less Asbestos** for additional information.

APPENDIX D

Asbestos Bulk Sample Summary

ASBESTOS BULK SAMPLE SUMMARY
8895 Gaysport Road Demolition Project
Blue Rock, Ohio 43720

Sample Number	Homog. Area #	Material Sampled	Sample Location	Percent Asbestos
8895 Gaysport Road Residential Building				
240815-01	01	Ceiling Texture	Living Room	NAD
240815-02	01	Ceiling Texture	Kitchen	NAD
240815-03	01	Ceiling Texture	Hall	NAD
240815-04	01	Ceiling Texture	Bedroom 1	NAD
240815-05	01	Ceiling Texture	Bedroom 2	NAD
240815-06	02	Joint Compound I (original)	Living Room	NAD
240815-07	02	Joint Compound I (original)	Bedroom 1	NAD
240815-08	03	Drywall I (original)	Living Room	NAD
240815-09	03	Drywall I (original)	Bedroom 1	NAD
240815-10a	04a	Drywall II (addition)	Utility Room	NAD
240815-10b	04b	Joint Compound		NAD
240815-11a	<i>04a</i>	Drywall II (addition)	<i>Utility Room</i>	NAD
240815-11b	<i>04b</i>	<i>Joint Compound</i>		<i><1% Chrysotile</i>
240815-12	05	Stored White Linoleum Roll	Sunroom	NAD
240815-13	05	Stored White Linoleum Roll	Sunroom	NAD
240815-14	06	Floral Pattern Linoleum	Hall	NAD
240815-15	06	Floral Pattern Linoleum	Hall	NAD
240815-16a	07a	Tan Tile Pattern Linoleum	Bedroom 3	NAD
240815-16b	07b	Mastic		NAD
240815-17a	07a	Tan Tile Pattern Linoleum	Bedroom 3	NAD
240815-17b	07b	Mastic		NAD

Bold text denotes an Asbestos Containing Material; as defined by EPA and OSHA.

Italic Text denotes an Asbestos Containing Material; as defined by OSHA only.

Legend

Abbreviation: NAD
Definition: No Asbestos Detected

Abbreviation: PC
Definition: Point Count Method Performed

ASBESTOS BULK SAMPLE SUMMARY
8895 Gaysport Road Demolition Project
Blue Rock, Ohio 43720

Sample Number	Homog. Area #	Material Sampled	Sample Location	Percent Asbestos
240815-18	08	Beige Linoleum	Bedroom 2	NAD
240815-19	08	Beige Linoleum	Bedroom 2	NAD
240815-20	09	Stone Pattern Linoleum	Bedroom 1	NAD
240815-21	09	Stone Pattern Linoleum	Bedroom 1	NAD
240815-22	10	Pink Linoleum with Squares	Sunroom	NAD
240815-23	10	Pink Linoleum with Squares	Entry (closet)	NAD
240815-24a	11a	Kitchen Counter Linoleum	Kitchen	NAD
240815-24b	11b	Mastic		NAD
240815-25a	11a	Kitchen Counter Linoleum	Kitchen	NAD
240815-25b	11b	Mastic		NAD
240815-26	12	Black Sink Undercoating	Kitchen	1.1% Chrysotile (PC)
240815-27	12	Black Sink Undercoating	Kitchen	1.2% Chrysotile (PC)
240815-28	13	Firebrick	Living Room Fireplace	NAD
240815-29	13	Firebrick	Living Room Fireplace	NAD
240815-30a	14a	Flue Pipe	Living Room Fireplace	NAD
240815-30b	14b	Mortar		NAD
240815-31a	14a	Flue Pipe	Living Room Fireplace	NAD
240815-31b	14b	Mortar		NAD
240815-32	15	Flue Packing	Living Room Fireplace	NAD
240815-33	15	Flue Packing	Living Room Fireplace	NAD
240815-34	16	Fire Brick Backing Paper	Living Room Fireplace	NAD
240815-35	16	Fire Brick Backing Paper	Living Room Fireplace	NAD

Bold text denotes an Asbestos Containing Material; as defined by EPA and OSHA.

Italic Text denotes an Asbestos Containing Material; as defined by OSHA only.

Legend

Abbreviation: NAD
Definition: No Asbestos Detected

Abbreviation: PC
Definition: Point Count Method Performed

ASBESTOS BULK SAMPLE SUMMARY
8895 Gaysport Road Demolition Project
Blue Rock, Ohio 43720

Sample Number	Homog. Area #	Material Sampled	Sample Location	Percent Asbestos
240815-36	17	Wall Adhesive	Entry	NAD
240815-37	17	Wall Adhesive	Living Room	NAD
240815-38	18	Door Frame Caulk	Living Room	NAD
240815-39	18	Door Frame Caulk	Living Room	NAD
240815-40	19	<i>Interior Window Glazing Compound</i>	<i>Bedroom 3</i>	<i>0.3% Chrysotile (PC)</i>
240815-41	19	<i>Interior Window Glazing Compound</i>	<i>Bedroom 3</i>	<i>0.4% Chrysotile (PC)</i>
240815-42	20	Interior Window Caulk	Bedroom 1	NAD
240815-43	20	Interior Window Caulk	Bedroom 1	NAD
240815-44	21	Exterior Deck Caulk	Exterior	NAD
240815-45	21	Exterior Deck Caulk	Exterior	NAD
240815-46	22	Exterior Window Caulk	Bedroom 3	NAD
240815-47	22	Exterior Window Caulk	Bedroom 2	NAD
240815-48	23	Stored "Wonderboard"	Entry	NAD
240815-49	23	Stored "Wonderboard"	Entry	NAD
240815-50	24	Electrical Wiring Insulation	Bedroom 2	NAD
240815-51	24	Electrical Wiring Insulation	Kitchen	NAD
240815-52	25	Electrical Backing Plate	Exterior	NAD
240815-53	25	Electrical Backing Plate	Exterior	NAD
240815-54	26	Slate Shingles	Main Roof	NAD
240815-55	26	Slate Shingles	Main Roof	NAD
240815-56	27	Flashing Patch	Main Roof	NAD

Bold text denotes an Asbestos Containing Material; as defined by EPA and OSHA.

Italic Text denotes an Asbestos Containing Material; as defined by OSHA only.

Legend

Abbreviation: NAD
Definition: No Asbestos Detected

Abbreviation: PC
Definition: Point Count Method Performed

ASBESTOS BULK SAMPLE SUMMARY
8895 Gaysport Road Demolition Project
Blue Rock, Ohio 43720

Sample Number	Homog. Area #	Material Sampled	Sample Location	Percent Asbestos
240815-57	27	Flashing Patch	Main Roof	NAD
240815-58a	28a	Awning Shingle	Carport Roof	NAD
240815-58b	28b	Tar		NAD
240815-58c	28C	Felt		NAD
240815-59a	28a	Awning Shingle	Carport Roof	NAD
240815-59b	28b	Tar		NAD
240815-59c	28c	Felt		NAD
240815-60a	29a	Addition Shingle	Addition Roof	NAD
240815-60b	29b	Tar		NAD
240815-60c	29c	Felt		NAD
240815-61a	29a	Addition Shingle	Addition Roof	NAD
240815-61b	29b	Tar		NAD
240815-61c	29c	Felt		NAD
Outbuilding				
240815-62	30	Stored Cement Board	Out-Building	20% Chrysotile
240815-63	30	Stored Cement Board	Out-Building	20% Chrysotile
240815-64	31	Slate Shingle	Out-Building Roof	NAD
240815-65	31	Slate Shingle	Out-Building Roof	NAD

Bold text denotes an Asbestos Containing Material; as defined by EPA and OSHA.

Italic Text denotes an Asbestos Containing Material; as defined by OSHA only.

Legend

Abbreviation: NAD
Definition: No Asbestos Detected

Abbreviation: PC
Definition: Point Count Method Performed

APPENDIX E

Asbestos Laboratory Analysis Certificates

&

Chain of Custody



The Identification Specialists

Analysis Report
prepared for
Lawhon & Associates, Inc.

Report Date: 8/23/2024

Project Name: 8895 Gaysport Rd Demo

Project #: 24-0310

SanAir ID#: 24046307



NVLAP LAB CODE 600227-0

11709 Chesterdale Road | Cincinnati, Ohio 45246
888.895.1177 | 513.438.6006 | IAQ@SanAir.com | SanAir.com



SanAir ID Number

24046307

FINAL REPORT

8/23/2024 3:24:35 PM

Name: Lawhon & Associates, Inc.
Address: 1441 King Ave
Columbus, OH 43212
Phone: 614-481-8600 ext. 142

Project Number: 24-0310
P.O. Number:
Project Name: 8895 Gaysport Rd Demo
Collected Date: 8/15/2024
Received Date: 8/19/2024 9:15:00 AM

Dear Matt Geiger,

We at SanAir would like to thank you for the work you recently submitted. The 65 sample(s) were received on Monday, August 19, 2024 via UPS. The final report(s) is enclosed for the following sample(s): 240815-01, 240815-02, 240815-03, 240815-04, 240815-05, 240815-06, 240815-07, 240815-08, 240815-09, 240815-10, 240815-11, 240815-12, 240815-13, 240815-14, 240815-15, 240815-16, 240815-17, 240815-18, 240815-19, 240815-20, 240815-21, 240815-22, 240815-23, 240815-24, 240815-25, 240815-26, 240815-27, 240815-28, 240815-29, 240815-30, 240815-31, 240815-32, 240815-33, 240815-34, 240815-35, 240815-36, 240815-37, 240815-38, 240815-39, 240815-40, 240815-41, 240815-42, 240815-43, 240815-44, 240815-45, 240815-46, 240815-47, 240815-48, 240815-49, 240815-50, 240815-51, 240815-52, 240815-53, 240815-54, 240815-55, 240815-56, 240815-57, 240815-58, 240815-59, 240815-60, 240815-61, 240815-62, 240815-63, 240815-64, 240815-65, 240815-11.

These results only pertain to this job and should not be used in the interpretation of any other job. This report is only complete in its entirety. Refer to the listing below of the pages included in a complete final report.

Sincerely,

Maureen Y. Haley
Asbestos Laboratory Manager
SanAir Technologies Laboratory

Final Report Includes:

- Cover Letter
- Analysis Pages
- Disclaimers and Additional Information

Sample conditions:

- 66 samples in Good condition.



SanAir ID Number
24046307
 FINAL REPORT
 8/23/2024 3:24:35 PM

Name: Lawhon & Associates, Inc.
Address: 1441 King Ave
 Columbus, OH 43212
Phone: 614-481-8600 ext. 142

Project Number: 24-0310
P.O. Number:
Project Name: 8895 Gaysport Rd Demo
Collected Date: 8/15/2024
Received Date: 8/19/2024 9:15:00 AM

Analyst: Pinkerton, Sid | Haley, Maureen

Asbestos Bulk PLM EPA 600/R-93/116

SanAir ID / Description	Stereoscopic	Components		Asbestos Fibers
	Appearance	% Fibrous	% Non-fibrous	
240815-01 / 24046307-001 Ceiling Txt, Living Rm	White Non-Fibrous Homogeneous	< 1% Cellulose	100% Other	None Detected
240815-02 / 24046307-002 Ceiling Txt, Kitchen	White Non-Fibrous Homogeneous	< 1% Cellulose	100% Other	None Detected
240815-03 / 24046307-003 Ceiling Txt, Hall	White Non-Fibrous Homogeneous	< 1% Cellulose	100% Other	None Detected
240815-04 / 24046307-004 Ceiling Txt, Bedroom 1	White Non-Fibrous Homogeneous	< 1% Cellulose	100% Other	None Detected
240815-05 / 24046307-005 Ceiling Txt, Bedroom 2	White Non-Fibrous Homogeneous	< 1% Cellulose	100% Other	None Detected
240815-06 / 24046307-006 DWJC #1, Living Room	White Non-Fibrous Homogeneous		100% Other	None Detected
240815-07 / 24046307-007 DWJC #1, Bedroom 1	White Non-Fibrous Homogeneous		100% Other	None Detected
240815-08 / 24046307-008 Drywall #1, Living Room	White Non-Fibrous Homogeneous	5% Cellulose	95% Other	None Detected
240815-09 / 24046307-009 Drywall #1, BR 1	White Non-Fibrous Homogeneous	5% Cellulose	95% Other	None Detected
240815-10 / 24046307-010 DWJC #2, Utility Rm, Drywall	White Non-Fibrous Homogeneous	5% Cellulose	95% Other	None Detected

Analyst: *Sidney Pinkerton*

Approved Signatory: *Jonathan Wilson*

Analysis Date: 8/23/2024

Date: 8/23/2024



SanAir ID Number
24046307
 FINAL REPORT
 8/23/2024 3:24:35 PM

Name: Lawhon & Associates, Inc.
Address: 1441 King Ave
 Columbus, OH 43212
Phone: 614-481-8600 ext. 142

Project Number: 24-0310
P.O. Number:
Project Name: 8895 Gaysport Rd Demo
Collected Date: 8/15/2024
Received Date: 8/19/2024 9:15:00 AM

Analyst: Pinkerton, Sid | Haley, Maureen

Asbestos Bulk PLM EPA 600/R-93/116

SanAir ID / Description	Components			Asbestos Fibers
	Stereoscopic Appearance	% Fibrous	% Non-fibrous	
240815-10 / 24046307-010 DWJC #2, Utility Rm, Joint Compound	White Non-Fibrous Homogeneous		100% Other	None Detected
240815-11 / 24046307-011 DWJC #2, Utility Rm, Drywall	White Non-Fibrous Homogeneous	5% Cellulose	95% Other	None Detected
240815-11 / 24046307-011 DWJC #2, Utility Rm, Joint Compound	Various Non-Fibrous Heterogeneous		100% Other	< 1% Chrysotile
240815-12 / 24046307-012 Stored Linoleum, Entry	Tan Non-Fibrous Homogeneous	20% Cellulose	80% Other	None Detected
240815-13 / 24046307-013 Stored Linoleum, Entry	Tan Non-Fibrous Homogeneous	20% Cellulose	80% Other	None Detected
240815-14 / 24046307-014 Floral Pattern Linoleum, Hall	Pink Non-Fibrous Homogeneous	30% Cellulose	70% Other	None Detected
240815-15 / 24046307-015 Floral Pattern Linoleum, Hall	Pink Non-Fibrous Homogeneous	30% Cellulose	70% Other	None Detected
240815-16 / 24046307-016 Tile Pattern Linoleum, BR 3, Linoleum	Beige Non-Fibrous Homogeneous	20% Cellulose	80% Other	None Detected
240815-16 / 24046307-016 Tile Pattern Linoleum, BR 3, Mastic	Brown Non-Fibrous Homogeneous		100% Other	None Detected
240815-17 / 24046307-017 Tile Pattern Linoleum, BR 3, Linoleum	Beige Non-Fibrous Homogeneous	20% Cellulose	80% Other	None Detected

Analyst: *Sidney Pinkerton*

Approved Signatory: *Jonathan Wilson*

Analysis Date: 8/23/2024

Date: 8/23/2024



SanAir ID Number
24046307
 FINAL REPORT
 8/23/2024 3:24:35 PM

Name: Lawhon & Associates, Inc.
Address: 1441 King Ave
 Columbus, OH 43212
Phone: 614-481-8600 ext. 142

Project Number: 24-0310
P.O. Number:
Project Name: 8895 Gaysport Rd Demo
Collected Date: 8/15/2024
Received Date: 8/19/2024 9:15:00 AM

Analyst: Pinkerton, Sid | Haley, Maureen

Asbestos Bulk PLM EPA 600/R-93/116

SanAir ID / Description	Stereoscopic		Components		Asbestos Fibers
	Appearance	% Fibrous	% Non-fibrous		
240815-17 / 24046307-017 Tile Pattern Linoleum, BR 3, Mastic	Brown Non-Fibrous Homogeneous		100% Other		None Detected
240815-18 / 24046307-018 Linoleum, BR 2	Beige Non-Fibrous Homogeneous	30% Cellulose	70% Other		None Detected
240815-19 / 24046307-019 Linoleum, BR 2	Beige Non-Fibrous Homogeneous	30% Cellulose	70% Other		None Detected
240815-20 / 24046307-020 Stone Pattern Linoleum, BR 1	Grey Non-Fibrous Homogeneous	30% Cellulose	70% Other		None Detected
240815-21 / 24046307-021 Stone Pattern Linoleum, BR 1	Grey Non-Fibrous Homogeneous	30% Cellulose	70% Other		None Detected
240815-22 / 24046307-022 With Squares-Linoleum, Entry	Pink Non-Fibrous Homogeneous	30% Cellulose	70% Other		None Detected
240815-23 / 24046307-023 With Squares-Linoleum, Entry	Pink Non-Fibrous Homogeneous	30% Cellulose	70% Other		None Detected
240815-24 / 24046307-024 Sink Linoleum, Kitchen, Linoleum	Tan Non-Fibrous Homogeneous		100% Other		None Detected
240815-24 / 24046307-024 Sink Linoleum, Kitchen, Mastic	Brown Non-Fibrous Homogeneous		100% Other		None Detected
240815-25 / 24046307-025 Sink Linoleum, Kitchen, Linoleum	Tan Non-Fibrous Homogeneous		100% Other		None Detected

Analyst: *Sidney Pinkerton*

Approved Signatory: *Jonathan Wilson*

Analysis Date: 8/23/2024

Date: 8/23/2024



SanAir ID Number
24046307
 FINAL REPORT
 8/23/2024 3:24:35 PM

Name: Lawhon & Associates, Inc.
Address: 1441 King Ave
 Columbus, OH 43212
Phone: 614-481-8600 ext. 142

Project Number: 24-0310
P.O. Number:
Project Name: 8895 Gaysport Rd Demo
Collected Date: 8/15/2024
Received Date: 8/19/2024 9:15:00 AM

Analyst: Pinkerton, Sid | Haley, Maureen

Asbestos Bulk PLM EPA 600/R-93/116

SanAir ID / Description	Stereoscopic		Components		Asbestos Fibers
	Appearance	% Fibrous	% Non-fibrous		
240815-25 / 24046307-025 Sink Linoleum, Kitchen, Mastic	Brown Non-Fibrous Homogeneous		100% Other		None Detected
240815-26 / 24046307-026 BSU, Kitchen	Black Non-Fibrous Homogeneous		98% Other		2% Chrysotile
240815-27 / 24046307-027 BSU, Kitchen	Black Non-Fibrous Homogeneous		98% Other		2% Chrysotile
240815-28 / 24046307-028 Fire Brick, Living Room Fireplace	Tan Non-Fibrous Homogeneous		100% Other		None Detected
240815-29 / 24046307-029 Fire Brick, Living Room Fireplace	Tan Non-Fibrous Homogeneous		100% Other		None Detected
240815-30 / 24046307-030 Flue Pipe, Living Rm Fireplace, Flue Pipe	Red Non-Fibrous Homogeneous		100% Other		None Detected
240815-30 / 24046307-030 Flue Pipe, Living Rm Fireplace, Mortar	Tan Non-Fibrous Homogeneous		100% Other		None Detected
240815-31 / 24046307-031 Flue Pipe, Living Rm Fireplace, Flue Pipe	Red Non-Fibrous Homogeneous		100% Other		None Detected
240815-31 / 24046307-031 Flue Pipe, Living Rm Fireplace, Mortar	Tan Non-Fibrous Homogeneous		100% Other		None Detected
240815-32 / 24046307-032 Flue Packing, Living Rm Fireplace	White Fibrous Homogeneous	100% Glass			None Detected

Analyst: *Sidney Pinkerton*

Approved Signatory: *Jonathan Wilson*

Analysis Date: 8/23/2024

Date: 8/23/2024



SanAir ID Number
24046307
 FINAL REPORT
 8/23/2024 3:24:35 PM

Name: Lawhon & Associates, Inc.
Address: 1441 King Ave
 Columbus, OH 43212
Phone: 614-481-8600 ext. 142

Project Number: 24-0310
P.O. Number:
Project Name: 8895 Gaysport Rd Demo
Collected Date: 8/15/2024
Received Date: 8/19/2024 9:15:00 AM

Analyst: Pinkerton, Sid | Haley, Maureen

Asbestos Bulk PLM EPA 600/R-93/116

SanAir ID / Description	Stereoscopic		Components		Asbestos Fibers
	Appearance	% Fibrous	% Non-fibrous		
240815-33 / 24046307-033 Flue Packing, Living Rm Fireplace	White Fibrous Homogeneous	100% Glass			None Detected
240815-34 / 24046307-034 Fire Brick Backing Paper, Living Rm Fireplace	Black Non-Fibrous Homogeneous	5% Cellulose 5% Glass	90% Other		None Detected
240815-35 / 24046307-035 Fire Brick Backing Paper, Living Rm Fireplace	White Fibrous Homogeneous	100% Glass			None Detected
240815-36 / 24046307-036 Wall Adhesive, Living Room	Tan Non-Fibrous Homogeneous		100% Other		None Detected
240815-37 / 24046307-037 Wall Adhesive, Kitchen	Tan Non-Fibrous Homogeneous		100% Other		None Detected
240815-38 / 24046307-038 Door Frame Caulk, Living Room	White Non-Fibrous Homogeneous		100% Other		None Detected
240815-39 / 24046307-039 Door Frame Caulk, Living Room	White Non-Fibrous Homogeneous		100% Other		None Detected
240815-40 / 24046307-040 Int WGC, BR 3	Tan Non-Fibrous Homogeneous		98% Other		2% Chrysotile
240815-41 / 24046307-041 Int WGC, BR 3	Tan Non-Fibrous Homogeneous		98% Other		2% Chrysotile
240815-42 / 24046307-042 WC, BR 1-Int	White Non-Fibrous Homogeneous		100% Other		None Detected

Analyst: *Sidney Pinkerton*

Approved Signatory: *Jonathan Wilson*

Analysis Date: 8/23/2024

Date: 8/23/2024



SanAir ID Number
24046307
 FINAL REPORT
 8/23/2024 3:24:35 PM

Name: Lawhon & Associates, Inc.
Address: 1441 King Ave
 Columbus, OH 43212
Phone: 614-481-8600 ext. 142

Project Number: 24-0310
P.O. Number:
Project Name: 8895 Gaysport Rd Demo
Collected Date: 8/15/2024
Received Date: 8/19/2024 9:15:00 AM

Analyst: Pinkerton, Sid | Haley, Maureen

Asbestos Bulk PLM EPA 600/R-93/116

SanAir ID / Description	Stereoscopic		Components		Asbestos Fibers
	Appearance	% Fibrous	% Non-fibrous		
240815-43 / 24046307-043 WC, BR 1-Int	White Non-Fibrous Homogeneous		100% Other		None Detected
240815-44 / 24046307-044 Ext Deck Caulk, Ext	Grey Non-Fibrous Homogeneous		100% Other		None Detected
240815-45 / 24046307-045 Ext Deck Caulk, Ext	Grey Non-Fibrous Homogeneous		100% Other		None Detected
240815-46 / 24046307-046 Ext WC, BR 1	Cream Non-Fibrous Homogeneous	4% Wollastonite	96% Other		None Detected
240815-47 / 24046307-047 Ext WC, BR 1	Cream Non-Fibrous Homogeneous	4% Wollastonite	96% Other		None Detected
240815-48 / 24046307-048 Stored Wonder Board, Entry	Grey Non-Fibrous Homogeneous	5% Glass	95% Other		None Detected
240815-49 / 24046307-049 Stored Wonder Board, Entry	Grey Non-Fibrous Homogeneous	5% Glass	95% Other		None Detected
240815-50 / 24046307-050 Elec Wiring Insulation, Ext	Various Fibrous Heterogeneous	45% Glass 50% Cellulose	5% Other		None Detected
240815-51 / 24046307-051 Elec Wiring Insulation, Ext	Various Fibrous Heterogeneous	45% Glass 50% Cellulose	5% Other		None Detected
240815-52 / 24046307-052 Elec Backing Plate, Ext	Grey Fibrous Homogeneous	50% Cellulose	50% Other		None Detected

Analyst: *Sidney Pinkerton*

Approved Signatory: *Jonathan Wilson*

Analysis Date: 8/23/2024

Date: 8/23/2024



SanAir ID Number
24046307
 FINAL REPORT
 8/23/2024 3:24:35 PM

Name: Lawhon & Associates, Inc.
Address: 1441 King Ave
 Columbus, OH 43212
Phone: 614-481-8600 ext. 142

Project Number: 24-0310
P.O. Number:
Project Name: 8895 Gaysport Rd Demo
Collected Date: 8/15/2024
Received Date: 8/19/2024 9:15:00 AM

Analyst: Pinkerton, Sid | Haley, Maureen

Asbestos Bulk PLM EPA 600/R-93/116

SanAir ID / Description	Stereoscopic		Components		Asbestos Fibers
	Appearance	% Fibrous	% Non-fibrous		
240815-53 / 24046307-053 Elec Backing Plate, Ext	Grey Fibrous Homogeneous	50% Cellulose	50% Other		None Detected
240815-54 / 24046307-054 Slate Shingles, Main Roof	Grey Non-Fibrous Homogeneous		100% Other		None Detected
240815-55 / 24046307-055 Slate Shingles, Main Roof	Grey Non-Fibrous Homogeneous		100% Other		None Detected
240815-56 / 24046307-056 Flashing Patch, Main Roof	Black Non-Fibrous Homogeneous	20% Cellulose	80% Other		None Detected
240815-57 / 24046307-057 Flashing Patch, Main Roof	Black Non-Fibrous Homogeneous	20% Cellulose	80% Other		None Detected
240815-58 / 24046307-058 Awning Shingle/ Felt, Carport Roof, Shingle	Black Non-Fibrous Homogeneous	30% Glass	70% Other		None Detected
240815-58 / 24046307-058 Awning Shingle/ Felt, Carport Roof, Tar	Black Non-Fibrous Homogeneous		100% Other		None Detected
240815-58 / 24046307-058 Awning Shingle/ Felt, Carport Roof, Felt	Black Non-Fibrous Homogeneous	50% Cellulose	50% Other		None Detected
240815-59 / 24046307-059 Awning Shingle/ Felt, Carport Roof, Shingle	Black Non-Fibrous Homogeneous	30% Glass	70% Other		None Detected
240815-59 / 24046307-059 Awning Shingle/ Felt, Carport Roof, Tar	Black Non-Fibrous Homogeneous		100% Other		None Detected

Analyst: *Sidney Pinkerton*

Approved Signatory: *Jonathan Wilson*

Analysis Date: 8/23/2024

Date: 8/23/2024



SanAir ID Number
24046307
 FINAL REPORT
 8/23/2024 3:24:35 PM

Name: Lawhon & Associates, Inc.
Address: 1441 King Ave
 Columbus, OH 43212
Phone: 614-481-8600 ext. 142

Project Number: 24-0310
P.O. Number:
Project Name: 8895 Gaysport Rd Demo
Collected Date: 8/15/2024
Received Date: 8/19/2024 9:15:00 AM

Analyst: Pinkerton, Sid | Haley, Maureen

Asbestos Bulk PLM EPA 600/R-93/116

SanAir ID / Description	Stereoscopic	Components		Asbestos Fibers
	Appearance	% Fibrous	% Non-fibrous	
240815-59 / 24046307-059 Awning Shingle/ Felt, Carport Roof, Felt	Black Non-Fibrous Homogeneous	50% Cellulose	50% Other	None Detected
240815-60 / 24046307-060 Addition Shingle/ Felt, Addition Roof, Shingle	Black Non-Fibrous Homogeneous	20% Glass	80% Other	None Detected
240815-60 / 24046307-060 Addition Shingle/ Felt, Addition Roof, Tar	Black Non-Fibrous Homogeneous		100% Other	None Detected
240815-60 / 24046307-060 Addition Shingle/ Felt, Addition Roof, Felt	Black Non-Fibrous Homogeneous	50% Cellulose	50% Other	None Detected
240815-61 / 24046307-061 Addition Shingle/ Felt, Addition Roof, Shingle	Black Non-Fibrous Homogeneous	20% Glass	80% Other	None Detected
240815-61 / 24046307-061 Addition Shingle/ Felt, Addition Roof, Tar	Black Non-Fibrous Homogeneous		100% Other	None Detected
240815-61 / 24046307-061 Addition Shingle/ Felt, Addition Roof, Felt	Black Non-Fibrous Homogeneous	50% Cellulose	50% Other	None Detected
240815-62 / 24046307-062 Stored Cement Board, Out-Building	Grey Non-Fibrous Homogeneous		80% Other	20% Chrysotile
240815-63 / 24046307-063 Stored Cement Board, Out-Building	Grey Non-Fibrous Homogeneous		80% Other	20% Chrysotile
240815-64 / 24046307-064 Slate Shingle, Out-Building Roof	Grey Non-Fibrous Homogeneous		100% Other	None Detected

Analyst: *Sidney Pinkerton*

Approved Signatory: *Jonathan Wilson*

Analysis Date: 8/23/2024

Date: 8/23/2024



SanAir ID Number
24046307
FINAL REPORT
8/23/2024 3:24:35 PM

Name: Lawhon & Associates, Inc.
Address: 1441 King Ave
Columbus, OH 43212
Phone: 614-481-8600 ext. 142

Project Number: 24-0310
P.O. Number:
Project Name: 8895 Gaysport Rd Demo
Collected Date: 8/15/2024
Received Date: 8/19/2024 9:15:00 AM

Analyst: Pinkerton, Sid | Haley, Maureen

Asbestos Bulk PLM EPA 600/R-93/116

SanAir ID / Description	Stereoscopic	Components		Asbestos Fibers
	Appearance	% Fibrous	% Non-fibrous	
240815-65 / 24046307-065 Slate Shingle, Out-Building Roof	Grey Non-Fibrous Homogeneous		100% Other	None Detected

Analyst: *Sidney Pinkerton*

Approved Signatory: *Johnathan Wilson*

Analysis Date: 8/23/2024

Date: 8/23/2024



SanAir ID Number
24046307
 FINAL REPORT
 8/23/2024 3:24:35 PM

Name: Lawhon & Associates, Inc.
Address: 1441 King Ave
 Columbus, OH 43212
Phone: 614-481-8600 ext. 142

Project Number: 24-0310
P.O. Number:
Project Name: 8895 Gaysport Rd Demo
Collected Date: 8/15/2024
Received Date: 8/19/2024 9:15:00 AM

Analyst: Pinkerton, Sid | Haley, Maureen

Asbestos Bulk EPA PLM 400 Point Count

SanAir ID / Description	Stereoscopic	Components		Asbestos Fibers
	Appearance	% Fibrous	% Non-fibrous	
240815-11 / 24046307-066 DWJC #2, Utility Rm	Various Non-Fibrous Heterogeneous		99.5% Other	0.5% Chrysotile

Analyst: *Sidney Pinkerton*

Approved Signatory: *Johnathan Wilson*

Analysis Date: 8/23/2024

Date: 8/23/2024

Disclaimer and Additional Information

400 Point Count Method EPA 600/R-93/116

EPA – 40 CFR Appendix E to Subpart E of Part 763, Interim Method of the Determination of Asbestos in Bulk Insulation Samples

EPA 600/R-93/116: Method for the Determination of Asbestos in Bulk Building Materials

This report is the sole property of the client named on the SanAir Technologies Laboratory, Inc. (SanAir) chain-of-custody (COC). Results in the report are confidential information intended only for the use by the customer listed on the COC. Neither results nor reports will be discussed with or released to any third party without our client's written permission. The final report shall not be reproduced except in full without written approval of the laboratory to assure that parts of the report are not taken out of context. This report and any information contained within shall not be edited, altered, or modified in any way by any persons or agencies receiving, viewing, distributing, or otherwise possessing a copy of this final report. The laboratory reserves the right to perform amendments to any finalized report, of which shall supersede and make obsolete any previous editions. Such changes, modifications, additions, or deletions shall be effective immediately upon notice thereof, which may be given by means including, but not limited to, posting on the SanAir client portal website, electronic or conventional mail, or by any other means. The information provided in this report applies only to the samples submitted and is relevant only for the date, time, and location of sampling. The accuracy of the results is dependent upon the client's sampling procedure, additions, exclusions, method deviations and information provided to the laboratory by the client on the COC. When the client requires samples to be tested in a way that deviates from a specific method or condition, all reported results may be affected by the deviation. SanAir assumes no responsibility for the sampling procedure and will provide evaluation reports based solely on the sample(s) in the condition in which they are received at the laboratory and information provided by the client on the COC, such as: project number, project name, collection dates, P.O. number, special instructions, samples collected by, sample numbers, sample identifications, sample type, selected analysis type, flow rate, total volume or area, and start-stop times that may affect the validity of the results in this report. Samples were received in good condition unless otherwise noted. SanAir assumes no responsibility or liability for the manner in which the results are used or interpreted. Limit of detection for this method is 0.25%. This report does not constitute and shall not be used to claim product, process, system, or person certification, approval, or endorsement by NVLAP, NIST, NELAC, AIHA LAP, LLC or any other U.S. governmental agencies; all or some tests contained in this report may not be accredited by every local, state, and federal regulatory agency. Refer to the SanAir website at www.sanair.com for copies of current certificates and scopes of various accreditations, certifications, and licenses or contact the laboratory at iaq@sanair.com for inquiries regarding the status or scope of an accreditation or certification. Samples are held for a period of 60 days.

Asbestos Accreditations, Certifications, and Licenses:

National Voluntary Laboratory Accreditation Program (NVLAP) Lab Code 600227-0

State of Connecticut Department of Public Health Registration Number: PH-0817

State of Rhode Island Department of Health Certification Number: PLM00144, TEM00144

State of West Virginia Bureau for Public Health Asbestos Laboratory Number: LT000637

Texas Department of State Health Services License Number: 300510

Disclaimer and Additional Information

This report is the sole property of the client named on the SanAir Technologies Laboratory, Inc. (SanAir) chain-of-custody (COC). Results in the report are confidential information intended only for the use by the client named on the COC. Neither results nor reports will be discussed with or released to any third party without our client's written permission to maintain client confidentiality. The final report cannot be reproduced, except in full, without written authorization from SanAir to assure that parts of the report are not taken out of context. This report and any information contained within shall not be edited, altered, or modified in any way by any persons or agencies receiving, viewing, distributing, or otherwise possessing a copy of this final report. The laboratory reserves the right to perform amendments to any finalized report, of which shall supersede and make obsolete any previous editions. Such changes, modifications, additions, or deletions shall be effective immediately upon notice thereof, which may be given by means including, but not limited to, posting on the SanAir client portal website, electronic or conventional mail, or by any other means. The information provided in this report applies only to the samples submitted in the condition they were received at the laboratory and is relevant only for the date, time, and location of sampling. Samples were received in good condition unless otherwise noted on the report. The accuracy of the results is dependent upon the client's sampling procedure and information provided to the laboratory by the client on the COC, which includes the project name, project number, P.O. number, sample collection dates, special instructions, samples collected by, sample numbers, sample identifications/location, sample type, selected analysis type, and total area or volume that may affect the validity of the results. SanAir assumes no responsibility for the sampling procedure and will provide evaluation reports based solely on the sample and information provided by the client. SanAir assumes no responsibility or liability for the manner in which results are used or interpreted. This report does not constitute and shall not be used to claim product, process, system, or person certification, approval, or endorsement by NVLAP, NIST, NELAC, AIHA LAP, LLC or any other agency of the U.S. government; all or some tests contained in this report may not be accredited by every local, state, and federal regulatory agency. Refer to the SanAir website at www.sanair.com for copies of current certificates and scopes of various accreditations, certifications, and licenses or contact the laboratory at iaq@sanair.com for inquiries regarding the status or scope of an accreditation or certification.

Fibers smaller than 5-microns cannot be seen with this method due to scope limitations. Polarized- light microscopy is not consistently reliable in detecting asbestos in floor covering and similar non-friable organically bound materials. Quantitative transmission electron microscopy is currently the only method that can be used to determine if this material can be considered or treated as non-asbestos containing. Samples are held for a period of 60 days.

Asbestos Accreditations, Certifications, and Licenses

National Voluntary Laboratory Accreditation Program (NVLAP) Lab Code 600227-0

State of Connecticut Department of Public Health Registration Number: PH-0817

State of Rhode Island Department of Health, Certification Number: PLM00144, TEM00144

State of West Virginia Bureau for Public Health, Analytical Laboratory Number: LT000637

Texas Department of State Health Services License Number: 300510

1441 King Avenue
 Columbus, OH 43212
 Phone: (614) 481-8600
 Fax: (614) 481-8610

24046307

Sent To: San Antonio

No. 5439

VIA: UPS

Page 1 of 4

Date: 8-15-2024

Turn around: 5 day

ASBESTOS BULK SAMPLE CHAIN-OF-CUSTODY RECORD

Project Name: <u>8895 Gaysport rd Demo</u>	Project No.: <u>24-0310</u>	Project Contact: <u>Matt Geiger</u>	Sampler (print): <u>Austin Coldren</u>	Signature <u>[Signature]</u>
---	--------------------------------	--	---	---------------------------------

Sample I.D. No.	Homog. Area No.	Sample /Homogeneous Area Description	Sample Location	Remarks
<u>240815</u>				
<u>- 01</u>	<u>1</u>	<u>Ceiling Txt</u>	<u>Living Rm</u>	
<u>- 02</u>	<u>1</u>	<u> </u>	<u>Kitchen</u>	
<u>- 03</u>	<u>1</u>	<u> </u>	<u>Hall</u>	
<u>- 04</u>	<u>1</u>	<u> </u>	<u>Bedroom 1</u>	
<u>- 05</u>	<u>1</u>	<u> </u>	<u>Bedroom 2</u>	
<u>- 06</u>	<u>2</u>	<u>DWJC #1</u>	<u>Living Room</u>	<u>Composite w/ -08 if Positive</u>
<u>- 07</u>	<u>1</u>	<u> </u>	<u>Bedroom 1</u>	<u>Composite w/ -09 if Positive</u>
<u>- 08</u>	<u>3</u>	<u>Drywall #1</u>	<u>Living Rm</u>	
<u>- 09</u>	<u>1</u>	<u> </u>	<u>BR1</u>	
<u>- 10</u>	<u>4</u>	<u>DWJC #2</u>	<u>Utility Rm</u>	<u>Composite if Positive</u>
<u>- 11</u>	<u>1</u>	<u> </u>	<u> </u>	<u> </u>
<u>- 12</u>	<u>5</u>	<u>Stored White Linoleum</u>	<u>Entry</u>	
<u>- 13</u>	<u>1</u>	<u> </u>	<u> </u>	
<u>- 14</u>	<u>6</u>	<u>Floral Pattern Linoleum</u>	<u>Hall</u>	
<u>- 15</u>	<u>1</u>	<u> </u>	<u> </u>	
<u>- 16</u>	<u>7</u>	<u>Tan Tie Pattern Linoleum</u>	<u>BR3</u>	
<u>- 17</u>	<u>1</u>	<u> </u>	<u> </u>	
<u>- 18</u>	<u>8</u>	<u>Beige Linoleum</u>	<u>BR2</u>	

SAMPLE ANALYSIS BY EPA METHOD 600/R-93/116 UNLESS OTHERWISE NOTED.
 POINT COUNT FRIABLES AND NOB'S 3% OR LESS ASBESTOS. Stop 1st Positive Analyze All Samples

Relinquished by: (signature) <u>cc</u>	Date / Time <u>8-16 1600</u>	Received by: (signature) <u>[Signature]</u>	Date / Time <u>8/19/24 9:15 am</u>	Relinquished by: (signature)	Date / Time	Received by: (signature)	Date / Time
---	---------------------------------	--	---------------------------------------	------------------------------	-------------	--------------------------	-------------

1441 King Avenue
Columbus, OH 43212
Phone: (614) 481-8600
Fax: (614) 481-8610

24046307

Sent To: SanAir

No. 5440

VIA: UPS

Page 2 of 4

Date: 8-15-2024

Turn around:
5-day

ASBESTOS BULK SAMPLE CHAIN-OF-CUSTODY RECORD

Project Name: <u>8895 Gayport Rd Demo</u>	Project No.: <u>24-0310</u>	Project Contact: <u>Matt Geiger</u>	Sampler (print): <u>Austyn Coiden</u>	Signature: 
--	--------------------------------	--	--	---

Sample ID No.	Homog. Area No.	Sample / Homogeneous Area Description	Sample Location	Remarks
<u>240815</u>				
<u>19</u>	<u>8</u>	<u>Beige Linoleum</u>	<u>BR2</u>	<u>Residence</u>
<u>- 20</u>	<u>9</u>	<u>Stone Pattern Linoleum</u>	<u>BR1</u>	
<u>- 21</u>	<u>1</u>	<u>I</u>	<u>I</u>	
<u>- 22</u>	<u>10</u>	<u>Pink with Squares - Linoleum</u>	<u>Entry</u>	
<u>- 23</u>	<u>1</u>	<u>I</u>	<u>I</u>	
<u>- 24</u>	<u>11</u>	<u>Sink Linoleum</u>	<u>Kitchen</u>	
<u>- 25</u>	<u>1</u>	<u>I</u>	<u>I</u>	
<u>- 26</u>	<u>12</u>	<u>BSU</u>	<u>I</u>	
<u>- 27</u>	<u>1</u>	<u>I</u>	<u>I</u>	
<u>- 28</u>	<u>13</u>	<u>Fire Brick</u>	<u>Living Rm fireplace</u>	
<u>- 29</u>	<u>1</u>	<u>I</u>	<u>I</u>	
<u>- 30</u>	<u>14</u>	<u>Flue Pipe</u>	<u>2</u>	
<u>- 31</u>	<u>1</u>	<u>I</u>	<u>I</u>	
<u>- 32</u>	<u>15</u>	<u>Flue Packing</u>	<u>I</u>	
<u>- 33</u>	<u>1</u>	<u>I</u>	<u>I</u>	
<u>- 34</u>	<u>16</u>	<u>Fire Brick Backing Paper</u>	<u>I</u>	
<u>- 35</u>	<u>1</u>	<u>I</u>	<u>I</u>	
<u>- 36</u>	<u>17</u>	<u>Wall Adhesive</u>	<u>Living Room</u>	

SAMPLE ANALYSIS BY EPA METHOD 600/R-93/116 UNLESS OTHERWISE NOTED. POINT COUNT FRIABLES AND NOB'S 3% OR LESS ASBESTOS. Stop 1st Positive Analyze All Samples

Relinquished by: (signature) <u>AG</u>	Date / Time <u>8/16 1000</u>	Received by: (signature) <u>MB</u>	Date / Time <u>8/16/20 09:15 am</u>	Relinquished by: (signature)	Date / Time	Received by: (signature)	Date / Time
---	---------------------------------	---------------------------------------	--	------------------------------	-------------	--------------------------	-------------

1441 King Avenue
Columbus, OH 43212
Phone: (614) 481-8600
Fax: (614) 481-8610

24046307

Sent To: San Air

No. 5441

VIA: UPS

Page 3 of 4

Date: 8-15-2024

Turn around:
5 Day

ASBESTOS BULK SAMPLE CHAIN-OF-CUSTODY RECORD

Project Name: <u>8895 Gay Sport Rd Demo</u>	Project No.: <u>24-0510</u>	Project Contact: <u>Matt Berger</u>	Sampler (print): <u>Austin Coldren</u>	Signature: 
--	--------------------------------	--	---	---

Sample ID No.	Homog. Area No.	Sample / Homogeneous Area Description	Sample Location	Remarks
<u>240815</u>				
<u>-37</u>	<u>17</u>	<u>Wall ADHESIVE</u>	<u>Kitchen</u>	<u>Residence</u>
<u>-38</u>	<u>18</u>	<u>Door frame Caulk</u>	<u>Living Rm</u>	
<u>-39</u>	<u>1</u>	<u>↓</u>	<u>↓</u>	
<u>-40</u>	<u>19</u>	<u>Int. W/C</u>	<u>BR3</u>	
<u>-41</u>	<u>1</u>	<u>↓</u>	<u>↓</u>	
<u>-42</u>	<u>20</u>	<u>WC</u>	<u>BR1 - Int</u>	
<u>-43</u>	<u>1</u>	<u>↓</u>	<u>↓</u>	
<u>-44</u>	<u>21</u>	<u>Ext Deck Caulk</u>	<u>Ext.</u>	
<u>-45</u>	<u>2</u>	<u>↓</u>	<u>↓</u>	
<u>-46</u>	<u>22</u>	<u>Ext. WC</u>	<u>BR1</u>	
<u>-47</u>	<u>1</u>	<u>↓</u>	<u>↓</u>	
<u>-48</u>	<u>23</u>	<u>Stored Wonder Board</u>	<u>Entry</u>	
<u>-49</u>	<u>1</u>	<u>↓</u>	<u>↓</u>	
<u>-50</u>	<u>24</u>	<u>Elec. Wiring Insulation</u>	<u>Ext.</u>	
<u>-51</u>	<u>1</u>	<u>↓</u>	<u>↓</u>	
<u>-52</u>	<u>25</u>	<u>Elec. Backing Plate</u>	<u>↓</u>	
<u>-53</u>	<u>1</u>	<u>↓</u>	<u>↓</u>	

SAMPLE ANALYSIS BY EPA METHOD 600/R-93/116 UNLESS OTHERWISE NOTED. POINT COUNT FRIABLES AND NOB'S 3% OR LESS ASBESTOS. Stop 1st Positive Analyze All Samples

Relinquished by: (signature) <u>ae</u>	Date / Time <u>8/16/2024</u>	Received by: (signature) <u>RMB</u>	Date / Time <u>8/19/24 6:15 am</u>	Relinquished by: (signature)	Date / Time	Received by: (signature)	Date / Time
---	---------------------------------	--	---------------------------------------	------------------------------	-------------	--------------------------	-------------

1441 King Avenue
 Columbus, OH 43212
 Phone: (614) 481-8600
 Fax: (614) 481-8610

24096307

Sent To: San Antonio

No. 5442

VIA: UPS

Page 4 of 4

Date: 8-15-2024

Turn around:
5-day

ASBESTOS BULK SAMPLE CHAIN-OF-CUSTODY RECORD

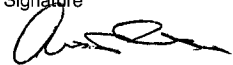
Project Name: <u>8895 Gay Sport Rd Demo</u>	Project No.: <u>24-0310</u>	Project Contact: <u>Matt Geiger</u>	Sampler (print): <u>Austin Calderon</u>	Signature 
--	--------------------------------	--	--	--

Sample I.D. No.	Homog. Area No.	Sample / Homogeneous Area Description	Sample Location	Remarks	
<u>240815</u>					
- 54	26	Slate Shingles	Main Roof	Residence	
- 55	↓	↓	↓		
- 56	27	Flashing Patch	Main Roof		
- 57	↓	↓	↓		
- 58	28	Awning Shingle/felt	Car Port Roof		
- 59	↓	↓	↓		
- 60	29	Addition Shingle/felt	Addition Roof		
- 61	↓	↓	↓		
- 62	30	Stored Cement Board	Out-Building		Out Building
- 63	↓	↓	↓		
- 64	31	Slate Shingle	Out-Building Roof		
- 65	↓	↓	↓		

SAMPLE ANALYSIS BY EPA METHOD 600/R-93/116 UNLESS OTHERWISE NOTED.
 POINT COUNT FRIABLES AND NOB'S 3% OR LESS ASBESTOS.

Stop 1st Positive Analyze All Samples

Relinquished by: (signature) <u>AL</u>	Date / Time <u>8/16/2024</u>	Received by: (signature) <u>LUB</u>	Date / Time <u>8/19/24 11:15 am</u>	Relinquished by: (signature)	Date / Time	Received by: (signature)	Date / Time
---	---------------------------------	--	--	------------------------------	-------------	--------------------------	-------------



The Identification Specialists

Analysis Report
prepared for
Lawhon & Associates, Inc.

Report Date: 8/28/2024

Project Name: 8895 Gaysport Rd Demo

Project #: 24-0310

SanAir ID#: 24048074



NVLAP LAB CODE 600227-0

11709 Chesterdale Road | Cincinnati, Ohio 45246
888.895.1177 | 513.438.6006 | IAQ@SanAir.com | SanAir.com



SanAir ID Number
24048074
FINAL REPORT
8/28/2024 3:02:27 PM

Name: Lawhon & Associates, Inc.
Address: 1441 King Ave
Columbus, OH 43212
Phone: 614-481-8600 ext. 142

Project Number: 24-0310
P.O. Number:
Project Name: 8895 Gaysport Rd Demo
Collected Date: 8/15/2024
Received Date: 8/26/2024 8:30:00 AM

Dear Matt Geiger,

We at SanAir would like to thank you for the work you recently submitted. The 4 sample(s) were received on Monday, August 26, 2024 via COC further analysis. The final report(s) is enclosed for the following sample(s): 240815-26, 240815-27, 240815-40, 240815-41.

These results only pertain to this job and should not be used in the interpretation of any other job. This report is only complete in its entirety. Refer to the listing below of the pages included in a complete final report.

Sincerely,

A handwritten signature in black ink that reads "Maureen Y. Haley". The signature is written in a cursive style.

Maureen Y. Haley
Asbestos Laboratory Manager
SanAir Technologies Laboratory

Final Report Includes:

- Cover Letter
- Analysis Pages
- Disclaimers and Additional Information

Sample conditions:

- 4 samples in Good condition.



SanAir ID Number
24048074
FINAL REPORT
8/28/2024 3:02:27 PM

Name: Lawhon & Associates, Inc.
Address: 1441 King Ave
Columbus, OH 43212
Phone: 614-481-8600 ext. 142

Project Number: 24-0310
P.O. Number:
Project Name: 8895 Gaysport Rd Demo
Collected Date: 8/15/2024
Received Date: 8/26/2024 8:30:00 AM

Analyst: Pinkerton, Sid

Asbestos Bulk EPA PLM NOB EPA 600/R-93/116

SanAir ID / Description	Appearance	% Fibrous	% Non Fibrous	Asbestos Types	% Total Asbestos
24048074-001 / 240815-26 BSU, Kitchen	Black Non-Fibrous Homogeneous		98.9 %	Chrysotile	1.1 %
24048074-002 / 240815-27 BSU, Kitchen	Black Non-Fibrous Homogeneous		98.8 %	Chrysotile	1.2 %
24048074-003 / 240815-40 Int WGC, BR 3	Tan Non-Fibrous Homogeneous		99.7 %	Chrysotile	0.3 %
24048074-004 / 240815-41 Int WGC, BR 3	Tan Non-Fibrous Homogeneous		99.6 %	Chrysotile	0.4 %

EPA 400 Point Count with Gravimetric Reduction.

Analyst: *Sidney Pinkerton*

Approved Signatory: *[Signature]*

Analysis Date: 8/28/2024

Date: 8/28/2024

Disclaimer and Additional Information:
Method for the Determination of Asbestos in Bulk Building Materials
EPA 600/R-93/116 July 1993 PLM EPA NOB

This report is the sole property of the client named on the SanAir Technologies Laboratory, Inc. (SanAir) chain-of-custody (COC). Results in the report are confidential information intended only for the use by the client named on the COC. Neither results nor reports will be discussed with or released to any third party without our client's written permission to maintain client confidentiality. The final report cannot be reproduced, except in full, without written authorization from SanAir to assure that parts of the report are not taken out of context. This report and any information contained within shall not be edited, altered, or modified in any way by any persons or agencies receiving, viewing, distributing, or otherwise possessing a copy of this final report. The laboratory reserves the right to perform amendments to any finalized report, of which shall supersede and make obsolete any previous editions. Such changes, modifications, additions, or deletions shall be effective immediately upon notice thereof, which may be given by means including, but not limited to, posting on the SanAir client portal website, electronic or conventional mail, or by any other means. When the client requires samples to be tested that deviates from a specific method or condition, all reported results may be affected by the deviation. Where noted on the COC, 400 point count with gravimetric reduction was employed with this analysis. The information provided in this report applies only to the samples submitted, in the condition they were received at the laboratory, and is relevant only for the date, time, and location of sampling. Samples were received in good condition unless otherwise noted on the report. The accuracy of the results is dependent upon the client's sampling procedure and information provided to the laboratory by the client on the COC, which includes the project name, project number, P.O. number, sample collection dates, special instructions, samples collected by, sample numbers, sample identifications/location, sample type, selected analysis type, and total area or volume that may affect the validity of the results. SanAir assumes no responsibility for the sampling procedure and will provide evaluation reports based solely on the sample and information provided by the client. SanAir assumes no responsibility or liability for the manner in which results are used or interpreted. This report does not constitute and shall not be used to claim product, process, system, or person certification, approval, or endorsement by NVLAP, NIST, NELAC, AIHA LAP, LLC or any other agency of the U.S. government; all or some tests contained in this report may not be accredited by every local, state, and federal regulatory agency. Refer to the SanAir website at www.sanair.com for copies of current certificates and scopes of various accreditations, certifications, and licenses or contact the laboratory at iaq@sanair.com for inquiries regarding the status or scope of an accreditation or certification.

Fibers smaller than 5 microns cannot be seen with this method due to scope limitations. Samples are held for a period of 60 days.

1441 King Avenue
 Columbus, OH 43212
 Phone: (614) 481-8600
 Fax: (614) 481-8610

Sent To: San Ar
 VIA: UPS
 Date: 8-15-2024
 Page 1 of 4

24048074
24046307
 No. 5439

Turn around:
5 days

ASBESTOS BULK SAMPLE CHAIN-OF-CUSTODY RECORD

Project Name: <u>8895 Bayport rd Demo</u>		Project No.: <u>24-0310</u>		Project Contact: <u>Matt Geiger</u>		Sampler (print): <u>Austin Colburn</u>		Signature: <u>Russen</u>	
Sample ID No.	Homog. Area No.	Sample Homogeneous Area Description	Sample Location		Remarks				
<u>240815</u>									
<u>-01</u>	<u>1</u>	<u>Ceiling Txt</u>	<u>Living Rm</u>						
<u>-02</u>	<u>1</u>		<u>Kitchen</u>						
<u>-03</u>	<u>1</u>		<u>Hall</u>						
<u>-04</u>	<u>1</u>		<u>Bedroom 1</u>						
<u>-05</u>	<u>1</u>		<u>Bedroom 2</u>						
<u>-06</u>	<u>2</u>	<u>DWJG #1</u>	<u>Living Room</u>		<u>Composite w/ -08 if Positive</u>				
<u>-07</u>	<u>1</u>		<u>Bedroom 1</u>		<u>Composite w/ -09 if Positive</u>				
<u>-08</u>	<u>3</u>	<u>Drywall #1</u>	<u>Living Rm</u>						
<u>-09</u>	<u>1</u>		<u>BEV</u>						
<u>-10</u>	<u>4</u>	<u>DWJG #2</u>	<u>Utility Rm</u>		<u>Composite if Positive</u>				
<u>-11</u>	<u>1</u>		<u>Entry</u>						
<u>-12</u>	<u>5</u>	<u>Shed white linoleum</u>	<u>Entry</u>						
<u>-13</u>	<u>1</u>		<u>Hall</u>						
<u>-14</u>	<u>6</u>	<u>Floor/Pattern Linoleum</u>	<u>Hall</u>						
<u>-15</u>	<u>1</u>		<u>BEV</u>						
<u>-16</u>	<u>7</u>	<u>Tan Tile Pattern Linoleum</u>	<u>BEV</u>						
<u>-17</u>	<u>1</u>		<u>BEV</u>						
<u>-18</u>	<u>8</u>	<u>Beige Linoleum</u>	<u>BEV</u>						

SAMPLE ANALYSIS BY EPA METHOD 600/R-93/16 UNLESS OTHERWISE NOTED.
 POINT COUNT FRIABLES AND NCB'S 3% OR LESS ASBESTOS.

Relinquished by: (signature)	Date / Time	Received by: (signature)	Date / Time	Relinquished by: (signature)	Date / Time	Received by: (signature)	Date / Time
<u>cc</u>	<u>8-16 10:00</u>	<u>DWA</u>	<u>8/19/24 8:00am</u>				

Stop 1st Positive Analyze All Samples

1441 King Avenue
 Columbus, OH 43212
 Phone: (614) 481-8600
 Fax: (614) 481-8610

Sent To: SenAir

VIA: VPS

Date: 8-15-2024

24048074
 24046307

No. 5440

Page 2 of 4

Time around: 5-dog

ASBESTOS BULK SAMPLE CHAIN-OF-CUSTODY RECORD

Project Name: <u>8895 Gayseport Rd Dams</u>		Project No.: <u>24-0310</u>		Project Contact: <u>Walt Geiger</u>		Sampler (print): <u>Austin Golden</u>		Signature: <u>[Signature]</u>	
Sample ID: No. <u>240815</u>	Homog. Area No. <u>19</u>	Sample / Homogeneous Area Description		Sample Location		Remarks			
- 20	9	Benz Linoleum Stone Pattern Linoleum		BRN BR1		Residence			
- 21	1	Stone Pattern Linoleum		Entry					
- 22	10	Pink with Squares - Linoleum		Entry					
- 23	1	Pink with Squares - Linoleum		Kitchen					
- 24	11	Sink Linoleum		Kitchen					
- 25	1	Sink Linoleum		Kitchen					
- 26	12	BSU		Living Room					
- 27	1	BSU		Living Room					
- 28	15	FreeBack		Living Room Fireplace					
- 29	1	FreeBack		Living Room Fireplace					
- 30	14	Five Pipe		Living Room					
- 31	1	Five Pipe		Living Room					
- 32	15	Five Packing		Living Room					
- 33	1	Five Packing		Living Room					
- 34	16	FreeBack Packing Paper		Living Room					
- 35	1	FreeBack Packing Paper		Living Room					
- 36	17	Wall Adhesive		Living Room					

SAMPLE ANALYSIS BY EPA METHOD 600/R-93/16 UNLESS OTHERWISE NOTED.
 POINT COUNT FRIABLES AND NOBS 3% OR LESS ASBESTOS.

Stop 1st Positive Analyze All Samples

Relinquished by: (signature) <u>[Signature]</u>	Date / Time <u>8/16</u>	Received by: (signature) <u>[Signature]</u>	Date / Time <u>8/16</u>	Relinquished by: (signature) <u>[Signature]</u>	Date / Time <u>8/16</u>	Received by: (signature) <u>[Signature]</u>	Date / Time <u>8/16</u>
---	-------------------------	---	-------------------------	---	-------------------------	---	-------------------------

1441 King Avenue
 Columbus, OH 43212
 Phone: (614) 481-8600
 Fax: (614) 481-8610

Sent To: Sam Ar

VIA: UPS

Date: 8-15-2024

No. 5441

Page 3 of 4

Turn around: 5 days

24048074

21046307

ASBESTOS BULK SAMPLE CHAIN-OF-CUSTODY RECORD

Project Name:	Project No.:	Project Contact:	Sampler (print):	Signature
8895 Gay Spout Rd Dura	24-0510	Matt Loeger	Austin Golden	<i>[Signature]</i>
Sample ID No.	Homog. Area No.	Sample / Homogeneous Area Description	Sample Location	Remarks
240815	17	Wall ADHESIVE	Kitchen	Residence
-37	18	Door Frame Caulk	Living Room	
-38	19	INT WGC	BR3	
-39	20	WC	BR1 - Int	
-40	21	Ext Deck Caulk	Ext	
-41	22	Ext. WC	BR1	
-42	23	Stored WonderBoard	Entry	
-43	24	Elec. Wiring Insulation	Ext.	
-44	25	Elec. Backing Plate		
-45	26			
-46	27			
-47	28			
-48	29			
-49	30			
-50	31			
-51	32			
-52	33			
-53	34			

SAMPLE ANALYSIS BY EPA METHOD 600/R-93/116 UNLESS OTHERWISE NOTED. Stop 1st Positive Analyze All Samples

Relinquished by: (signature) Date / Time Received by: (signature) Date / Time Relinquished by: (signature) Date / Time Received by: (signature) Date / Time

Relinquished by: (signature) Date / Time Received by: (signature) Date / Time

1441 King Avenue
 Columbus, OH 43212
 Phone: (614) 481-8600
 Fax: (614) 481-8610

Sent To: Senex

VIA: VBS

Date: 8-15-2024

No. 5442

Page 4 of 4

Turn around: 5-dcn

2410418074
 24096307

ASBESTOS BULK SAMPLE CHAIN-OF-CUSTODY RECORD

Project Name:	Project No.:	Project Contact:	Sampler (print):	Signature
8895 Garys Road Rd Demco	24-0310	Matt Grogan	Austin Golden	<i>Austin Golden</i>
Sample ID No.	Homog. Area No.	Sample / Homogeneous Area Description	Sample Location	Remarks
240815	26	Slake Samples	Main Roof	Residence
- 54	1	Slake Samples	Main Roof	
- 55	1	Flashing Patch	Main Roof	
- 56	27	Flashing Patch	Main Roof	
- 57	1	Flashing Patch	Main Roof	
- 58	28	Asbestos Sample/Felt	Gar-Pot Roof	
- 59	1	Asbestos Sample/Felt	Gar-Pot Roof	
- 60	29	Asbestos Sample/Felt	Asbestos Roof	
- 61	1	Asbestos Sample/Felt	Asbestos Roof	
- 62	30	Shored Cement Board	Out-Building	Out Building
- 63	1	Shored Cement Board	Out-Building	
- 64	31	Slake Sample	Out-Building Roof	
- 65	1	Slake Sample	Out-Building Roof	

SAMPLE ANALYSIS BY EPA METHOD 800/R-93/116 UNLESS OTHERWISE NOTED. Stop 1st Positive Analyze All Samples

Relinquished by: (signature) CE Date / Time 8/16/2024 Received by: (signature) DMB Date / Time 8/16/24 11:30am Relinquished by: (signature) Date / Time Received by: (signature) Date / Time



Notification of Demolition and Renovation/Abatement

Section 1: General Information

Division of Air Pollution Control

Work on projects cannot begin until 10 working days after a COMPLETE original notification form, **including payment**, is submitted to Ohio EPA. Instructions and a worksheet for fee calculation are available at epa.ohio.gov/asbestos. This form can be completed, and payment made, at ebiz.epa.ohio.gov. Questions? asbestos@epa.ohio.gov or (614) 466-0061.

<i>Ohio EPA Use Only</i>	Notification #:	Postmarked: / /	Received: / /	<input type="checkbox"/> Hand-Delivered
--------------------------	-----------------	-----------------	---------------	---

1) Notification Information (Check all that apply)

<input checked="" type="checkbox"/> Original	<input type="checkbox"/> Revision # (count):	<input type="checkbox"/> Installation	<input type="checkbox"/> Emergency	<input type="checkbox"/> Annual	<input type="checkbox"/> Cancellation	County: Muskingum
--	--	---------------------------------------	------------------------------------	---------------------------------	---------------------------------------	-------------------

2) Owner, Asbestos Abatement Contractor, Billing and Fire Department Information Revised?

Owner					
Name: ODOT District 5					Is this a company? <input checked="" type="checkbox"/> Yes <input type="checkbox"/> No
Address: 9600 Jacksontown Road			Contact Person: Brian Tatman (DEC)		
City: Jacksontown		State: Ohio		Zip: 43030	
Email: Brian.Tatman@dot.ohio.gov		Phone: (740) 323-4400		Fax:	
Asbestos Abatement Contractor (if applicable)					
Name:		License #: AC		Expiration Date: / /	
Address:			Contact Person:		
City:		State:		Zip: -	
Email:		Phone: () -		Fax: () -	
Billing Contact					
Is this contact associated with the <input type="checkbox"/> Owner, <input type="checkbox"/> Asbestos Abatement Contractor, or <input type="checkbox"/> Demolition Contractor (if not installation)?					
Address:			Contact Person:		
City:		State:		Zip: -	
Email:		Phone: () -		Fax: () -	
Fire Department (if applicable)					
Name:					
Address:			Contact Person:		
City:		State:		Zip: -	
Email:		Phone: () -		Fax: () -	

3) Ohio Asbestos Hazard Evaluation Specialist and Evaluation Procedure Revised?

Evaluation Specialist: Matt Geiger		Certification #: ES 35832	Expiration Date: 10/14/2024
Procedure, including analytical methods, employed to detect the presence of and to estimate the quantity of regulated asbestos-containing material (RACM) and Category I and Category II non-friable asbestos-containing material: <input checked="" type="checkbox"/> PLM <input type="checkbox"/> Point Count <input type="checkbox"/> TEM <input type="checkbox"/> Other Method (Explain Below):			

4) Procedures to be followed should unexpected RACM be discovered (check all that apply) Revised?

<input checked="" type="checkbox"/> Stop work and keep wet	<input checked="" type="checkbox"/> Evacuate area	<input checked="" type="checkbox"/> Demarcate area	<input checked="" type="checkbox"/> Contact licensed abatement contractor
<input checked="" type="checkbox"/> Contact district office/local air authority			
<input type="checkbox"/> Other (Explain):			

5) Planned Demolition (check all that apply) Revised?

Describe demolition work to be performed and method(s) to be employed, including demolition techniques to be used: <input type="checkbox"/> Implosion <input type="checkbox"/> Fire Training <input type="checkbox"/> Wet Methods <input type="checkbox"/> Manual Demolition <input type="checkbox"/> Mechanical Demolition <input type="checkbox"/> Other (Explain):
Description of affected facility components (include attachment if necessary):

Notification of Demolition and Renovation/Abatement

Section 1: General Information

Continued

Mail completed form and payment to:
Ohio EPA, DAPC – Asbestos
50 W. Town St., 7th Floor or P.O. Box 1049
Columbus, OH 43216-1049

6) Asbestos Description and Engineering Controls (if asbestos is being abated)

Revised?

For the material listed in each project, describe the type(s) of ACM to be abated, engineering controls and work practices to be used to minimize emissions and ensure proper waste handling:

Type of ACM to be abated:	<input type="checkbox"/> Surfacing	<input type="checkbox"/> Mechanical	<input type="checkbox"/> Other		
Engineering Controls:	<input type="checkbox"/> Wet Methods	<input type="checkbox"/> Glove Bag	<input type="checkbox"/> NPE	<input type="checkbox"/> AFD	<input type="checkbox"/> Other:
Work Practices:	<input type="checkbox"/> Intact Removal	<input type="checkbox"/> Manual	<input type="checkbox"/> Mechanical	<input type="checkbox"/> Other:	

7) Asbestos Waste Transporter (if applicable)

Revised?

Transporter #1 Name:					
Address:			Contact Person:		
City:	State:		Zip:	-	
Email:	Phone: () -		Fax: () -		
Transporter #2 Name (if applicable):					
Address:			Contact Person:		
City:	State:		Zip:	-	
Email:	Phone: () -		Fax: () -		

8) Asbestos Waste Disposal Site (if applicable)

Revised?

Name:					
Address:			Contact Person:		
City:	State:		Zip:	-	
Email:	Phone: () -		Fax: () -		

9) Emergency Demolition (complete if you checked "Emergency" above and "Demolition" for any project)

Revised?

A copy of the issued order, including the following information, must be attached to this notification.					
Government Official Issuing Order:			Title:		
Agency:			Authority of Order (Citation of Code):		
Date of Order: / /			Demolition Date: / /		

10) Emergency Renovation/Abatement (complete if you checked "Emergency" above and "Renovation/Abatement" for any project)

Revised?

Date of Emergency: / /		Time of Emergency: : <input type="checkbox"/> a.m. <input type="checkbox"/> p.m.			
Description of Sudden, Unexpected Event:					
Explanation of how the event caused unsafe conditions or equipment damage:					

11) Attestation

Revised?

In accordance with Ohio Administrative Code rule 3745-20-03(A)(4)(p), I certify that at least one person trained as required by paragraph (B) of rule 3745-20-04 of the Administrative Code will supervise the stripping and removal described by this notification. I acknowledge that the submission of false or misleading statements is prohibited by law and I certify that facts contained in this notification are true, accurate, and complete.

Signature:			Date: / /		
Name:			Title:		
Organization:					



Notification of Demolition and Renovation/Abatement

Section 2: Project Address Specific Information

Division of Air Pollution Control

Please complete Section 2 for the address included with this notification. If the project is an "Installation" per OAC 3745-20, complete a separate Section 2 page for each address associated with this notification.

Ohio EPA Use Only	Project ID #: _____
-------------------	---------------------

A. Facility Description Revised?

Building Name (if applicable): Residential Structure & Garage		Site Location (specific): 39°48'10.0"N 81°53'25.7"W	
Address: 8895 Gaysport Hill Road		County: Muskingum	
City: Blue Rock	State: OH	Zip: 43720 -	
Building Size (square feet): 1,296	No. of Floors: 1	Age: 34	
Present Use: Residential Dwelling and Garage (abandoned)		Prior Use: Residential Dwelling and Garage	

B. Type of Operation (check all that apply) Revised?

<input checked="" type="checkbox"/> Demolition	<input type="checkbox"/> Renovation/Abatement – Type: <input checked="" type="checkbox"/> Removal <input type="checkbox"/> Repair <input type="checkbox"/> Encapsulation <input type="checkbox"/> Enclosure
--	---

C. Asbestos Present (check one) Revised?

<input checked="" type="checkbox"/> Yes	<input type="checkbox"/> No	<input type="checkbox"/> No, previously abated	Year Abated: _____
---	-----------------------------	--	--------------------

D. Approximate Amount of Asbestos-Containing Materials (complete table below and Section 1 #6 if asbestos is present) Revised?

	Material to be Removed				Material NOT to be Removed	
	RACM	Non-friable Asbestos-Containing Material		Non-friable Asbestos-Containing Material		
		Category I	Category II	Category I	Category II	
Pipes (linear feet)						
Surface area on other facility components (ft ²)			11			
Volume if length or area cannot be measured (ft ³)						

E. Asbestos Abatement Schedule and Abatement Specialist (original notification is required 10 working days prior to the start of work) Revised?

Setup Date: / /			Abatement Date: / /			Complete Date: / /	
(Shift 1) Time start/end on site	Monday	Tuesday	Wednesday	Thursday	Friday	Saturday	Sunday
Abatement Specialist Name:			Certification #: AS			Expiration Date: / /	
(Shift 1) Time start/end on site	Monday	Tuesday	Wednesday	Thursday	Friday	Saturday	Sunday
Abatement Specialist Name:			Certification #: AS			Expiration Date: / /	

F. Demolition Contractor (if applicable) Revised?

Name:		
Address:		Contact Person:
City:	State:	Zip: -
Email:	Phone: () -	Fax: () -

G. Demolition Schedule (original notification is required 10 working days prior to the start of work) Revised?

Start Date: / /	Complete Date: / /
-----------------	--------------------

H. Project Hold Revised?

Hold Begin Date: / /	Work Resume Date: / /
----------------------	-----------------------